

Installation Instructions (1/2" - 2")

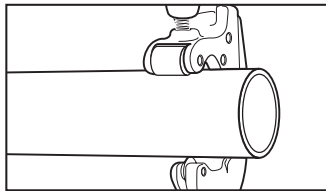

- 1.** Cut tube square using a tube cutter or fine tooth saw.

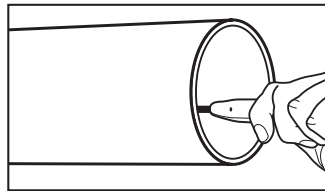

- 2.** Deburr tube ID using a deburring tool.

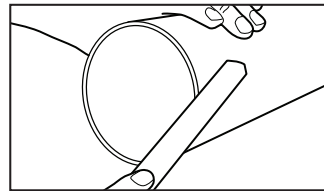

- 3.** Deburr tube OD using half round file.

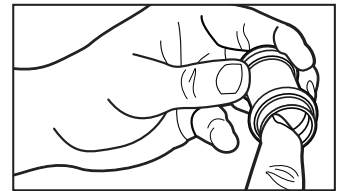

- 4.** Check fitting bead to ensure seal is present. Do not use any type of oil lubrication.

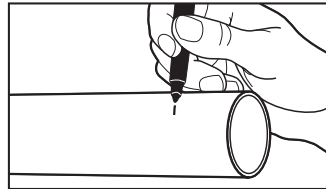

- 5.** Mark tube to proper fitting insertion depth (see Insertion Depth Chart below).

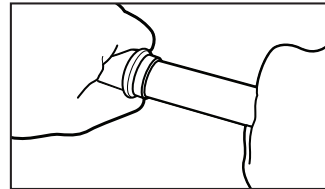

- 6.** Turn slightly while sliding press fitting onto tube. Slide all the way to insertion mark and make contact with stop.

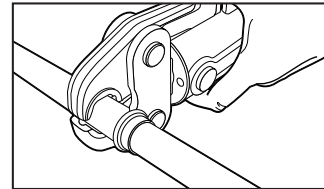

- 7.** Place press tool at a right angle over fitting bead. Start the pressing process. Please see specific tool manufacturer for tool instruction.

Streamline PRS Fitting Insertion Depth Chart (1/2" - 2")

Tube Size	1/2"	3/4"	1"	1-1/4"	1-1/2"	2"
Insertion Depth	3/4"	7/8"	7/8"	1"	1-7/16"	1-9/16"

Streamline PRS fittings must be connected with approved press tool.
Please see specific tool manufacturer for tool instruction.

Installation Instructions (2-1/2" - 4")

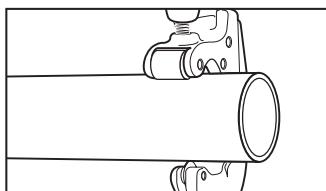

- 1.** Cut tube square using a tube cutter or fine tooth saw.

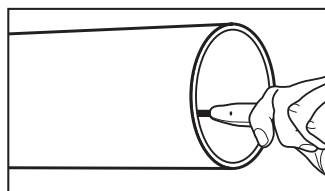

- 2.** Deburr tube ID using a deburring tool.

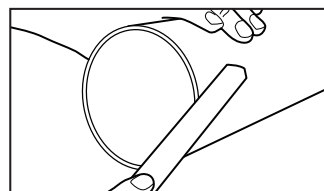

- 3.** Deburr tube OD using half round file.

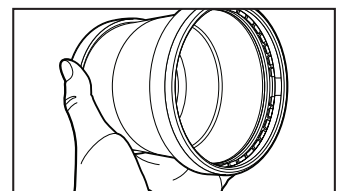

- 4.** Check fitting ends to ensure seal, grip ring and nylon spacer are present. Do not use any type of oil lubrication.

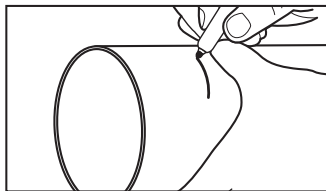

- 5.** Mark tube to proper fitting insertion depth (see Insertion Depth Chart below).

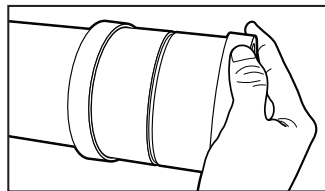

- 6.** Turn slightly while sliding press fitting onto tube. Slide all the way to insertion mark and make contact with stop.

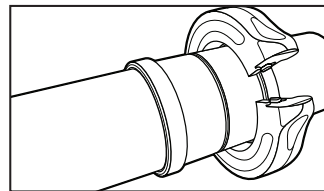

- 7.** Place press-ring at a right angle over fitting bead and check for proper engagement. Re-check insertion depth.

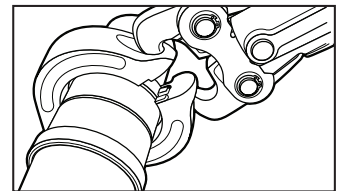

- 8.** Start the pressing process. Please see specific tool manufacturer for tool instruction.

Streamline PRS Fitting Insertion Depth Chart (2-1/2" - 4")

Tube Size	2-1/2"	3"	4"
Insertion Depth	1-3/4"	1-7/8"	2-1/8"



Large diameter (2-1/2" - 4") Streamline PRS fittings must be connected with approved press tool and press-rings. Please see specific tool manufacturer for tool instruction.

WARNING

Failure to follow all instructions could affect joint/system integrity and may lead to property damage. Call Customer Service at 1-800-FITTING if you have any questions or need assistance.