



a Geberit company

2100 South Clearwater Drive
Des Plaines, IL 60018
Phone: 847-803-5000
Fax: 847-803-5454
www.chicagofaucets.com

FOR TECHNICAL ASSISTANCE
1-800-TEC-TRUE (1-800-832-8783)

REPAIR PARTS

BY: JAR DATE: 01-18-12
CHK: *Jae* REV: 01-14-22

FITTING NO.
SEE SCHEDULE
SUBMITTED MODEL NO.
ITEM NO.

SCHEDULE	SCHEDULE
FITTING NO.	FITTING NO.
3500-E39VPABCP	3500-E2805ABCP
3500-4E39VPABCP	3500-4E2805ABCP
3500-8E39VPABCP	3500-8E2805ABCP

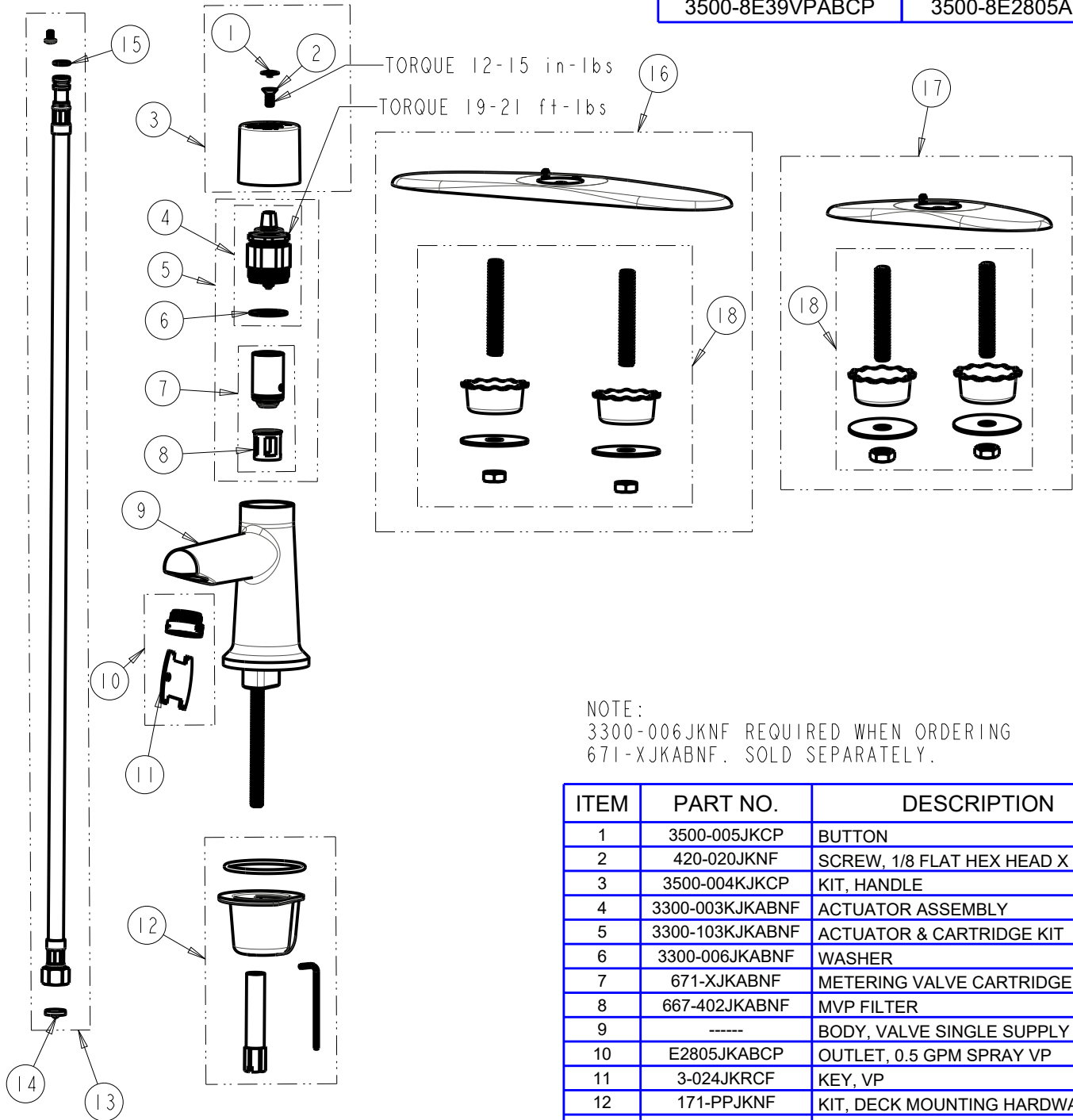

NOTE:
3300-006JKNF REQUIRED WHEN ORDERING
671-XJKABNF. SOLD SEPARATELY.

ITEM	PART NO.	DESCRIPTION
1	3500-005JKCP	BUTTON
2	420-020JKNF	SCREW, 1/8 FLAT HEX HEAD X 1/2
3	3500-004JKKCP	KIT, HANDLE
4	3300-003KJKABNF	ACTUATOR ASSEMBLY
5	3300-103KJKABNF	ACTUATOR & CARTRIDGE KIT
6	3300-006JKABNF	WASHER
7	671-XJKABNF	METERING VALVE CARTRIDGE
8	667-402JKABNF	MVP FILTER
9	-----	BODY, VALVE SINGLE SUPPLY
10	E2805JKABCP	OUTLET, 0.5 GPM SPRAY VP
11	3-024JKRCF	KEY, VP
12	171-PPJKNF	KIT, DECK MOUNTING HARDWARE
13	245.536.00.1	BRAIDED HOSE KIT
14	3300-205JKABNF	FILTER SCREEN, 50 MESH
15	243.392.AB.1	O-RING, #011
16	3500-002JKKCP	KIT, COVER PLATE 8 IN
17	3500-001JKKCP	KIT, COVER PLATE 4 IN
18	242.872.21.1	KIT, COVER PLATE MOUNTING