

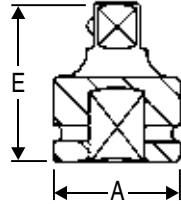

1/2" Drive Impact Attachments



1/2" Drive Adapters SAE



Item Number	Female End	Male End	Socket Retention Device	Dimensions (Inches)	
				A	E
*2228A	1/2"	3/8"	Friction Ball	.98	1.50
*2228AL	1/2"	3/8"	Locking Pin	.98	1.50
2238A	1/2"	3/4"	Friction Ball	1.18	1.89
2238AL	1/2"	3/4"	Locking Pin	1.18	1.89

1/2"

* Reducing Adapters are not covered by the GP Warranty.
 * See page 182 for New Reducing Sleeve Adapters

1/2" Drive Extra-Long Reducing Adapters SAE

Extra-long impact socket reducing adapters, forged in a single piece for extra strength and durability.



2257AL



2267AL



2277AL

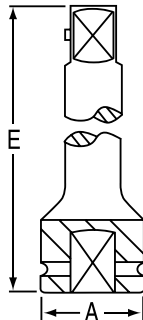

Item Number	Overall Length	Female End	Male End	Socket Retention Device	Dimensions (Inches)	
					A	E
*2257AL	18"	1/2"	3/8"	Locking Pin	.98	18.11
*2267AL	24"	1/2"	3/8"	Locking Pin	.98	24.00
*2277AL	36"	1/2"	3/8"	Locking Pin	.98	36.00

* Reducing Adapters are not covered by the GP Warranty.

1/2" Drive Universal Joints SAE



2229UJ
(Standard)



2229TUJ
(Thin-Wall)

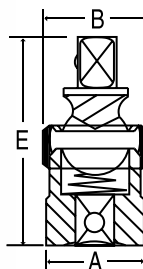

Item Number	Size	Socket Retention Device	Dimensions (Inches)		
			A	B	E
2229UJ	1/2" x 1/2"	Friction Ball	1.26	1.32	2.36
2229UJL	1/2" x 1/2"	Locking Pin	1.26	1.32	2.36
*2229TUJ	1/2" x 1/2"	Friction Ball	.93	1.00	2.36

* 2229TUJ is a thin-wall design that provides extra clearance in tight spaces.

Due to the thin wall design the #2229TUJ is not covered by the GP Warranty.