

NOTES:

1. TO INSPECT ASSEMBLY, FOLLOW FIRST ARTICLE AND IN PROCESS INSPECTION SHEET.

BILL OF MATERIAL (CURRENT LEVEL)

ITEM	PT/ASSY	DESCRIPTION	TYPE	QTY.
1	10960	HEX ESCUTCHEON	PART	1
2	2-142	HANDLE ONLY, COLD	ASSEMBLY	1
3	91754	O-RING, #2-034, EPDM, 50 DURO - GREY	PART	1

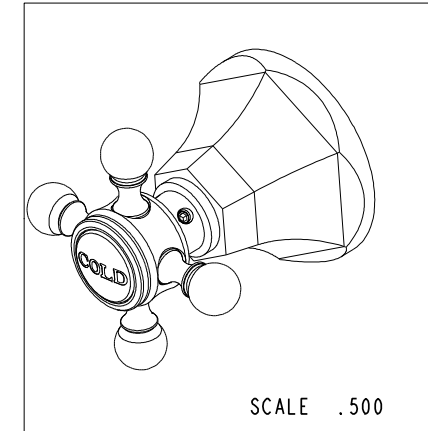
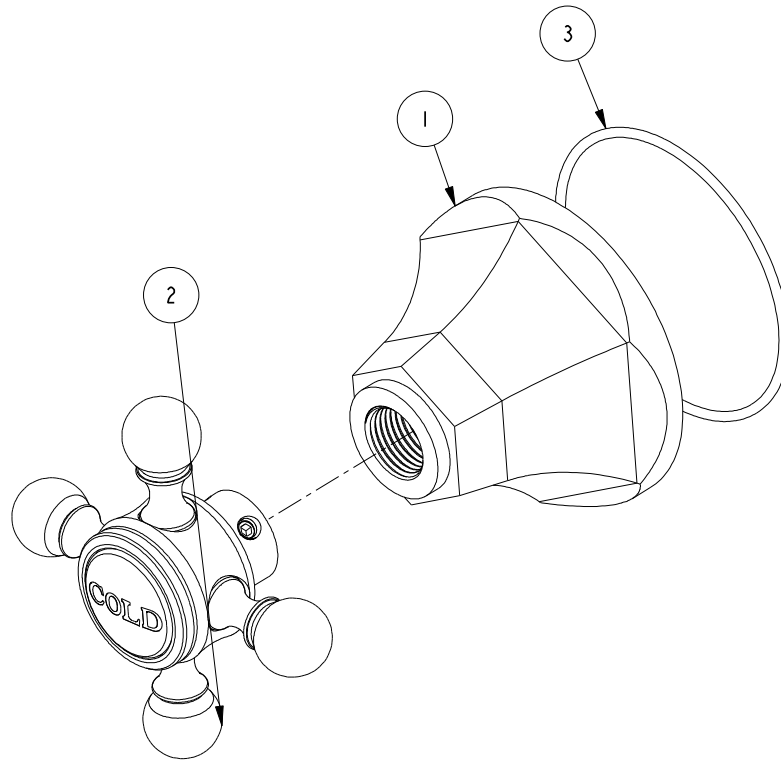

ZONE	REV	DESCRIPTION	DATE	APPROVED	TESTING	ASSEMBLY	PLATING	POLISHING	MACHINING	TOOLING FIXTURE #	APPLICATION
-	B	EN-4300j	12/16/20	R.S.	-	-	-	-	-	-	-
-	A	EN-3722	02/08/19	C.G.	-	-	-	-	-	-	1220, 1220C
-	-	EN-3194	12/16/16	AN	-	-	-	-	-	-	NEXT ASSY USED ON
-	-	-	-	-	-	-	-	-	-	-	REMOVE ALL BURRS AND SHARP EDGES

COPYRIGHT 2005 BRASSTECH, INC. THESE DRAWINGS AND THE DESIGNS DEPICTED HEREIN ARE THE PROPRIETARY PROPERTY OF BRASSTECH. ANY USE OR REPRODUCTION IS SUBJECT TO THE EXPRESS APPROVAL OF BRASSTECH. UNAUTHORIZED USE IS STRICTLY PROHIBITED. ALL RIGHTS RESERVED.

UNITS ARE: INCHES [MM]
 TOLERANCES ARE:
 FRACTIONS DECIMALS ANGLES
 $\pm 1/16"$.X $\pm .1$ [2.5] $\pm 1^\circ$
 .XX $\pm .06$ [1.5]
 (X.XXX) DENOTES CRITICAL DIMS.
 ALL THREADS ARE CRITICAL
 DRAWN JIMSON 12/16/20
 CHECKED R.S. 12/16/20
 APPROVED R.S. 12/16/20

BRASSTECH 2001 CARNEGIE AVE.
 INCORPORATED SANTA ANA, CA 92705
 (949) 417-5207

HANDLE/ESC ASM, COLD

DWG NO. **3-595C** REV **B**

SCALE .750 REF. - SHEET 1 OF 2

