

Whizweld® BRANCHLET® WELDING OUTLET

- **A WELDING OUTLET FITTING RATED FOR 300 PSI** and up to 500 psi for non-fire sprinkler applications.
- **QUALIFIED** to be welded on various proprietary thin wall flow pipe as well as industry standard pipe schedules 10 and 40.
- **CLEANED & PROTECTED.** Shot blasted and/or washed to reduce weld porosity thereby improving job quality and lowering fabrication costs. Coated with a proprietary smokeless non-flash rust inhibitor for improved shelf life.
- **MATERIAL SAVING.** The Whizweld® bevel design reduces the amount of weld material needed.
- **UL LISTED** in accordance to UL 213B with qualifying tests up to 1500psi.
- **FM APPROVED** in accordance to FM Class 1920 with qualifying tests up to 1200psi.
- **PRECISION MANUFACTURED** from highly weldable carbon steel conforming to ASTM 1010, A-53, A135 or A795. The contour, threaded and/or grooved ends are produced on automated precision equipment for superior dimensional accuracy and quality consistency.
- **FULLY TRACEABLE** with complete identifying marks including a lot number for full material traceability and overall quality assurance.
- **THREADED OR GROOVED.** Outlets are available with ANSI B1.20.1 NPT threads, Victaulic® **IGS**®, or OGS cut or roll grooves.



Whizweld®

The **Whizweld®** bevel design sits squarely on the header for unproblematic one pass welds on automatic welding equipment. Furthermore, the inside diameter is sized to insure the welding cone fits without obstruction.

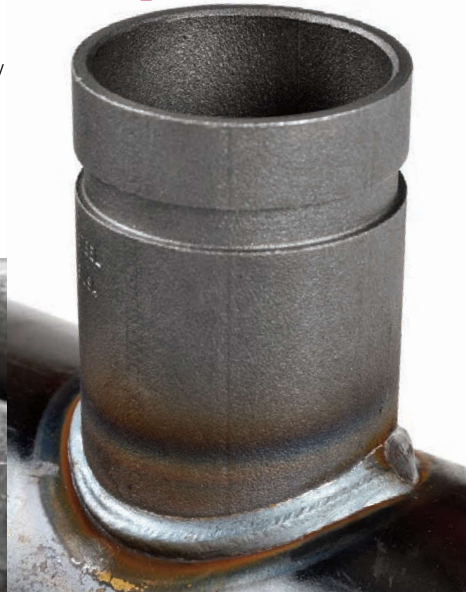

319 Circle of Progress
Pottstown, Pennsylvania 19464-3811 USA
Tel (610)676.0300 Fax (610)676.0383

Additional details and installation instructions at AegisTechnologiesInc.com/Branchlet

AUTHORIZED DISTRIBUTOR

Whizweld® BRANCHLET® WELDING OUTLET



TYPE 3F NPT THREADED OUTLET

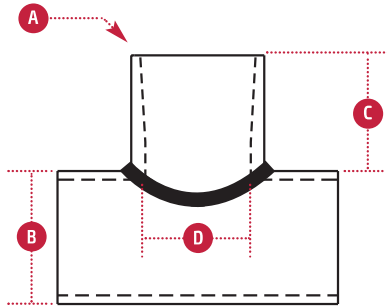

PART # TYPE 3F NPT THREADED	OUTLET A IN	HEADER B IN	OUTLET LENGTH C IN	INSIDE DIA. D IN	WEIGHT LBS	BOX QUANTITY
90301212	1.25 x	1.25	1.375	1.47	0.43	70
90301215		1.5 - 2	1.375	1.47	0.42	70
90301220		2 - 2.5	1.375	1.47	0.42	70
90301225		2.5 - 3	1.375	1.47	0.41	70
90301230		3 - 4	1.375	1.47	0.39	70
90301240		4	1.375	1.47	0.39	70
90301250		5 - 8	1.375	1.47	0.39	70
90301515	1.5 x	1.5	1.625	1.61	0.48	50
90301520		2	1.625	1.61	0.48	50
90301525		2.5	1.625	1.61	0.47	50
90301530		3 - 4	1.625	1.61	0.47	50
90301540		4	1.625	1.61	0.47	50
90301550		5 - 8	1.625	1.61	0.47	50
90302020	2 x	2	1.75	2.067	0.86	25
90302025		2.5	1.75	2.067	0.83	25
90302030		3	1.75	2.067	0.83	25
90302040		4	1.75	2.067	0.8	25
90302060		6	1.75	2.067	0.74	25
90302080		8	1.75	2.067	0.74	25
90302525	2.5 x	2.5	2.125	2.469	1.25	35
90302530		3	2.125	2.469	1.2	35
90302540		4	2.125	2.469	1.15	35
90302560		6	2.125	2.469	1.15	35
90302580		8	2.125	2.469	1.15	35
90303030	3 x	3	2.5	3.068	3.1	20
90303040		4	2.5	3.068	3.1	20
90303060		6	2.5	3.068	3.1	20
90303080		8	2.5	3.068	3.1	20
90304040	4 x	4	3	4.026	5	10
90304060		6	3	4.026	5	10
90304080		8	3	4.026	5	10

PART # TYPE 3F NPT THREADED	OUTLET A IN	HEADER B IN	OUTLET LENGTH C IN	INSIDE DIA. D IN	WEIGHT LBS	BOX QUANTITY
90300512	0.5 x	1.25 - 1.5	1.063	0.7	0.18	325
90300515		1.5 - 2	1.063	0.7	0.18	325
90300520		2 - 2.5	1.063	0.7	0.18	325
90300525		2.5 - 8	1.063	0.7	0.18	325
90300712	0.75 x	1.25 - 1.5	1.125	0.9	0.32	200
90300715		1.5 - 2	1.125	0.9	0.32	200
90300720		2 - 2.5	1.125	0.9	0.32	200
90300725		2.5 - 8	1.125	0.9	0.32	200
90301012	1 x	1.25 - 1.5	1.25	1.145	0.44	125
90301015		1.5 - 2	1.25	1.145	0.44	125
90301020		2 - 2.5	1.25	1.145	0.44	125
90301025		2.5 - 3	1.25	1.145	0.44	125
90301030		3 - 4	1.25	1.145	0.44	125
90301050		5 - 8	1.25	1.145	0.44	125

TYPE 3V VICTAULIC® IGS™ GROOVED OUTLET

PART # TYPE 3V IGS GROOVED	OUTLET A IN	HEADER B IN	OUTLET LENGTH C IN	INSIDE DIA. D IN	WEIGHT LBS	BOX QUANTITY
90321012	1 x	1.25 - 1.5	1	1.05	0.15	200
90321015		1.5 - 2	1	1.05	0.15	200
90321020		2 - 2.5	1	1.05	0.15	200
90321025		2.5 - 3	1	1.05	0.15	200
90321030		3 - 4	1	1.05	0.15	200

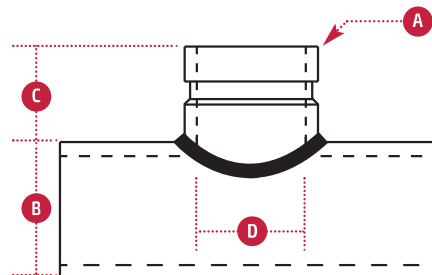

Victaulic® and IGS® are trademarks of Victaulic Company, and are used with permission.



319 Circle of Progress, Pottstown, Pennsylvania 19464-3811 USA Tel (610)676.0300 Fax (610)676.0383 AegisTechnologiesInc.com