

CPVC X F1960 TRANSITION FITTING

645WGC SERIES

SPECIFICATION

Sioux Chief ASTM F1960 x CPVC transition fittings shall be used in plumbing systems for safe distribution of hot or cold water. Fittings shall be used for fluid communication with plumbing devices and fixtures. Transition fittings shall be listed to appropriate standards including ASTM fitting end specifications.

MATERIALS

Plastic: CPVC

Brass: No Lead, Dezincification (DZR) resistant & Stress Corrosion Cracking (SCC) resistant

O-ring: EPDM

MAXIMUM TEMPERATURE

180°F

CERTIFICATIONS

cUPC, FGG/BM/CZ system compatible

INSTALLATION LIMITATIONS

Do Not expose CPVC transition fitting to heat above those listed on tubing. Excessive heat will damage the integral o-ring seal. Do not install damaged fittings. Do not alter fittings. Do not solder or braze in close proximity to fitting unless it is protected with a heat-blocker to protect/keep the fitting under 180°F. Keep fitting free from hazardous chemicals or chemical vapors.

DIMENSIONS

	645WGC2	645WGC3	645WGC4
A: F1960 PEX connection	1/2"	3/4"	1"
B: CPVC socket connection	1/2"	3/4"	1"
C: Overall length	1.38"	1.81"	2.24"
D: Overall hex width across flats	1"	1.38"	1.75"

ITEM # SUBMITTED	_____
JOB NAME	_____
LOCATION	_____
ENGINEER	_____
CONTRACTOR	_____
PO#	_____ TAG _____



645WGC3

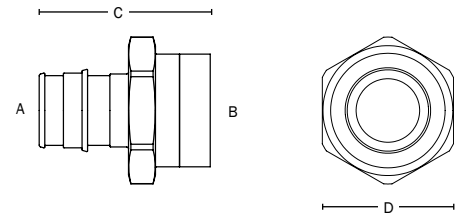

Create Item Number

645A

e.g. **645WGC3:** 3/4" CPVC Socket x brass F1960 PEX transition fitting

CONNECTION A

WGC2 = 1/2" CPVC Socket x F1960 PEX

WGC3 = 3/4" CPVC Socket x F1960 PEX

WGC4 = 1" CPVC Socket x F1960 PEX