

Spare parts list
AUMA®
 Multi-turn actuators
 SA 07.1 – SA 16.1
 SAR 07.1 – SAR 16.1
 AUMA NORM

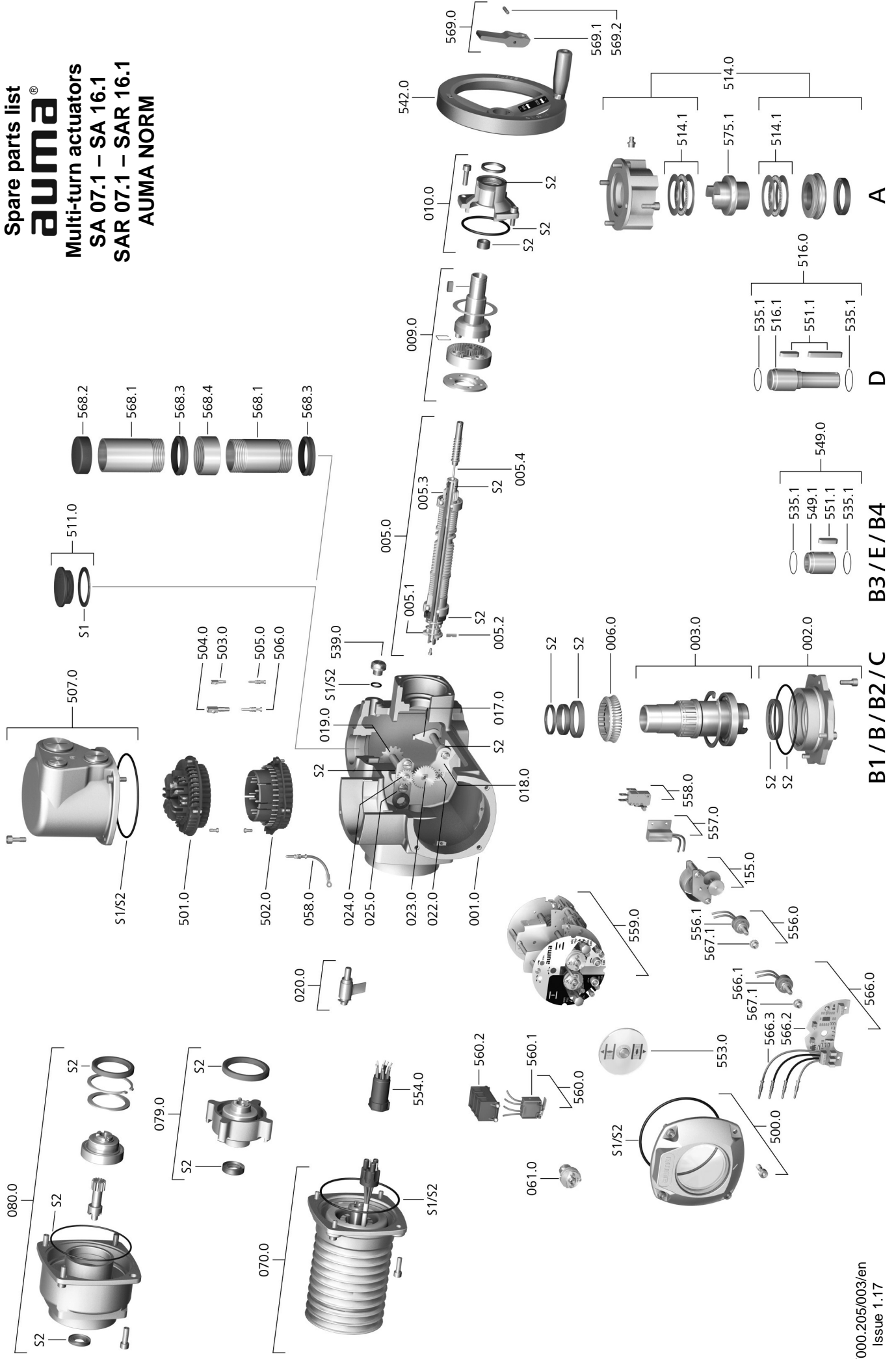

Spare parts list Multi-turn actuators AUMA NORM

Please state device type and our order number (see name plate) when ordering spare parts. Only original AUMA spare parts should be used. Failure to use original spare parts voids the warranty and exempts AUMA from any liability. Representation of spare parts may slightly vary from actual delivery.

Ref. no.	Designation	Type	Ref. no.	Designation	Type
001.0	Housing	Sub-assembly	514.1	Axial needle roller bearing	Sub-assembly
002.0	Bearing flange	Sub-assembly	516.0	Output drive type D	Sub-assembly
003.0	Output drive type B1/B/B2/C	Sub-assembly	516.1	Output drive shaft D	
005.0	Drive shaft	Sub-assembly	535.1	Snap ring	
005.1	Motor coupling		539.0	Screw plug	
005.2	Coupling pin		542.0	Handwheel with ball handle	Sub-assembly
005.3	Manual drive coupling		549.0	Output drive type B3/E/B4	Sub-assembly
005.4	Pull rope		549.1	Output drive sleeve B3/E/B4	
006.0	Worm wheel		551.1	Parallel key	
009.0	Manual gearing	Sub-assembly	553.0	Mechanical position indicator	Sub-assembly
010.0	Retaining flange	Sub-assembly	554.0	Socket carrier for motor plug/socket connector with cable harness	Sub-assembly
017.0	Torque lever	Sub-assembly	556.0	Potentiometer as position transmitter	Sub-assembly
018.0	Gear segment		556.1	Potentiometer without slip clutch	Sub-assembly
019.0	Crown wheel	Sub-assembly	557.0	Heater	Sub-assembly
020.0	Swing lever	Sub-assembly	558.0	Blinker transmitter including pins at wires (without impulse disc and insulation plate)	Sub-assembly
022.0	Drive pinion II for torque switching	Sub-assembly	559.0	Electromechanical control unit with switches, including torque switching heads	Sub-assembly
023.0	Output drive wheel for limit switching	Sub-assembly	560.0-1	Switch stack for direction OPEN	Sub-assembly
024.0	Drive wheel for limit switching	Sub-assembly	560.0-2	Switch stack for direction CLOSE	Sub-assembly
025.0	Locking plate	Sub-assembly	560.1	Switch for limit/torque	
058.0	Cable for protective earth	Sub-assembly	560.2	Switch case	
061.0	Torque switching head	Sub-assembly	566.0	RWG position transmitter	Sub-assembly
070.0	Motor (only for V... motors incl. ref. no. 079.0)	Sub-assembly	566.1	Potentiometer for RWG without slip clutch	Sub-assembly
079.0	Planetary gearing for motor drive (SA/SAR 07.1 - 14.1 for V ... motors)	Sub-assembly	566.2	Position transmitter board for RWG	Sub-assembly
080.0	Planetary gearing for motor drive (SA/SAR 16.1 for A motors)	Sub-assembly	566.3	Cable set for RWG	Sub-assembly
155.0	Reduction gearing	Sub-assembly	567.1	Slip clutch for potentiometer	Sub-assembly
500.0	Cover	Sub-assembly	568.1	Stem protection tube (without cap)	
501.0	Socket carrier (complete with sockets)	Sub-assembly	568.2	Protective cap for stem protection tube	
502.0	Pin carrier without pins	Sub-assembly	568.3	V-seal	
503.0	Socket for controls	Sub-assembly	568.4	Threaded sleeve	
504.0	Socket for motor	Sub-assembly	569.0	Change-over lever assy	
505.0	Pin for controls	Sub-assembly	569.1	Change-over lever	
506.0	Pin for motor	Sub-assembly	569.2	Notched pin	
507.0	Cover for electrical connection	Sub-assembly	575.1	Stem nut A (without thread)	
511.0	Threaded plug	Sub-assembly	S1	Seal kit, small	Set
514.0	Output drive type A (without stem nut)	Sub-assembly	S2	Seal kit, large	Set