

CT705ELN & CT705ELNG

CT705ELN

CT705ELNG

Commercial, 1-1/2" Top Spud Inlet, 1.6 Gpf or 1.28 Gpf Toilet, Elongated, Flushometer, ADA, 10" - 12" Rough-In, (including SanaGloss®)

Items	Part No	Description
1	THU073R	Top Spud
2	THU120R	Spud Gasket (10 Pieces)
3	THU098#01	Bolt Cap Sets (for 10 toilets) for #01
	THU098#03	Bolt Cap Sets (for 10 toilets) for #03 & #12

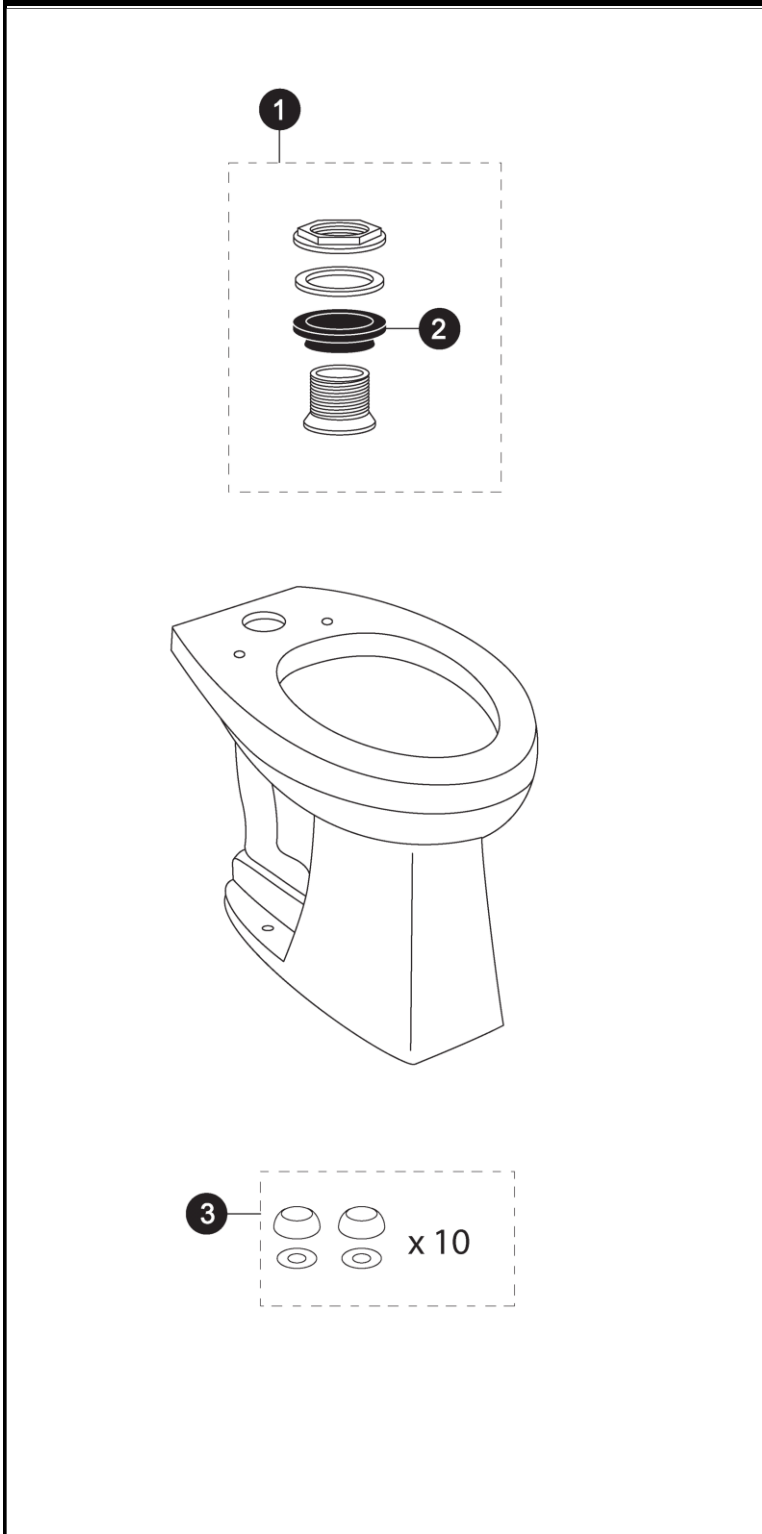

Note:

Product Number Explanations

Flushometer Toilet

(CT) Commercial Toilet
(705) Model
(E) 1.28 Gpf or 1.6Gpf
(L) ADA Compliant
(N) Model
(G) SanaGloss®

Colors

(#01) Cotton
(#03) Bone
(#12) Sedona Beige

Actual Product may vary slightly from illustration.