

TD-THN-24
VENTUS BATH SINK

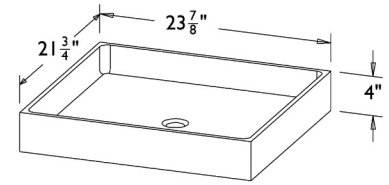

- Available in:
Antique Gray Limestone (AGL)
Carrara Marble (CA)

- Fits various Elemental bath vanities
or can be used as a vessel sink

- Approx 80 lbs



TD-THN-36
VENTUS BATH SINK

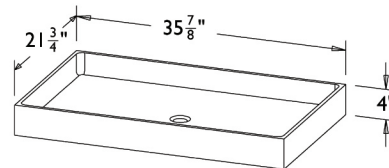

- Available in:
Antique Gray Limestone (AGL)
Carrara Marble (CA)

- Fits various Elemental bath vanities
or can be used as a vessel sink

- Approx 100 lbs



TD-THN-FCT-24
VENTUS BATH SINK
WITH FAUCET DECK

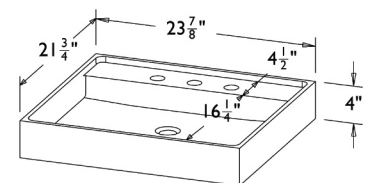

- Available in:
Antique Gray Limestone (AGL)
Carrara Marble (CA)

- Please specify quantity and location
of any faucet holes when ordering.
See price list for drilling charges.

- Fits various Elemental bath vanities
or can be used as a vessel sink
- Approx 100 lbs

- Required drains can be purchased through Stone Forest. 9054D grid drain, 9058D lift & turn drain, or 9050ZB Zero drain.
- DO NOT use pop-up drains.
- USE ONLY Stain-Free plumbers putty that specifically states safe for granite and marble.

All designs copyright Stone Forest Inc. All rights reserved

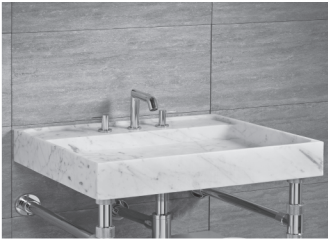

**TD-THN-FCT-36
VENTUS BATH SINK
WITH FAUCET DECK**

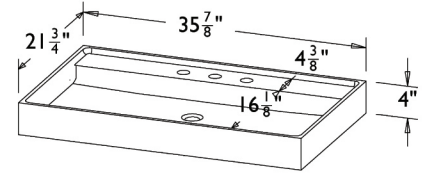

- Available in:
Antique Gray Limestone (AGL)
Carrara Marble (CA)
- Please specify quantity and location of any faucet holes when ordering. See price list for drilling charges.
- Fits various Elemental bath vanities or can be used as a vessel sink
- Approx 120 lbs



**TD-VNT-24
TERRA BATH SINK**

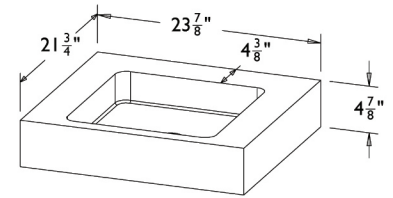

- Available in:
Antique Gray Limestone (AGL)
Carrara Marble (CA)
- Please specify quantity and location of any faucet holes when ordering. See price list for drilling charges.
- Fits various Elemental bath vanities or can be used as a vessel sink

■ Approx 150 lbs



**TD-VNT-36
TERRA BATH SINK**

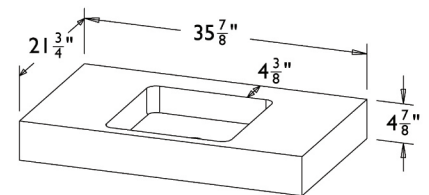

- Available in:
Antique Gray Limestone (AGL)
Carrara Marble (CA)
- Please specify quantity and location of any faucet holes when ordering. See price list for drilling charges.
- Fits various Elemental bath vanities or can be used as a vessel sink

■ Approx 175 lbs

- Required drains can be purchased through Stone Forest. 9054D grid drain, 9058D lift & turn drain, or 9050ZB Zero drain.
- DO NOT use pop-up drains.
- USE ONLY Stain-Free plumbers putty that specifically states safe for granite and marble.

All designs copyright Stone Forest Inc. All rights reserved