

For male faucets with outside threads:

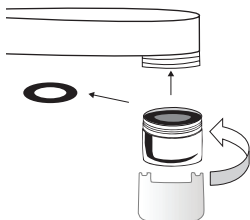

For female faucets with inside threads:

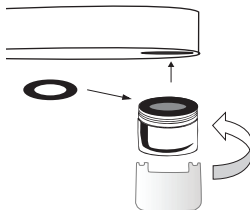

For faucets with outside threads,

Remove aerator from spout.

Remove thicker washer.

Use key to install the new aerator.

Turn on faucet. If leak occurs, tighten more firmly.

For faucets with inside threads,

Remove aerator from spout.

Keep washer in place.

Use key to install the new aerator.

Turn on faucet. If leak occurs, tighten more firmly.