



CONSOLE SINK

BEFORE INSTALLING

Read entire Console Sink Installation Instructions.
Observe all local building and safety codes.

INSTRUCTIONS

Unpack and inspect the product for any shipping damages. If you find damages, do not install. Contact Customer Service at 1-866-855-2284. If you need assistance or have questions while installing your sink, contact Customer Service.

Console sinks must be anchored to wall studs or solid wood blocking. If the studs in your bathroom do not line up to the mounting location for your sink, wood blocking should be installed between the studs using standard 2 x 4's. We recommend consulting a professional if you are unfamiliar with this type of installation.

Because wall construction and materials vary from home to home, Signature Hardware does not provide mounting hardware for all of our console sinks. The appropriate mounting hardware can be purchased from your local hardware store. For this installation it is assumed that any old fixtures have been removed and all rough-in work has been completed.

We recommend consulting a professional if you are unfamiliar with installing bathroom fixtures. Signature Hardware accepts no liability for any damage to the floor, walls, plumbing or for personal injury during installation.

TOOLS AND MATERIALS:



Pencil



Drill



Level



Stud Finder



Silicone Sealant



Damp Cloth



Tape Measure

INSTALLATION

1. Determine and mark the sink installation location.
2. Locate and mark the location of the studs to which you will fasten your sink stand. You can find studs by listening for a solid sound as you knock on the wall or by using a stud finder.
3. Thread the mounting hardware through the mounting holes in the stand and attach to the wall. Make sure that the stand is level before fully securing.
4. Set the vanity top or integral sink on the stand and verify that the top is level.
Note: If the stand or vanity top are not level use wooden shims to adjust as necessary.
5. Raise the vanity top and place a dot of silicone sealant on the corners of the vanity.
6. Position the vanity top back onto the stand and press firmly into place.
7. Wipe away any excess sealant with a damp cloth.
8. Let silicone sealant dry for 24 hours before using your console sink. If a lavatory drain is included, move on to the Drain Installation section.

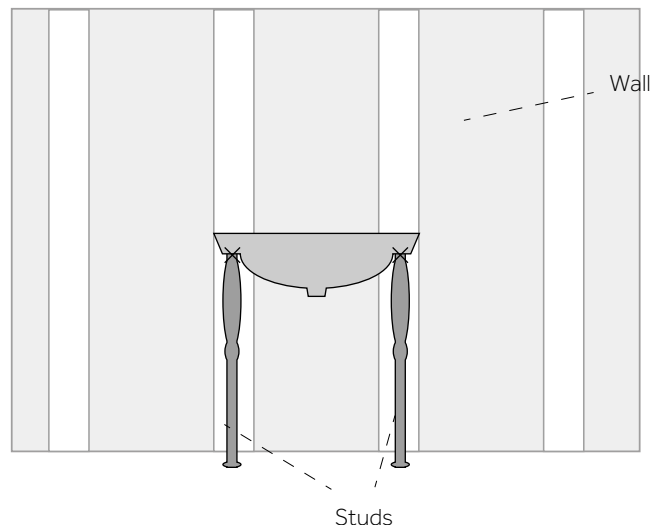



DRAIN INSTALLATION

DRAIN INSTALLATION

1. Disassemble the drain by removing the threaded tail piece, rubber sealing gaskets, friction washer and lock nut from the drain body.

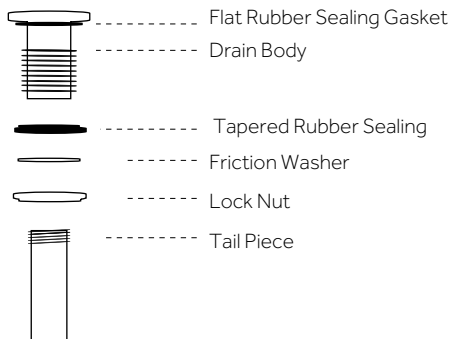

2. Place thread sealant on the threaded section of the tail piece and reattach to the drain body.

3. Slide the flat rubber sealing gasket up the tail piece to the top of the drain body. This gasket will create a water tight seal between the drain flange and sink.

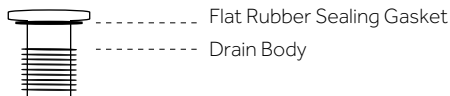

4. Place the drain in the drain hole in the sink.

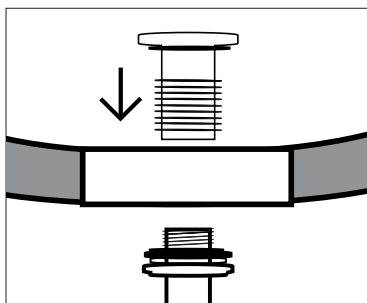

5. On the underside of the counter, attach the tapered rubber gasket. With the flat side facing down, slide the gasket up the threaded shank until it makes contact with the bottom of the sink.

6. Slide the friction washer up to meet the rubber gasket.

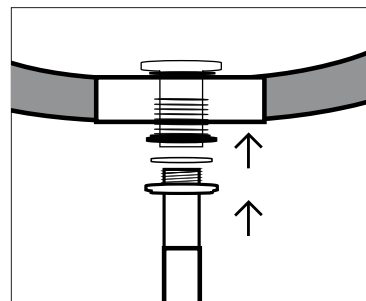

7. Thread the lock nut onto the threaded shank. Hand-tighten and make sure that the drain is properly aligned. When ready, finish tightening with a basin wrench to secure the drain.

