

## INSTALLATION INSTRUCTIONS

### DOUBLE POLE (4-WIRE) - 120 VOLT

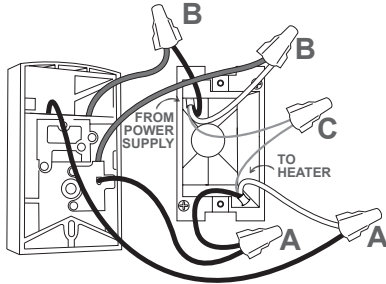

**A.** Connect the two black thermostat wires to the two loose heater wires.

**B.** Connect the two supply wires to the two red thermostat wires.

**C.** Connect the copper ground supply wire to the copper wire going to the heater.

Proceed to OPERATING INSTRUCTIONS.

## OPERATING INSTRUCTIONS

Make sure all wires are properly connected and installation is complete before you turn on the heater. Turn power back on at the main disconnect panel.

1. Turn the thermostat knob all the way to the right.
2. When the room reaches your comfort level, turn the knob to the left, just until it clicks and the heater turns off. The heater will automatically keep the room temperature at this setting.
3. To reduce the room temperature, turn the knob to the left. To increase the room temperature, turn the knob to the right.

**T521:** Turning the knob all the way to the left sets the temperature at about 41°F.

**T522:** Turning the knob all the way to the left turns the heater off.

## WARRANTY

For more effective and safer operation and to prolong the life of the heater, read the Owner's Guide and follow the instructions. Failure to properly maintain the heater will void any warranty and may cause the heater to function improperly.

**LIMITED ONE YEAR WARRANTY:** Cadet will repair or replace any Cadet T521 or T522 thermostat found to be defective within one year after the date of purchase. These warranties do not apply:

1. Damage occurs to the product through improper installation or incorrect supply voltage;
2. Damage occurs to the product through improper maintenance, misuse, abuse, accident, or alteration;
3. The use of unauthorized accessories or unauthorized components constitutes an alteration and voids all warranties. Refer to Cadet website or call customer service at 855.223.3887 or 360.693.2505 for list of authorized accessories and components.

4. Cadet's warranty is limited to repair or replacement.

5. In the event Cadet elects to replace any part of your Cadet product, the replacement parts are subject to the same warranties as the product. The installation of replacement parts does not modify or extend the underlying warranties. Replacement or repair of any Cadet product or part does not create any new warranties.

If you believe your Cadet product is defective, please contact Cadet during the warranty period, for instructions on how to have the repair or replacement processed.

### Parts and Service

Visit [cadetheat.com/parts-service](http://cadetheat.com/parts-service) for information on where to obtain parts and service.

## OWNER'S GUIDE

# T521 T522

## WALL THERMOSTAT



For how-to videos or more information, please visit:  
<http://cadetheat.com/install/t5>

ESPAÑOL ver la guía del propietario en [cadetheat.com/espanol/t5](http://cadetheat.com/espanol/t5)

Thank you for your purchase! Question or problem? Let us solve it with a single phone call, email or online chat! We'll save you a trip back to the store!

### Cadet Customer Service

Phone: 855.CADET.US (855.223.3887)  
email: [customerservice@cadetheat.com](mailto:customerservice@cadetheat.com)  
Live chat: [cadetheat.com](http://cadetheat.com) (contact us)

**CADET**   
INVITING WARMTH

[cadetheat.com](http://cadetheat.com)  
855.CADET.US  
Vancouver, Washington

## IMPORTANT INSTRUCTIONS

⚠ When using electrical appliances, basic precautions should always be followed to reduce the risk of fire, electric shock, and injury to persons, including the following:

1. Read all instructions before installing or using this thermostat.
2. Use this thermostat only as described in this manual. Any other use not recommended by the manufacturer may cause fire, electric shock, or injury to persons.
3. Do not insert or allow foreign objects to enter any ventilation or exhaust opening as this may cause an electric shock or fire, or damage the thermostat.
4. To disconnect thermostat turn off power to heater circuit at main disconnect panel.
5. Do not operate any thermostat after it malfunctions. Disconnect power at main disconnect panel and have thermostat inspected by a qualified electrician before reusing.
6. A thermostat has arcing or sparking parts inside. Do not use in areas where gasoline, paint, or flammable liquids are stored.

## ELECTRICAL RATINGS

120 vac - 22 amps 1/6 hp  
 208-240 vac - 22 amps 1/6 hp  
 277 vac - 18 amps 1/6 hp

## ⚠ WORKING WITH ELECTRICITY ⚠

If you are uncomfortable working with electricity, running electrical supply wire or installing a circuit breaker, please consult a licensed electrician.

Unanswered questions? Call our technical support team in Vancouver, Washington at **855.223.3887** or outside the USA 360.693.2505.

## REQUIRED TOOLS

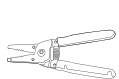

Wire Strippers



Volt Meter



Wire Connectors



Straight and Phillips Screwdrivers

## TIPS BEFORE YOU BEGIN

- **Verify power has been turned off before starting any work!**
- Follow the instructions in the Owner's Guide included with your heater until prompted to make thermostat connections.

## INSTALLATION INSTRUCTIONS

1. **WARNING:** All electrical work and materials must comply with the National Electric Code (NEC), the Occupational Safety and Health Act (OSHA), and all state and local codes.
2. **WARNING:** Make sure all wire connections to the thermostat are correct and tight to prevent electrical shorts. Use appropriate wire to meet NEC and local codes for rated power consumption.
3. Use copper conductors only.
4. Turn off power to heater at main disconnect panel.
5. Use wire connectors (not included) for all connections.
6. An electrical outlet box is required.

### SINGLE POLE (2-WIRE) - 120 VOLT

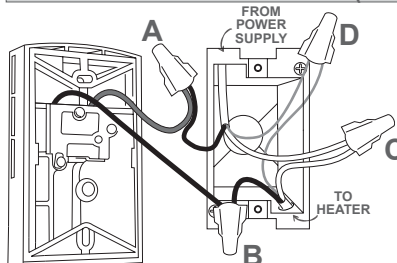

- A.** Connect the hot supply wire to the red thermostat wire.
- B.** Connect the black thermostat wire to the hot supply wire going to the heater.
- C.** Connect the remaining neutral supply wire to the remaining wire going to the heater.
- D.** Connect the copper ground supply wire to the copper wire going to the heater.

Proceed to OPERATING INSTRUCTIONS.

### SINGLE POLE (2-WIRE) - 240 or 208 VOLT

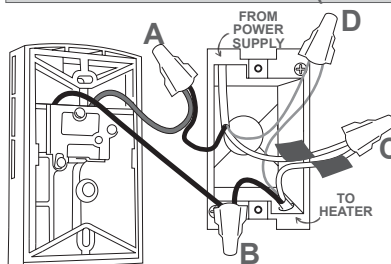

- A.** Connect one supply wire to the red thermostat wire.
- B.** Connect the black thermostat wire to one of the heater wires.
- C.** Connect the remaining supply wire to the remaining heater wire. Wrap supply (white) wire with black tape to identify it as hot!
- D.** Connect the copper ground supply wire to the copper wire going to the heater.

Proceed to OPERATING INSTRUCTIONS.

### DOUBLE POLE (4-WIRE) - 240 or 208 VOLT

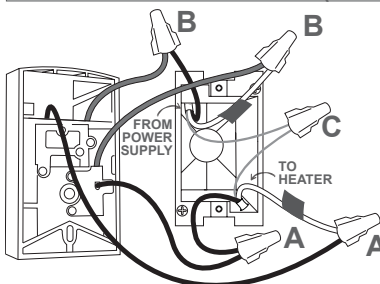

- A.** Connect the two black thermostat wires to the two loose heater wires.
- B.** Connect the two hot supply wires to the two red thermostat wires. Wrap supply (white) wire with black tape to identify it as hot!
- C.** Connect the copper ground supply wire to the copper wire going to the heater.

Proceed to OPERATING INSTRUCTIONS.