

IPT Sink Company

INSTALLATION INSTRUCTIONS TOP MOUNT STAINLESS STEEL KITCHEN SINK

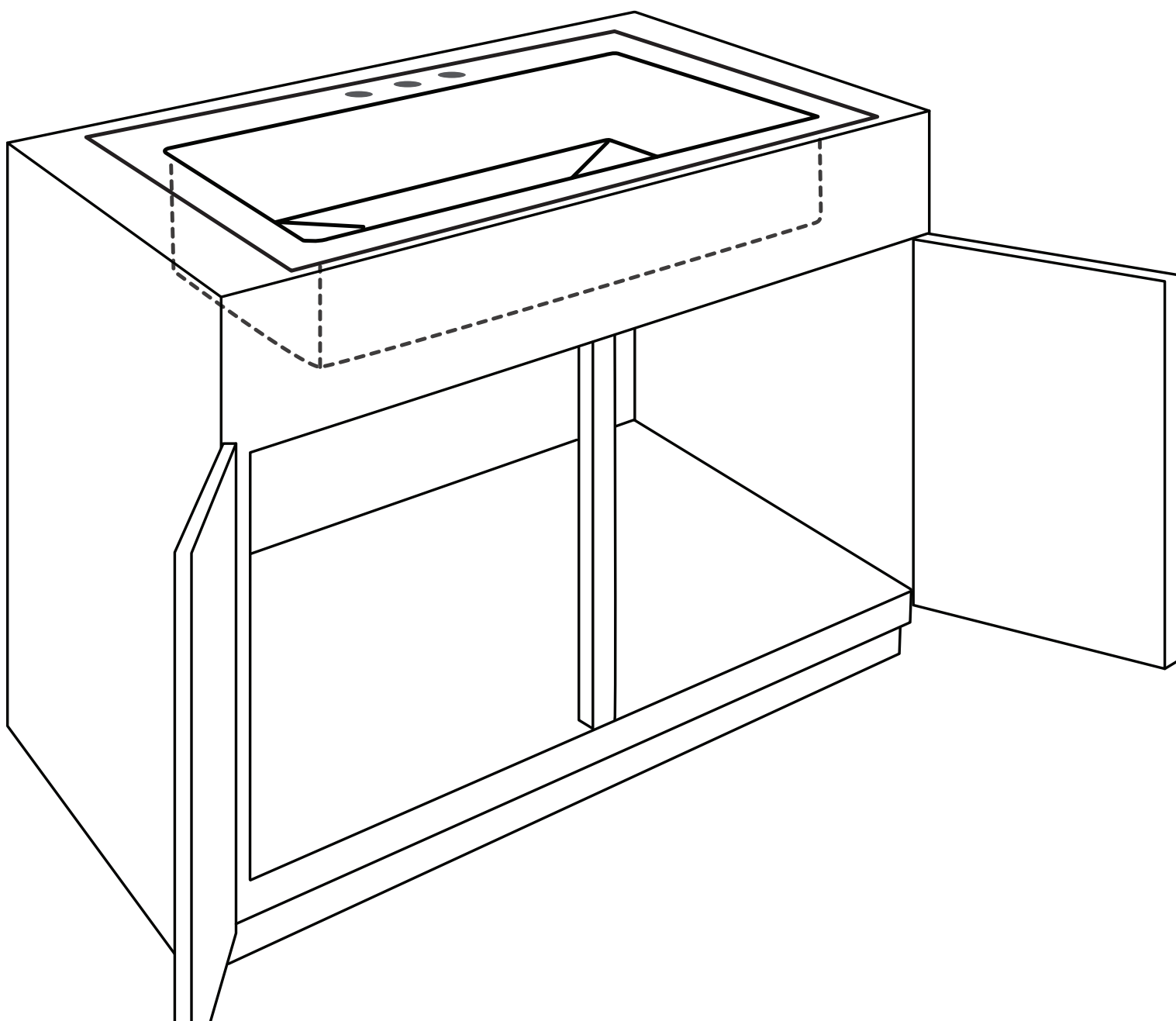

**CAUTION:**

Risk of personal injury or product damage. Handle with care.
Product can break, chip, cause injury or product damage.

WARNING:

This product can expose you to chemicals, including lead, which is known to the state of California to cause cancer and birth defects or other reproductive harm.

For more information go to p65warnings.ca.gov

IMPORTANT INFORMATION

- Read these instructions carefully before you begin this installation.
- Observe all applicable local plumbing and building codes.
- IPT Sink Company recommends all sinks are installed by experienced and professional installers. To ensure safety and damage-free installation, this sink should be installed by two people. IPT Sink Company reserves the right to revise the design of products without notice.

BEFORE YOU BEGIN

- IPT Sink Company recommends that all top mount sinks be installed by an experienced, professional installer.
- **IMPORTANT:** *The cabinet must be installed, secured, plumb, and level. Failure of this step can lead to product damage.*
- IPT Sink Company top mount sinks should only be fastened to a solid surface countertop (i.e. granite, Corian® or Silestone®).
- IPT Sink Company is not responsible for sink or countertop if damaged during installation. Be sure to inspect the sink for damage prior to beginning installation.
- Metal edges may be sharp – use caution when handling.
- Follow all local plumbing and building codes.

RECOMMENDED TOOLS

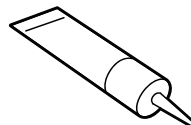
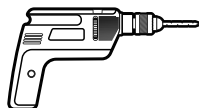
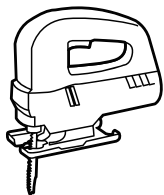
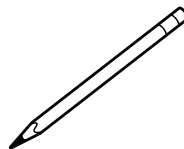
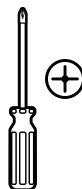
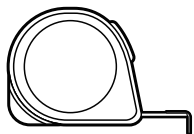

- | | |
|--|---|
| <input type="checkbox"/> Tape Measure | <input type="checkbox"/> Shims or Cabinet Fillers |
| <input type="checkbox"/> Safety Glasses | <input type="checkbox"/> Denatured Alcohol |
| <input type="checkbox"/> Painter's Tape | <input type="checkbox"/> Clamps |
| <input type="checkbox"/> Level | <input type="checkbox"/> Construction Adhesive |
| <input type="checkbox"/> Ear Protection | <input type="checkbox"/> Silicone Adhesive Sealant |
| <input type="checkbox"/> Hacksaw/Jigsaw | <input type="checkbox"/> Support Framing Material (1 1/4" (32mm) Max Thickness) |
| <input type="checkbox"/> Pencil (Not permanent marker) | <input type="checkbox"/> Screws (recommended by countertop manufacturer) |

STAINLESS STEEL SINK TOP MOUNT INSTALLATION INSTRUCTIONS

STEP1: COUNTERTOP PREPARATION

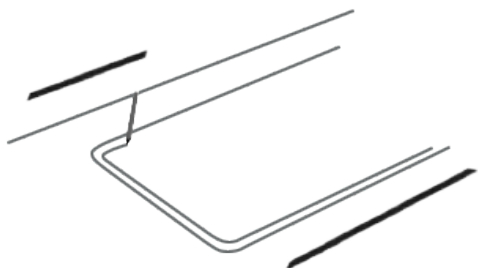
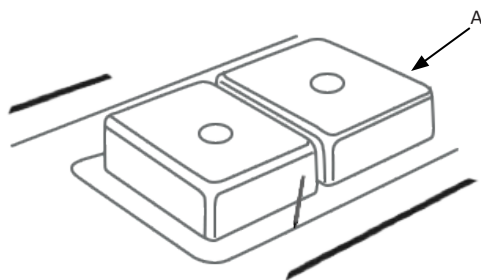

- Position the sink (A) upside down on the countertop.
- Trace completely around the edge of the sink (A).
- Draw a line 5/16" inside of the outline of the sink.

STEP2: CUTTING THE COUNTER

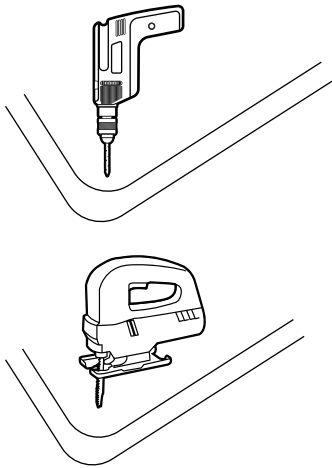

- Drill a pilot hole in all four corners of the inside line.
- Use a saber saw or jig saw to cut on the inside line.
- Place a support underneath the cutout portion of the countertop to prevent it from falling during cutting.
- **IMPORTANT:** Always wear safety goggles and gloves when using power tools to prevent personal injury.

STEP3: SINK INSTALLATION

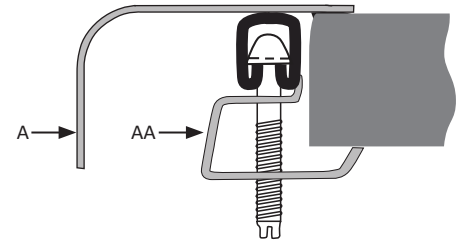
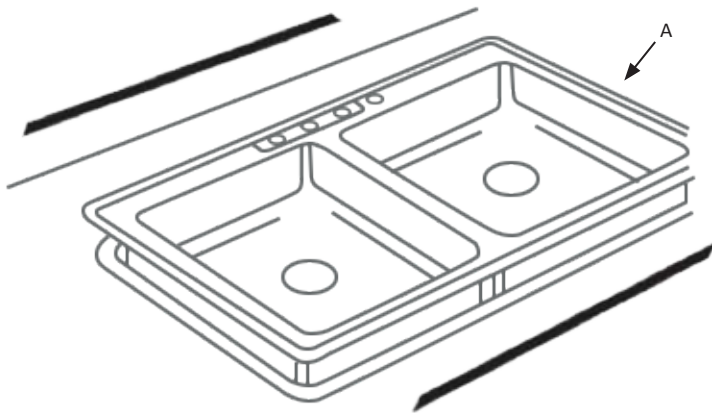

- Apply silicone sealant (not included) around the cutout on the countertop surface.
- Carefully lower the sink (A) into the cutout in the countertop.
- Preassemble the clamps and screws (AA).
- From the underside - place the clamp (AA) in the center along each side and hand tighten to hold sink in place. Fasten the remaining clamps (AA) along the edges and space them approximately 3 in. from each end, and equally along the front, back and sides. For countertops thicker than 3/4 in., space them up to 1-1/2 in. apart.
- From the top - check the seal between the sink (A) edge and countertop. Adjust clamps (AA) if necessary.
- Lightly tighten clamps (AA) evenly with a screw driver until the sink is perfectly tight to the countertop. Do not over tighten.
- Wipe away any excess sealant with a rag.