

F2159 POLY PEX ADAPTER

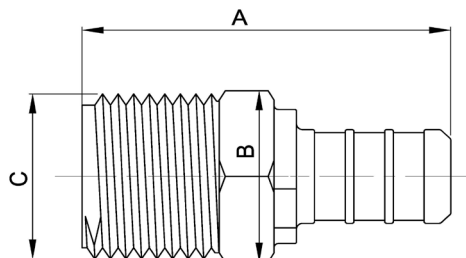

- Simple and dependable plumbing connection
- Easy installation
- Leak-proof connections
- Polymer construction
- Manufactured of premium-grade resin with non-mixed blends
- Can be used with brass PEX crimp rings or stainless steel PEX clamps
- Certified to ASTM F2159-2014 and CSA B137.5-2013
- Certified to ASTM F877-2020 and CSA B137.5-2020
- Certified to NSF/ANSI 14-2015, NSF/ANSI 14-2016a, and NSF/ANSI 372-2011
- Certified to NSF/ANSI/CAN 61-2018
- cUPC listed



Part No.	Description	Color	A - in (mm)	B - in (mm)	C - in	Weight-lbs (grams)
C76707	1/2" F2159 x MIP	White	1.69 (43.00)	0.87 (22.00)	1/2" NPT	0.02 (7.50)
C76759	1/2" F2159 x MIP	Black	1.69 (43.00)	0.87 (22.00)	1/2" NPT	0.02 (7.50)
C76708	3/4" F2159 x MIP	White	1.72 (43.60)	1.00 (25.40)	3/4" NPT	0.02 (9.90)
C76760	3/4" F2159 x MIP	Black	1.72 (43.60)	1.00 (25.40)	3/4" NPT	0.02 (9.90)
C76727	1" F2159 x MIP	White	1.86 (47.24)	1.30 (33.02)	1" NPT	0.04 (18.14)
C76761	1" F2159 x MIP	Black	1.86 (47.24)	1.30 (33.02)	1" NPT	0.04 (18.14)

F2159 Specified Dimensions	ID - in (mm)	OD - in (mm)
1/2" End Connection	.37(9.30)	.47(11.98)
3/4" End Connection	.55(13.85)	.67(16.96)
1" End Connection	.72(18.22)	.86(21.74)