



ONASSIS SHOWER SET INSTALLATION

BEFORE YOU BEGIN

We recommend consulting a professional if you are unfamiliar with installing plumbing fixtures. Signature Hardware accepts no liability for any damage to the plumbing, floor, walls, tub, or for personal injury during installation.

Observe all local plumbing and building codes.

Unpack and inspect the items for shipping damage. If any damage is found, contact our Customer Relations team at 1-855-715-1800.

GETTING STARTED

- Ensure that you have gathered all the required materials that are needed for the installation.
- For the following installation instructions, it is assumed that the wall has been opened and that the existing shower set has been removed.
- Before you begin, the main water supply to your home should be shut off.

TOOLS AND MATERIALS:



Plumbers
Tape



Tape Measure



Phillips
Screwdriver



Flathead
Screwdriver



Adjustable
Wrench



Drill

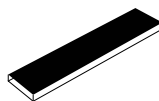

Wood Blocking



Soldering Kit
(for copper pipe)



1/2" Test Plug



Level



Pencil or
Marker



Hex Wrench



ONASSIS SHOWER SET INSTALLATION

Step 1: Valve Installation

1. To prepare for installation, wood blocking should be installed between the two studs where the valve will mount. The face of the wood blocking should rest 1 ¼" behind the face of the wall studs.

Important: Take into consideration the thickness of the finished wall materials, such as tile, when calculating measurements.

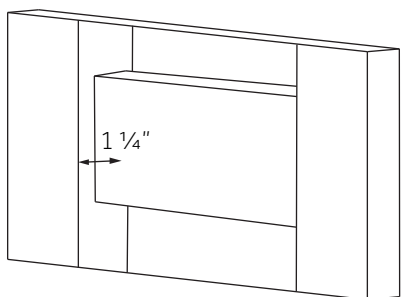

2. Secure the valve to the prepared wood blocking using the provided hardware. Ensure that the "cold" inlet is pointing to the right, and the "hot" inlet is pointing to the left. Use a level to ensure that the valve is straight and level.

Tip: Leave the protective sleeves on the valve stems until your finished wall is complete, and you are ready to install the trim pieces.

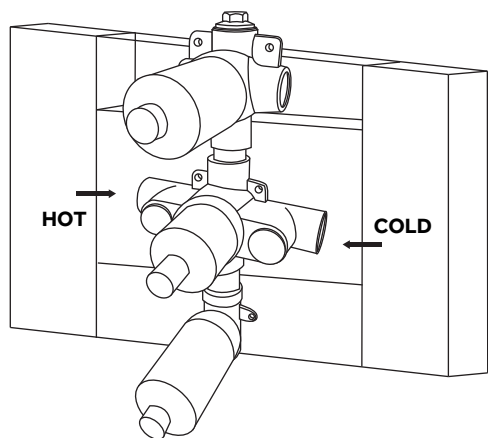

3. Route, assemble, and connect all in-wall piping as desired to and from the shower valve. Make all connections appropriately depending upon the type of pipe that is being used. For copper pipe, soldering will be required and should be completed by a licensed plumber. Apply plumber's tape to any threaded connections if applicable. Install any wood blocking that is necessary to support the piping and valve.

Important Notes:

A) The valve has a single function outlet on the bottom, and a 3-way diverter at the top.

B) The six body jets should be divided between two outlets (three jets per outlet) for maximum output pressure.

C) One shower function of your choosing can be routed to the bottom valve outlet, while the other three functions will route to the 3-way diverter.

D) The functions routed to the 3-way diverter will not be able to be used simultaneously, but each can be used in conjunction with the function routed to the bottom outlet.

E) Female fittings will need to be installed to make the connection for each of the six jets, the tub spout, the shower arm, and the and the slide bar. The fittings should sit no more than 1/4" behind the finished wall.

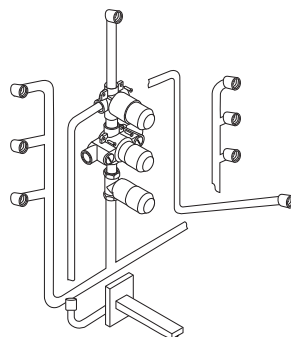



ONASSIS SHOWER SET INSTALLATION

4. Once all piping is routed and connections have been made, use a ½" test plug to perform a water pressure test. Turn on the main water supply to your home and water test the installed plumbing. Ensure that there are no leaks, then shut the water off. Remove the test plug.

Note: Water pressure testing should be performed by a licensed plumber if you are not familiar with this procedure.

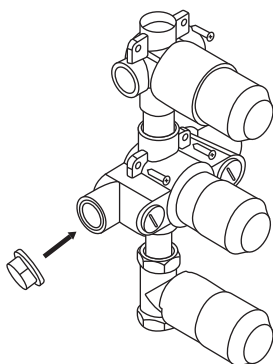

IMPORTANT: COMPLETE THE CONSTRUCTION OF YOUR WALL, INCLUDING ANY FINISHED WALL MATERIALS SUCH AS TILE, BEFORE PROCEEDING WITH THE REMAINDER OF THE INSTALLATION.

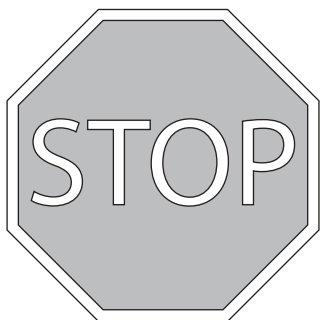

Step 2: Trim Installation

1. Once the finished wall is complete, remove the protective sleeves from the valve stems. If the test plug has not yet been removed, remove that as well.

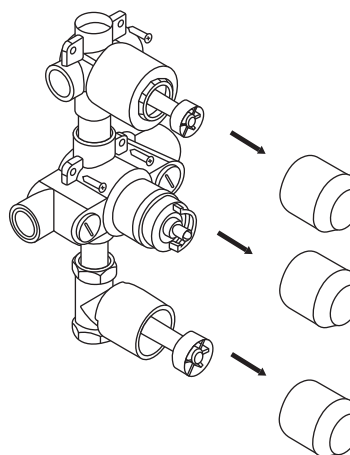

2. Slide the decorative back plate onto the valve. Ensure that the markings located above each opening on the back plate are facing up.

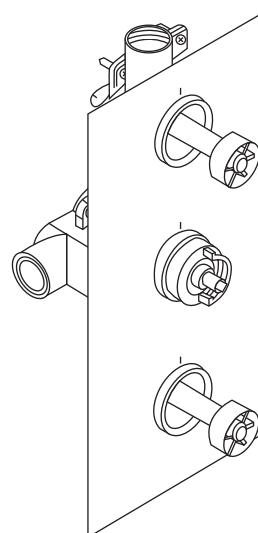



ONASSIS SHOWER SET INSTALLATION

3. Attach the 3-way diverter handle to the top stem by sliding it onto the spindle and tightening the set screw underneath, using the provided hex wrench. Repeat these steps to install the bottom single-function handle.

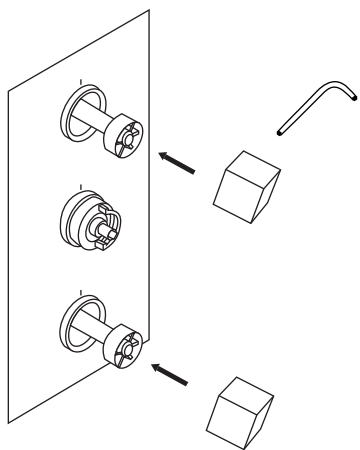

4. To install the temperature control handle, slide the handle onto the center valve stem. Attach the handle using the provided screw. Tighten with a Phillip's screwdriver, then insert the decorative screw cover into the handle to conceal the screw head.

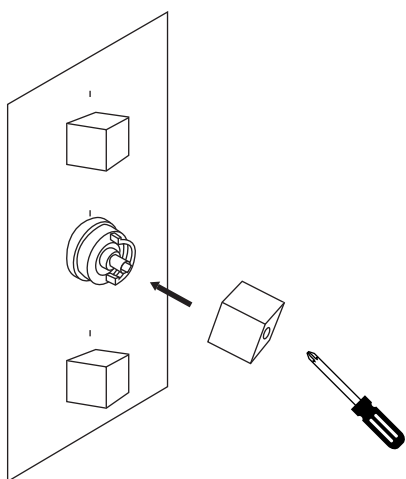

5. Install each of the body jets by threading them into their prepared female fittings. Be sure to use the decorative back plates to conceal the rough-ins. Apply thread sealant or plumber's tape to the threads before tightening.

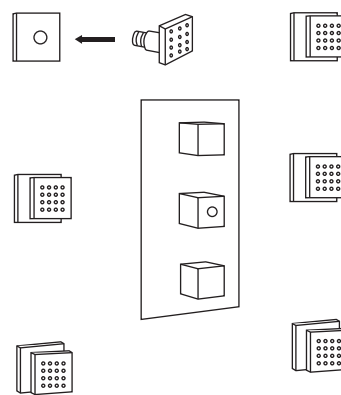

6. To install the tub spout, first remove the brass nipple from the spout by loosening the two set screws underneath.

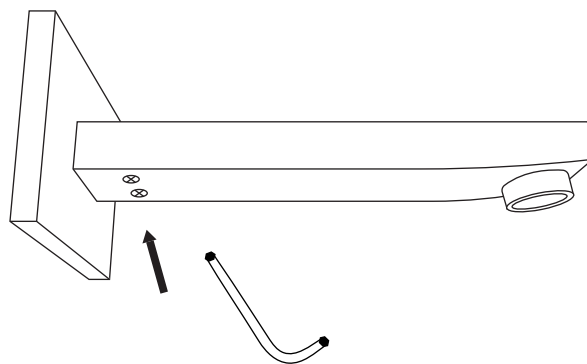



ONASSIS SHOWER SET INSTALLATION

7. Thread the brass nipple into its prepared female fitting. Apply plumber's tape or thread sealant to the threads before attaching. Tighten firmly using an adjustable wrench.

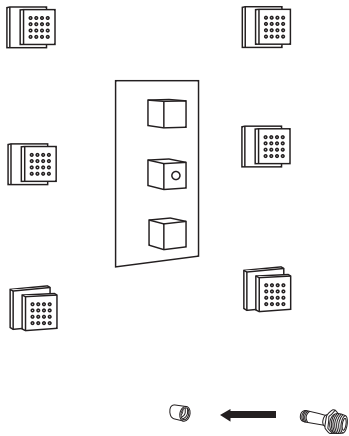

8. Push the spout onto the installed brass nipple. Once in place, tighten the two set screws underneath to secure.

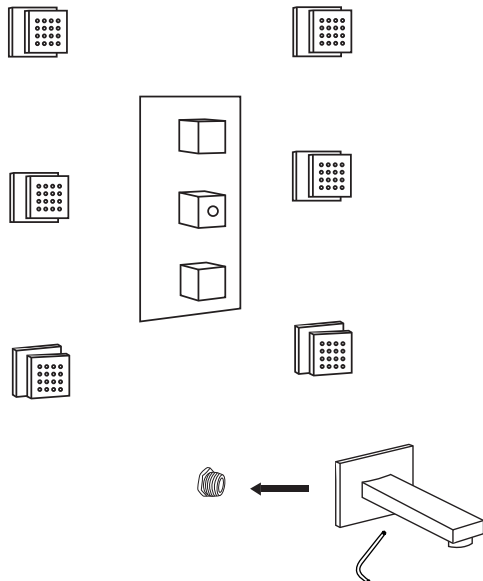

9. To install the shower arm, first remove the brass nipple from the arm by loosening the two set screws underneath.

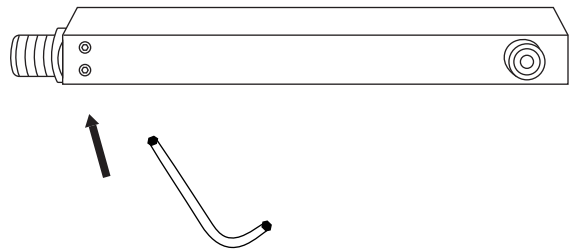

10. Thread the brass nipple into its prepared female fitting. Apply plumber's tape or thread sealant to the threads before attaching. Tighten firmly using an adjustable wrench.

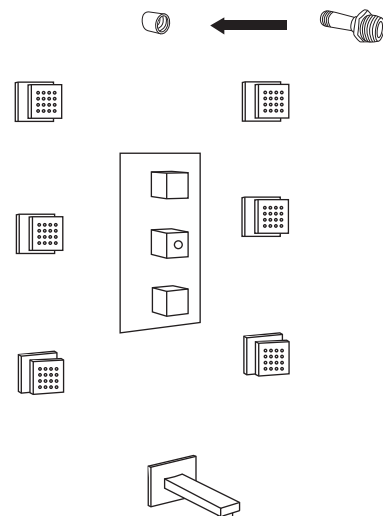

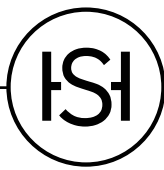

ONASSIS SHOWER SET INSTALLATION

11. Attach the decorative back plate to the shower arm using the provided screws. Tighten the screws using a small flathead screwdriver.

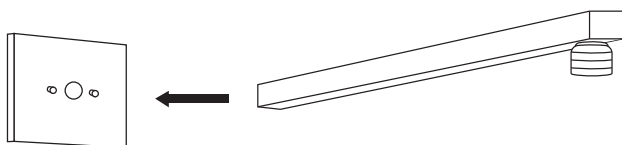

12. Push the shower arm onto the installed brass nipple. Once in place, tighten the two set screws underneath to secure.

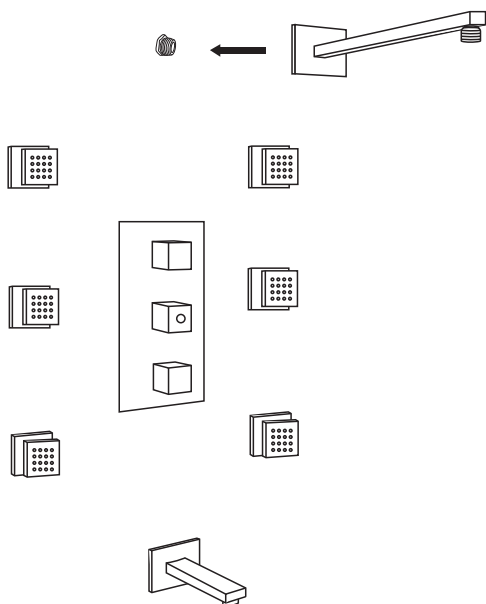

13. To install the hand shower's slide bar, first remove the water supply elbow from the slide bar by loosening the set screw underneath. Remove the brass nipple from the elbow by unthreading it.

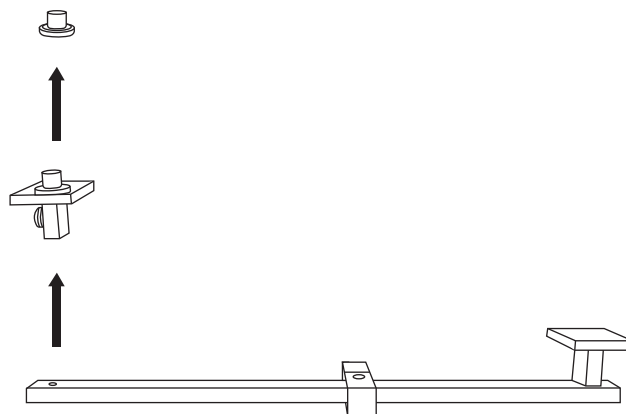

14. Thread the brass nipple into its prepared female fitting. Apply plumber's tape or thread sealant to the threads before attaching. Tighten firmly using an adjustable wrench.

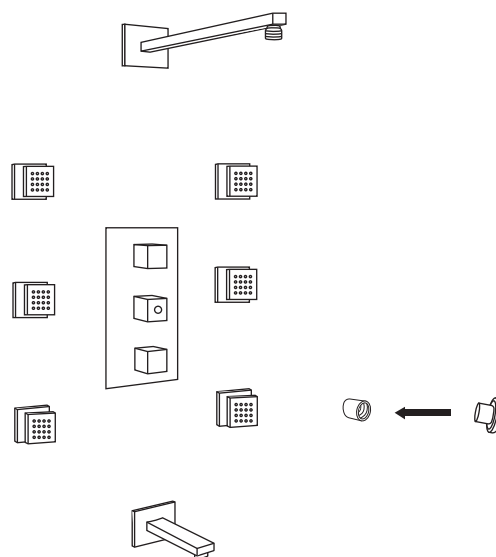



ONASSIS SHOWER SET INSTALLATION

15. Thread the water supply elbow onto the installed brass nipple until hand tight. Apply plumber's tape or thread sealant to the threads before attaching.

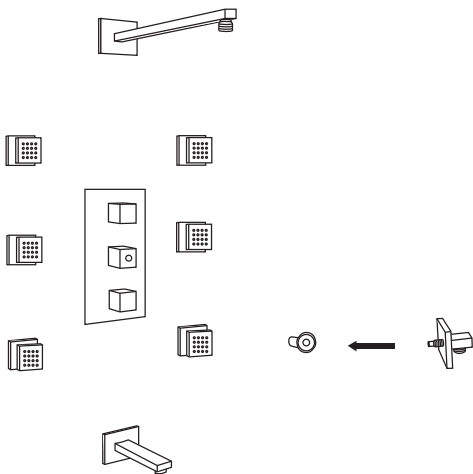

16. Install the slide bar's upper mounting bracket. The bracket will need to be installed 21 1/2" above the water supply elbow, from center-to-center. Use the provided anchors and screws to secure the bracket to the wall.

Tip: If drilling through tile, you must use a masonry drill bit and drill very carefully to avoid cracking the tile.

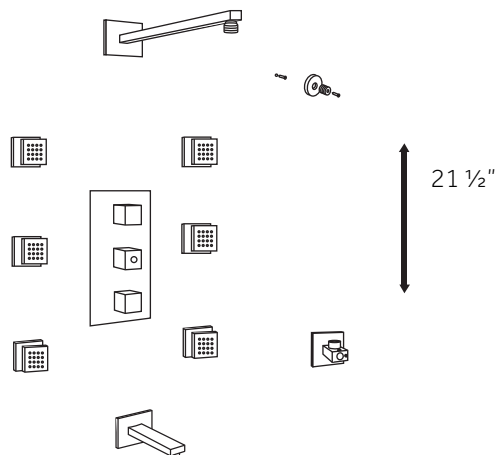

17. Attach the slide bar by hanging it onto the installed mounting bracket and water supply elbow. Secure the slide bar by tightening the set screws located on the bottom of the bracket and elbow.

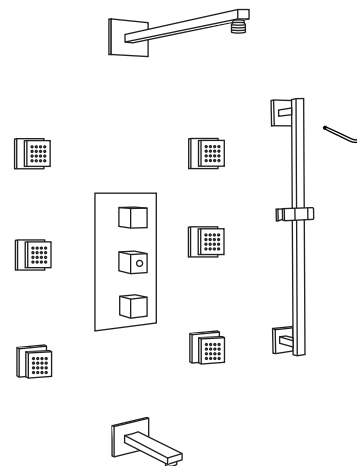

18. Attach the hand shower to the water supply elbow using the hand shower hose. Apply thread sealant or plumber's tape to the threads before tightening. Hand tighten the connections firmly.

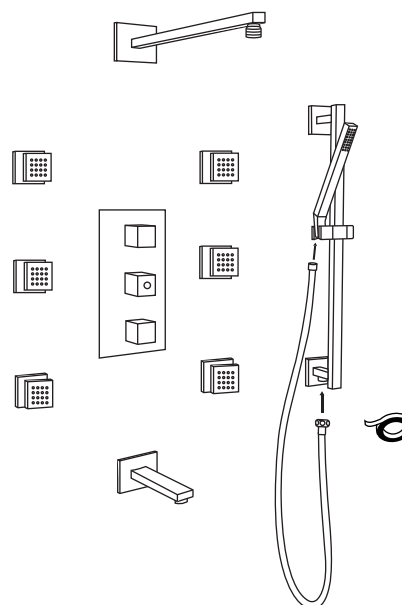



ONASSIS SHOWER SET INSTALLATION

19. Complete the installation by attaching the shower head to the installed shower arm. Apply thread sealant or plumber's tape to the threads before tightening.

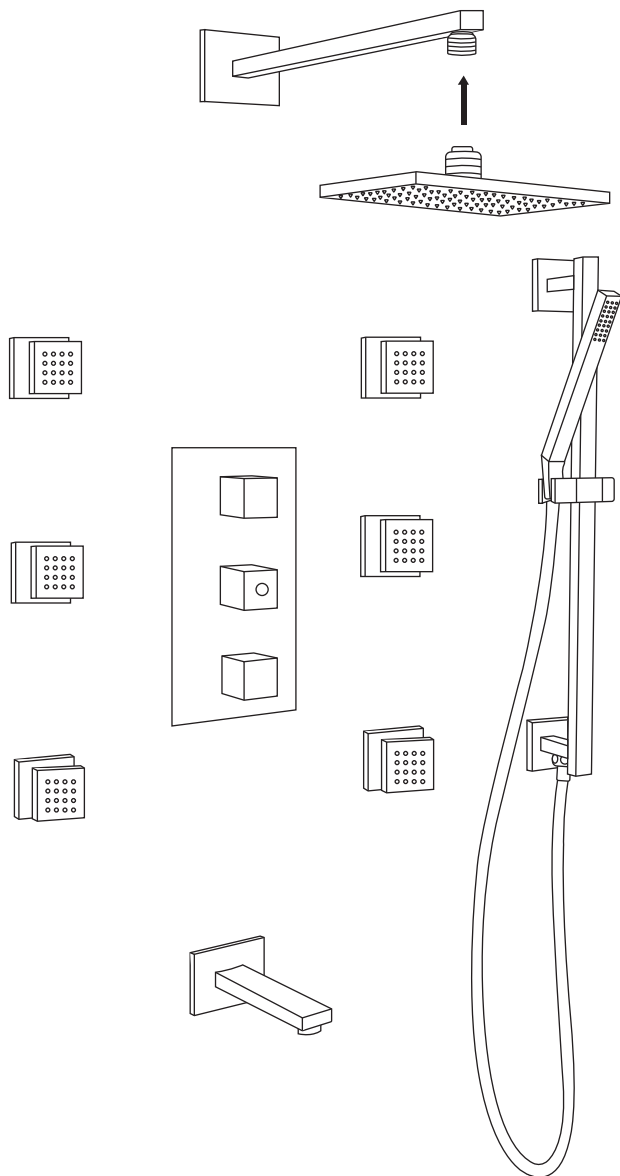

20. Turn the main water supply back on, and test the completed shower system. Ensure that there are no leaks and that all functions are working properly.

