

TRAVIS ALUMINUM "Y" FILTERS



50 GPM

Rating is with the lowest flow screen with no head loss.



200 PSI Max Working pressure.

3/4" NPT Flush Port

Parts on Page 4

1 1/4" NPT FILTER

SIZE	DESIGNATION
W/O Screen	21000
150 Mesh	21M150
120 Mesh	21M120
80 Mesh	21M80
40 Mesh	21020
1/32"	21032
3/64"	21050
1/16"	21062
3/32"	21093
1/8"	21125
3/16"	21188
1/4"	21250

80 GPM

Rating is with the lowest flow screen with no head loss.

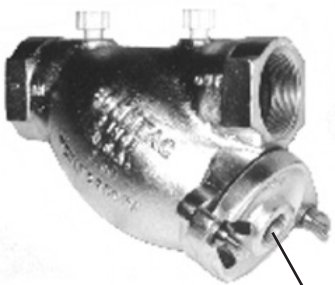

200 PSI Max Working pressure.

3/4" NPT Flush Port

Parts on Page 4

2" NPT FILTER

SIZE	DESIGNATION
W/O Screen	22000
150 Mesh	22M150
120 Mesh	22M120
80 Mesh	22M80
40 Mesh	22020
1/32"	22032
3/64"	22050
1/16"	22062
3/32"	22093
1/8"	22125
3/16"	22188
1/4"	22250

REPLACEMENT SCREENS FOR 1 1/4" & 2" FILTERS

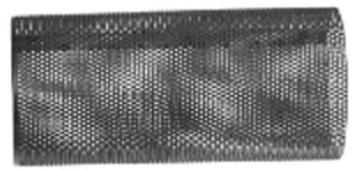

1 1/4" SCREENS		2" SCREENS
HOLE SIZE	DESIGNATION	DESIGNATION
150 Mesh	1M150	2M150
120 Mesh	1M120	2M120
80 Mesh	1M80	2M80
40 Mesh	1020	2020
1/32"	1032	2032
3/64"	1050	2050
1/16"	1062	2062
3/32"	1093	2093
1/8"	1125	2125
3/16"	1188	2188
1/4"	1250	2250

Product of: **TRAVIS PATTERN & FOUNDRY INC., SPOKANE, WASHINGTON**

Prices: SUBJECT TO CHANGE WITHOUT NOTICE

FAX: (509) 467-6465 - PHONE: (509) 466-3545

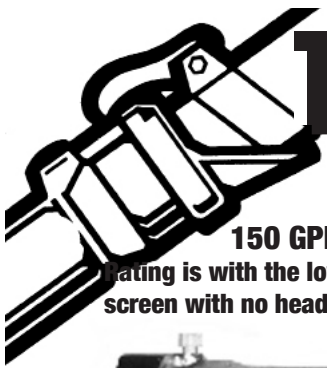

TRAVIS ALUMINUM "Y" FILTERS



150 GPM
Rating is with the lowest flow screen with no head loss.

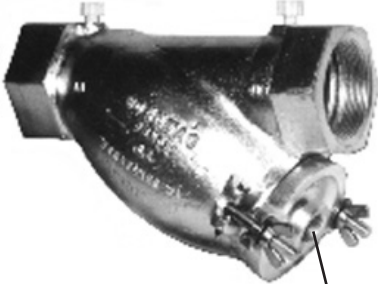

125 PSI Max
Working pressure.

1" NPT Flush Port
Parts on Page 4

3" NPT FILTER

SIZE	DESIGNATION
W/O Screen	23000
150 Mesh	23M150
120 Mesh	23M120
80 Mesh	23M80
40 Mesh	23020
1/32"	23032
3/64"	23050
1/16"	23062
3/32"	23093
1/8"	23125
3/16"	23188
1/4"	23250

280 GPM
Rating is with the lowest flow screen with no head loss.



150 PSI Max
Working pressure.

1 1/4" NPT Flush Port
Parts on Page 4

4" NPT FILTER

SIZE	DESIGNATION
W/O Screen	24000
150 Mesh	24M150
120 Mesh	24M120
80 Mesh	24M80
40 Mesh	24020
1/32"	24032
3/64"	24050
1/16"	24062
3/32"	24093
1/8"	24125
3/16"	24188
1/4"	24250

REPLACEMENT SCREENS FOR 3" & 4" FILTERS

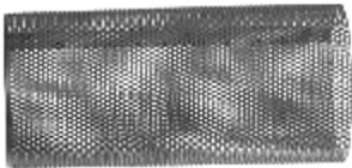

3" SCREENS		4" SCREENS
HOLE SIZE	DESIGNATION	DESIGNATION
150 Mesh	3M150	4M150
120 Mesh	3M120	4M120
80 Mesh	3M80	4M80
40 Mesh	3020	4020
1/32"	3032	4032
3/64"	3050	4050
1/16"	3062	4062
3/32"	3093	4093
1/8"	3125	4125
3/16"	3188	4188
1/4"	3250	4250

Product of: **TRAVIS PATTERN & FOUNDRY INC., SPOKANE, WASHINGTON**

Prices: SUBJECT TO CHANGE WITHOUT NOTICE

FAX: (509) 467-6465 - PHONE: (509) 466-3545

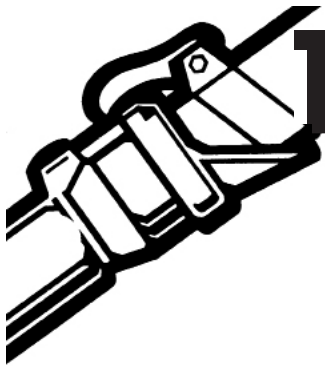

TRAVIS FILTER BODY DIMENSIONS



FOR 1 1/4" THRU 4"

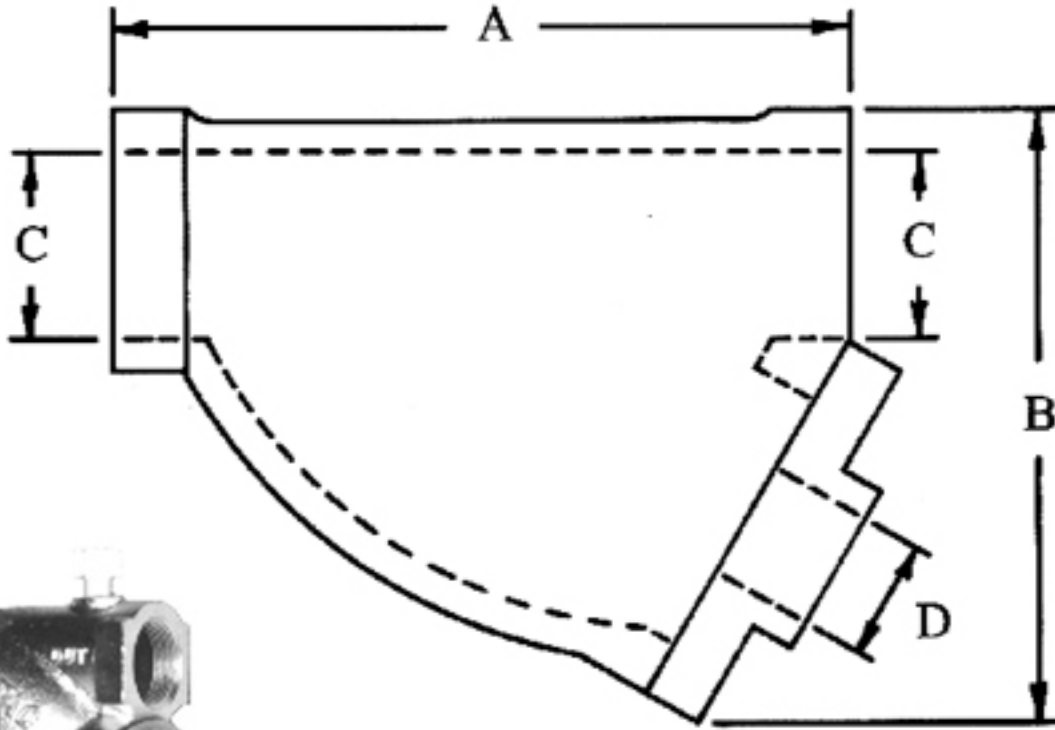

BODY DIMENSIONS FOR 1 1/4" THRU 4" ALUMINUM "Y" FILTERS

PIPE SIZE	A	B	C	D
N.P.T.				
1 1/4"	6 1/4"	5"	1 1/4" NPT	3/4" NPT
2"	8"	6 3/4"	2" NPT	3/4" NPT
3"	12 3/4"	8 3/4"	3" NPT	1" NPT
4"	17"	12"	4" NPT	1 1/4" NPT

Product of: **TRAVIS PATTERN & FOUNDRY INC., SPOKANE, WASHINGTON**

Prices: SUBJECT TO CHANGE WITHOUT NOTICE

FAX: (509) 467-6465 - PHONE: (509) 466-3545

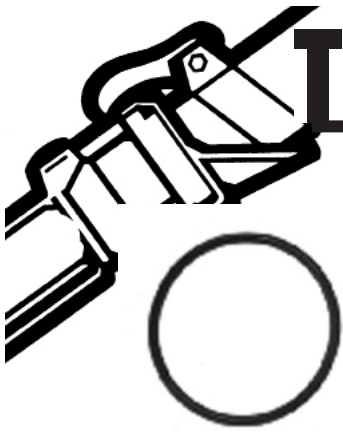

1 1/4" THRU 4"

		<i>SIZE</i>	<i>PART No.</i>
	O-RING	1 1/4"	2123
		2"	2223
		3"	2323
		4"	2423

		<i>SIZE</i>	<i>PART No.</i>
	STUD	1 1/4" & 2"	2138

		<i>SIZE</i>	<i>PART No.</i>
	SWING BOLT	3" & 4"	2340

		<i>SIZE</i>	<i>PART No.</i>
	WING NUT	1 1/4" & 2"	2130
		3" & 4"	2330

		<i>SIZE</i>	<i>PART No.</i>
	FLAT WASHER	1 1/4" & 2"	2112
		3" & 4"	2312

		<i>SIZE</i>	<i>PART No.</i>
	NUT & BOLT	3" & 4"	2335

		<i>SIZE</i>	<i>PART No.</i>
	CAP	1 1/4"	2110
		2"	2210
		3"	2310
		4"	2410

		<i>SIZE</i>	<i>PART No.</i>
	BODY	1 1/4"	2121
		2"	2221
		3"	2321
		4"	2421

Product of: **TRAVIS PATTERN & FOUNDRY INC., SPOKANE, WASHINGTON**

Prices: SUBJECT TO CHANGE WITHOUT NOTICE

FAX: (509) 467-6465 - PHONE: (509) 466-3545

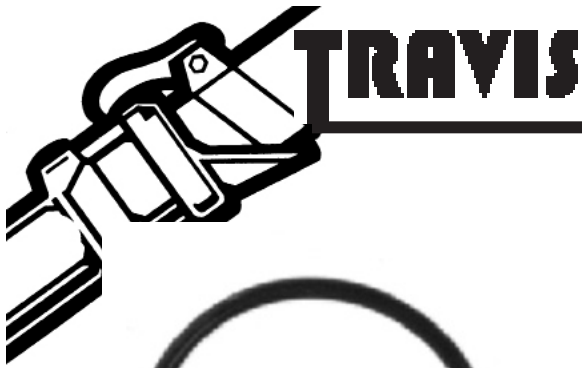

FILTER PARTS



VALUE PACKS & REPAIR KITS 1 1/4" THRU 4"



O-RING 10-PACK

<i>SIZE</i>	<i>PART No.</i>
1 1/4"	2123P
2"	2223P
3"	2323P
4"	2423P



STUD KITS

<i>SIZE</i>	<i>PART No.</i>
1 1/4" & 2"	2138K (SINGLE PACK)
1 1/4" & 2"	2138KP (10-PACK)

**Stud Kit Contains: 2 Wing Nuts
2 Flat Washers
2 Studs**



SWING BOLT KITS

<i>SIZE</i>	<i>PART No.</i>
3" & 4"	2340K (SINGLE PACK)
3" & 4"	2340KP (10-PACK)

**Swing Bolt Kit Contains: 2 Wing Nuts
2 Flat Washers
2 Swing Bolts
2 Nuts & Bolts**

Product of: **TRAVIS PATTERN & FOUNDRY INC., SPOKANE, WASHINGTON**

Prices: SUBJECT TO CHANGE WITHOUT NOTICE

FAX: (509) 467-6465 - PHONE: (509) 466-3545

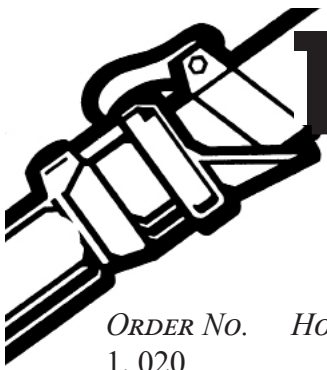

PERFORATED SCREEN MATERIAL 304 STAINLESS

ORDER NO.	HOLE DIA.	HOLE CTRS.	% OPEN AREA	HOLES P.S.I.	SHEET WIDTH	METAL GAUGE
1. 020	.020	043	20	624	3'	28
2. 032	1/32	1/16	23	295	3'	26
3. 050	3/64	5/64	33	132	3'	26
4. 062	1/16	3/32	41	131	3'	26
5. 093	3/32	5/32	33	47	3'	24
6. 125	1/8	3/16	40	33	3'	20
7. 188	3/16	1/4	51	18	3'	20
8. 250	1/4	3/8	40	8	3'	20

Please call for price and delivery

020=.020

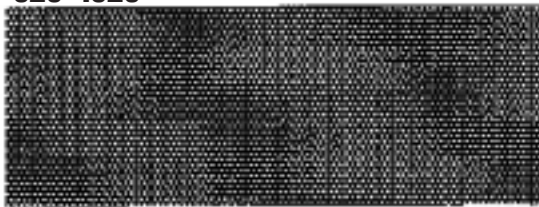

032=1/32

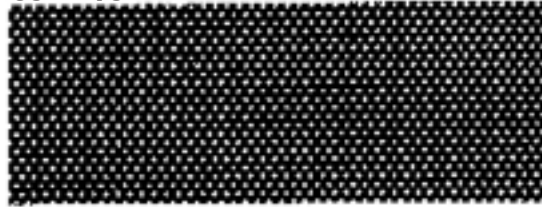

050=3/64

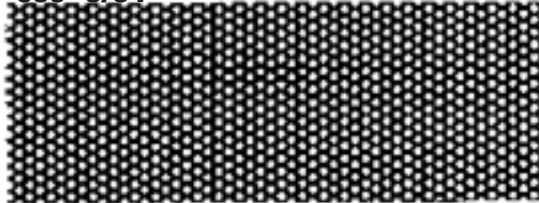

062=1/16

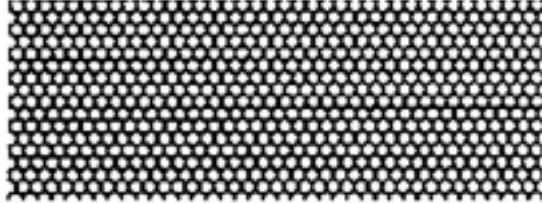

093=3/32

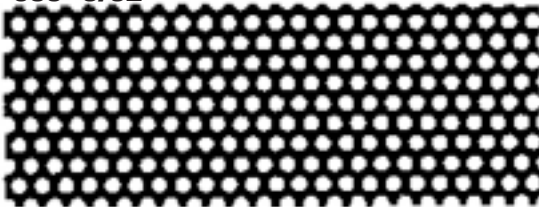

125=1/8

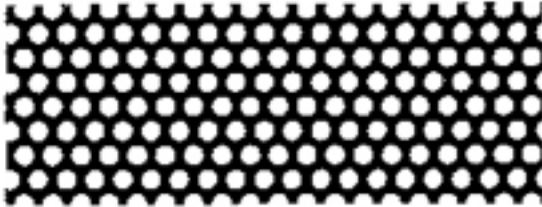

188=3/16

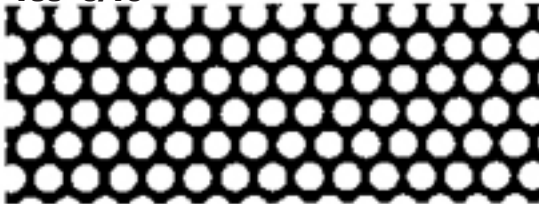

250=1/4

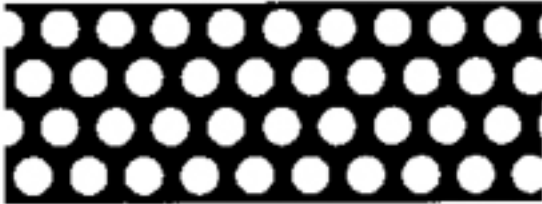

Product of: TRAVIS PATTERN & FOUNDRY INC., SPOKANE, WASHINGTON

Prices: SUBJECT TO CHANGE WITHOUT NOTICE

FAX: (509) 467-6465 - PHONE: (509) 466-3545

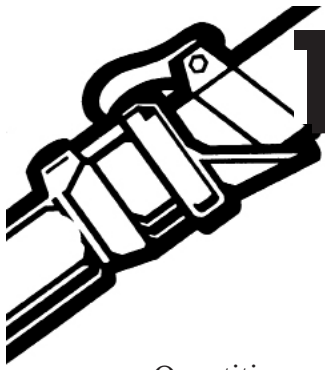

700 SERIES SOLID BASE

	<i>SIZE</i>	<i>PART No.</i>
Quantities more than 25 call for price.	1 1/4" NPT	700S
Shipping Wt. approximately 1 to 5 lbs.	1 1/2" NPT	701
	2" NPT	702

Parts on Page 8

800 SERIES SWIVEL BASE

	<i>SIZE</i>	<i>PART No.</i>
Quantities more than 25 call for price.	1 1/4" NPT	800
Shipping Wt. approximately 2 to 6 lbs.	1 1/2" NPT	801
	2" NPT	802

Parts on Page 8



Product of: **TRAVIS PATTERN & FOUNDRY INC., SPOKANE, WASHINGTON**

Prices: SUBJECT TO CHANGE WITHOUT NOTICE

FAX: (509) 467-6465 - PHONE: (509) 466-3545

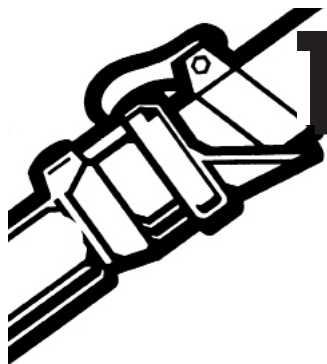

SOLID BASE PARTS

	<i>VALVE SIZE</i> 1 1/4"	<i>VALVE SIZE</i> 1 1/2"	<i>VALVE SIZE</i> 2"
	<i>PART NO.</i>	<i>PART NO.</i>	<i>PART NO.</i>
Hex Nut*	7002	7102	7102
Handwheel	7001S	7101S	7101S
Gland Nut**	7117	7117	7117
Packing	7119	7119	7119
Packing - 25 Pack	7119P	7119P	7119P
Ferrule**	7018	7118	7118
Bonnet	7020**	7120	7220
Stem-Complete	7016	7116	7216
Stem-Complete - 10 pk.	7016P	7116P	7216P
Body	7021	7121	7221
Seat Nut	7025	7125	7225

SWIVEL BASE PARTS

Base Nut	8024	8124	8224
O-Ring	8023	8123	8223
O-Ring - 25 Pack	8023P	8123P	8223P
Sleeve	8022	8122	8222



Rebuild Kit	7020K	7120K	7220K
Rebuild Kit - 10 Pack	7020KP	7120KP	7220KP

*Stainless Steel

**Solid Brass

Product of: **TRAVIS PATTERN & FOUNDRY INC., SPOKANE, WASHINGTON**

Prices: SUBJECT TO CHANGE WITHOUT NOTICE

FAX: (509) 467-6465 - PHONE: (509) 466-3545

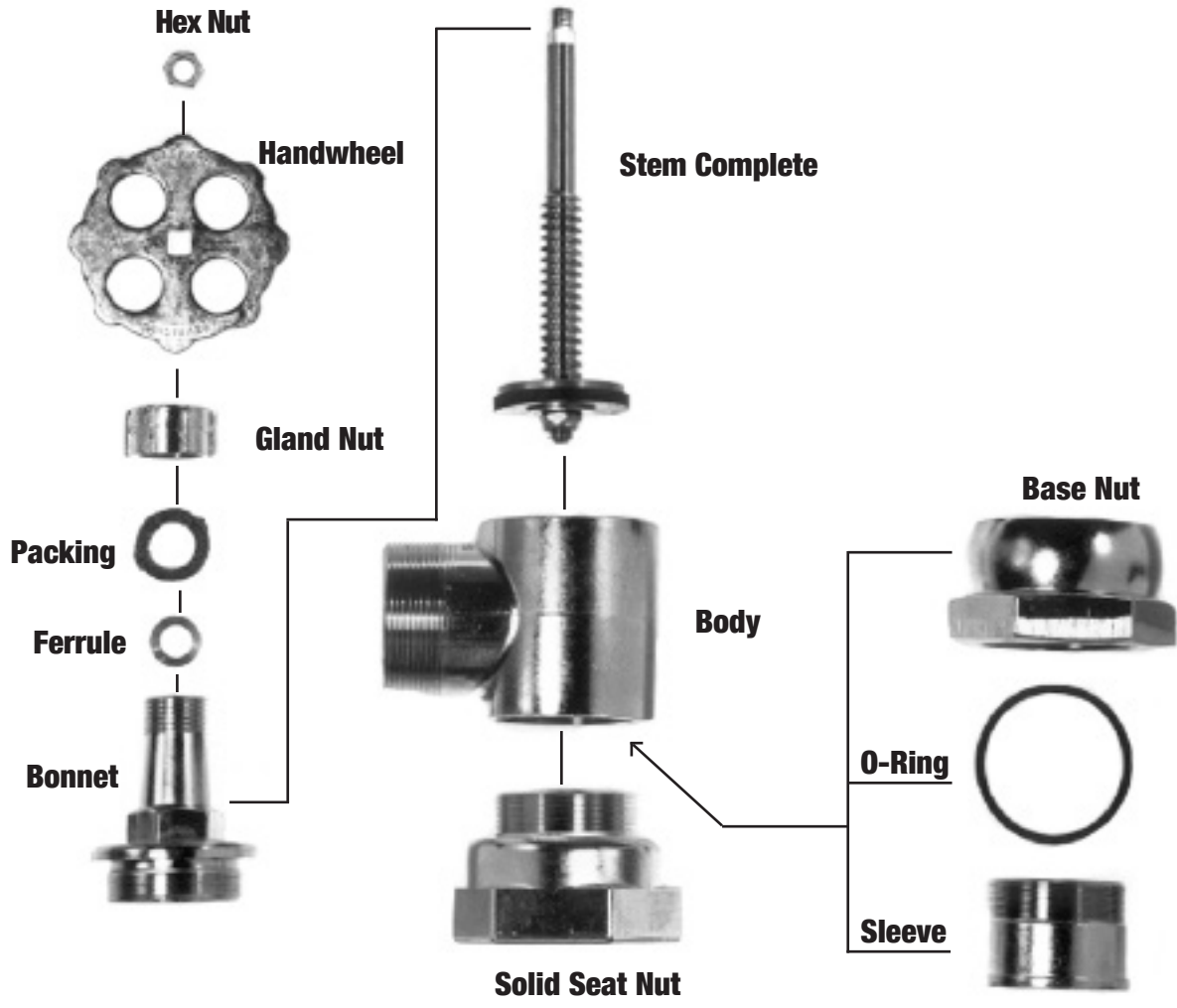
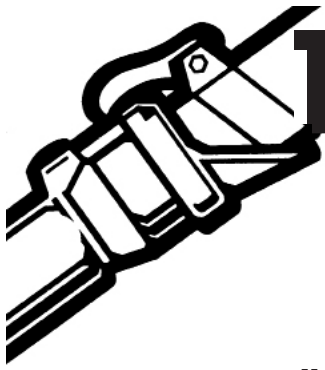

Product of: **TRAVIS PATTERN & FOUNDRY INC., SPOKANE, WASHINGTON**

Prices: SUBJECT TO CHANGE WITHOUT NOTICE

FAX: (509) 467-6465 - PHONE: (509) 466-3545

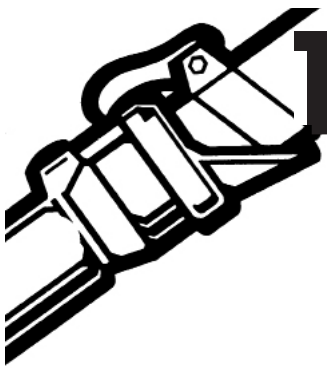

SOLID BASE PARTS

STEM PARTS	VALVE SIZE		
	1 1/4"	1 1/2"	2"
	PART NO.	PART NO.	PART NO.
Stem Only**	7005	7105	7205
Nylon Washer***	7012	7012	7012
Leaf Washer**	7006	7106	7206
Rubber Disc	7013	7113	7213
Rubber Disc - 25 Pack	7013P	7113P	7213P
Rubber Disc Kit	7013K	7113K	7213K
Rubber Disc Kit - 25 Pack 2 Washers, 1 Disc, 1 Nut	7013KP	7113KP	7213KP
Nylon Washer***	7112	7112	7112
Stem Lock Nut*	7114	7114	7114

*Stainless Steel

**Solid Brass

***Nylatron

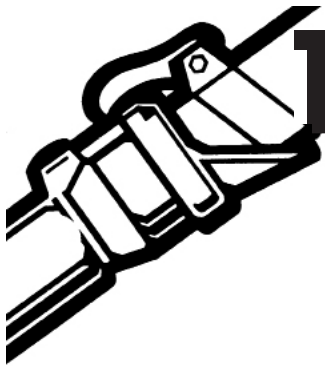

STEM



NYLON WASHER



LEAF WASHER



RUBBER DISC



NYLON WASHER

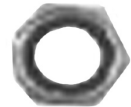

LOCK NUT

Product of: **TRAVIS PATTERN & FOUNDRY INC., SPOKANE, WASHINGTON**

Prices: SUBJECT TO CHANGE WITHOUT NOTICE

FAX: (509) 467-6465 - PHONE: (509) 466-3545

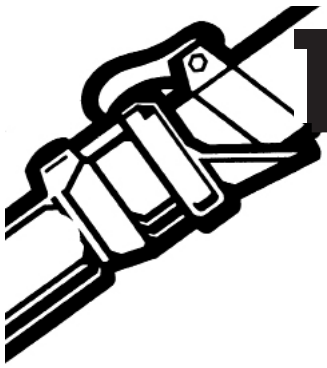

SUB SURFACE VALVE



<i>SIZE</i>	<i>PART No.</i>
2"	502

Quantities more than 25 call for price.

Shipping Wt. approximately 3 lbs.

Parts on Page 14

OPERATING ELBOWS - LATCH STYLE (OP-ELL)



<i>SIZE</i>	<i>PART No.</i>
2" x 2"	622L
2" x 3"	623L

Quantities more than 25 call for price.

Shipping Wt. approximately 5 lbs.

Parts on Page 16

Product of: **TRAVIS PATTERN & FOUNDRY INC., SPOKANE, WASHINGTON**

Prices: SUBJECT TO CHANGE WITHOUT NOTICE

FAX: (509) 467-6465 - PHONE: (509) 466-3545

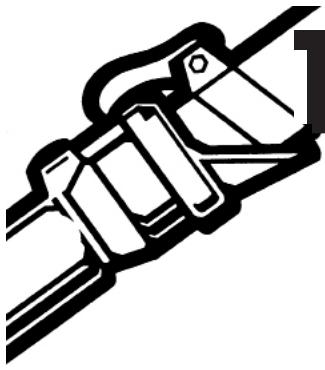

TRAVIS

SUB SURFACE VALVE PARTS

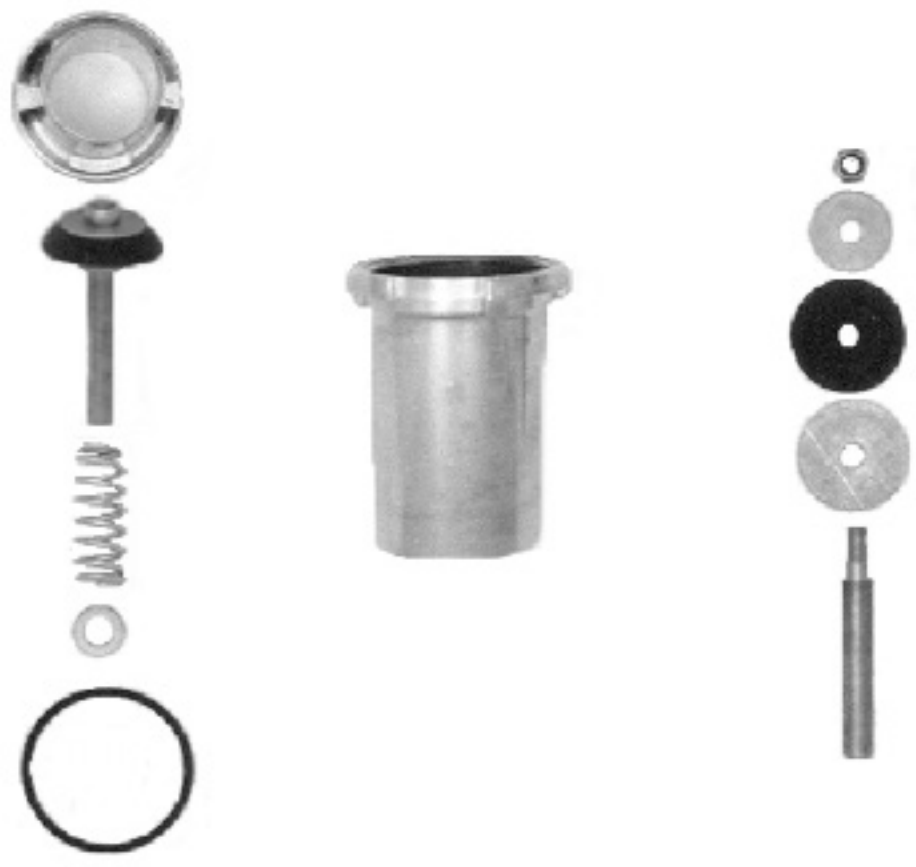

Product of: **TRAVIS PATTERN & FOUNDRY INC., SPOKANE, WASHINGTON**
Prices: SUBJECT TO CHANGE WITHOUT NOTICE
FAX: (509) 467-6465 - PHONE: (509) 466-3545

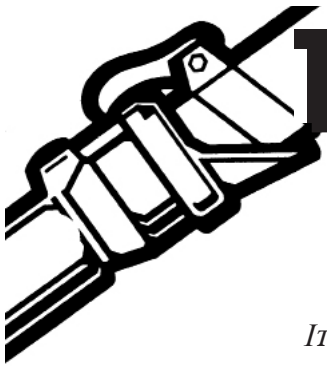

TRAVIS 2" SUB SURFACE VALVE PARTS



<i>ITEM</i>	<i>PART No.</i>
Cap	5210
Stem—Complete	5216
Spring*	5204
Spring Washer	5227
O-Ring	5223
Body	5221

STEM PARTS

Hex Lock Nut*	7114
Stem Washer*	5208
Rubber Disc w/Washer	5213ww
Stem—Only**	5205

*Stainless Steel

**Solid Brass

2" SUB SURFACE VALVE PARTS VALUE PACKS

<i>ITEM</i>	<i>PART No.</i>
Rubber Disc—25 Pack	5213P
O-Ring—25 Pack	5223P

Product of: **TRAVIS PATTERN & FOUNDRY INC., SPOKANE, WASHINGTON**

Prices: SUBJECT TO CHANGE WITHOUT NOTICE

FAX: (509) 467-6465 - PHONE: (509) 466-3545

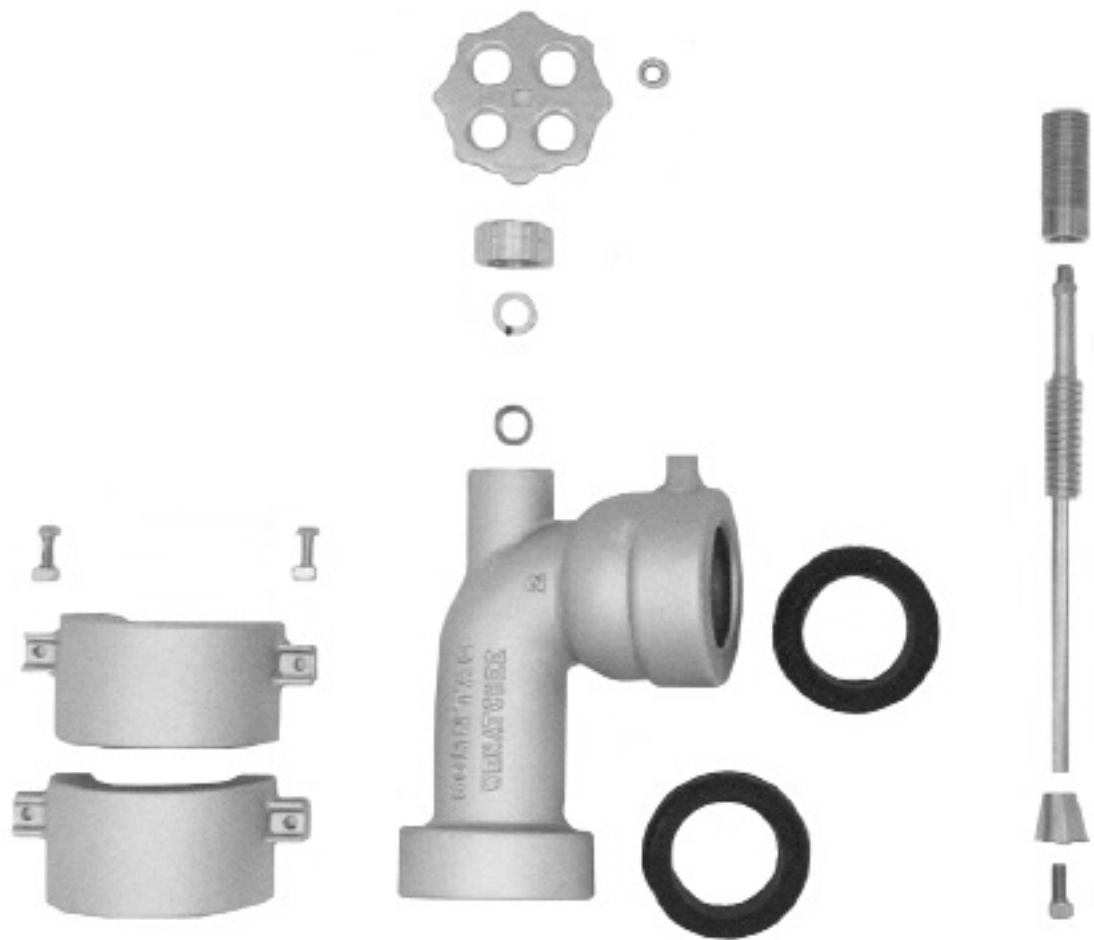
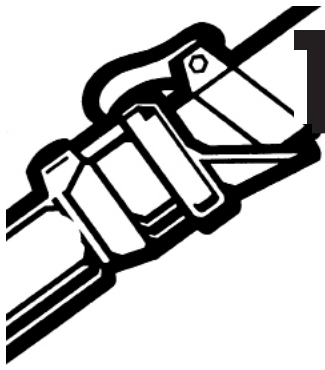

Product of: **TRAVIS PATTERN & FOUNDRY INC., SPOKANE, WASHINGTON**

Prices: SUBJECT TO CHANGE WITHOUT NOTICE

FAX: (509) 467-6465 - PHONE: (509) 466-3545

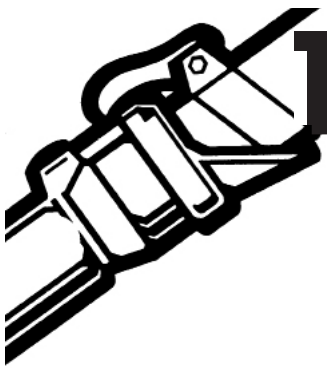

Size
2" x 2"

Size
2" x 3"

<i>DESCRIPTION</i>	<i>PART No.</i>	<i>PART No.</i>
Hex Nut - Handwheel	7102	7102
Handwheel	7101S	7101S
Gland Nut	7117	7117
Packing	7119	7119
Ferrule**	7118	7118
Body	6221	6321
Gasket	6242	6342
Square Nut & Screw	6235	6235
Clamp Half	6233	6233
Stem - Complete	6216	6216

STEM PARTS

<i>DESCRIPTION</i>	<i>PART No.</i>	<i>PART No.</i>
Nut Bushing**	6247	6247
Stem - Only**	6205	6205
Stem Cup**	6211	6211
Socket Cap Screw*	6209	6209

*Stainless Steel

**Solid Brass

Product of: **TRAVIS PATTERN & FOUNDRY INC., SPOKANE, WASHINGTON**

Prices: SUBJECT TO CHANGE WITHOUT NOTICE

FAX: (509) 467-6465 - PHONE: (509) 466-3545

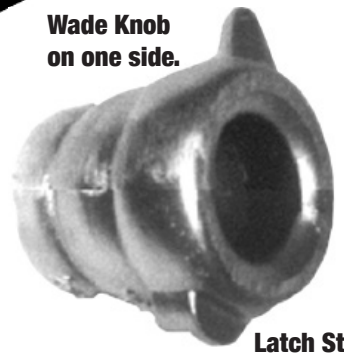
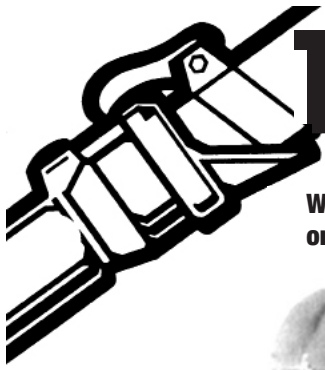

Wade Knob
on one side.

Latch Style
on one side.

THREAD ADAPTOR

SIZE	PART NO.
2" x 2"	101LW
2" x 3"	102LW



HOSE ADAPTOR

SIZE	PART NO.
2" x 1 1/4" Female	105
2" x 2" Male	106



BALL NUTS

SIZE	PART NO.
1 1/4" x 2"	108
1 1/2" x 2"	109
2" x 2"	110



BELL ADAPTOR

SIZE	PART NO.
2" x 2"	122L
2" x 3"	123L

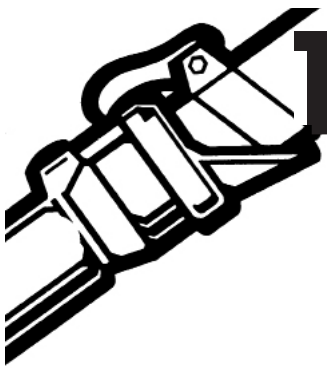

TRAVIS

ALUMINUM ADAPTOR PARTS



<i>DESCRIPTION</i>	<i>PART No.</i>	<i>SIZE</i>	<i>CALL FOR PRICING</i>
Adaptor O-Ring	1223S	2"	
	1323	3"	
Adaptor Clamp Half	1233	2"	
	1333	3"	
Square Nut & Screw	6235		
Gasket	6242	2"	
	6342	3"	
	6442	4"	
Hose Adaptor - Bell Only	10554	2" x 1 1/4" Female	
	10654	2" x 2" Male	
Bell Adaptor - Bell Only (Latch Style)	12254L	2" x 2"	
	12354L	2" x 3"	
	13354L	3" x 3"	
	13454L	3" x 4"	
(Wade Style)	12254W	2" x 2"	
	12354W	2" x 3"	

Parts 13354L, 13454L, 12254W and 12354W are limited to stock on hand.

Product of: **TRAVIS PATTERN & FOUNDRY INC., SPOKANE, WASHINGTON**

Prices: SUBJECT TO CHANGE WITHOUT NOTICE

FAX: (509) 467-6465 - PHONE: (509) 466-3545