

Schedule 80 PVC Technical Information
Schedule 80 Tank Adapters



NEW STYLE - TANK ADAPTER

Fipt x Fipt

Dimensions Also Applicable
to 8172E-XXX & 8172V-XXX

150 psi @ 73°F

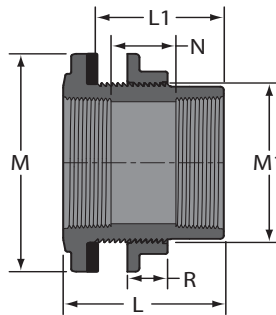

Part Number	Size	L	L1	M	M1	N	R	Approx. Wt. (Lbs.)
8172-002	1/4	2-1/2	1-13/16	1-1/2	1-1/16	1-5/16	1/2	.10
8172-003	3/8	2-1/2	1-13/16	1-5/8	1-3/16	1-3/8	1/2	.13
8172-005	1/2	2-15/16	2-3/16	2-1/16	1-3/16	1-13/32	5/8	.23
8172-007	3/4	2-15/16	2-15/32	2-1/4	1-5/8	1-1/2	5/8	.25
8172-010	1	3-5/16	2-13/16	2-5/8	1-31/32	1-1/4	5/8	.36
8172-012	1-1/4	3-13/32	2-27/32	3-3/32	2-5/16	1-17/32	5/8	.50
8172-015	1-1/2	3-19/32	3-1/16	3-19/32	2-21/32	1-11/16	5/8	.68
8172-020	2	4-1/8	3-1/4	4-7/8	3-1/4	2-3/16	3/4	1.34
8172-025	2-1/2	4-7/8	3-7/8	5-1/4	3-13/16	2-1/4	1	1.91
8172-030	3	5-1/2	4-1/2	6	4-9/16	2-11/16	1	2.80
8172-040	4	5	4	7-1/2	5-1/2	2	1-1/4	3.53
8172-060	6	5	4-3/16	9-7/8	7-31/32	1-5/32	1-1/4	5.90



NEW STYLE - TANK ADAPTER

Fipt x SR Fipt

Dimensions Also Applicable to 8172E-XXXSR & 8172V-XXXSR

150 psi @ 73°F

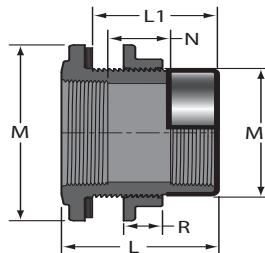

Part Number	Size	L	L1	M	M1	N	R	Approx. Wt. (Lbs.)
8172-002SR	1/4	2-1/2	1-7/8	1-9/16	1-1/16	1-5/16	1/2	.12
8172-003SR	3/8	2-1/2	1-13/16	1-5/8	1-3/16	1-3/8	1/2	.14
8172-005SR	1/2	2-15/16	2-3/16	2-1/16	1-7/32	1-13/32	5/8	.24
8172-007SR	3/4	2-15/16	2-15/32	2-1/4	1-5/8	1-3/16	5/8	.26
8172-010SR	1	3-15/16	2-19/32	2-5/8	1-31/32	1-1/4	5/8	.38
8172-012SR	1-1/4	3-13/32	2-27/32	3-3/32	2-5/16	1-17/32	5/8	.50
8172-015SR	1-1/2	3-5/8	2-13/16	3-5/8	2-11/16	1-3/4	5/8	.73