

BRIZO®

KITCHEN FAUCETS

- Artesso™ Kitchen Collection
- Two Handle Widespread Bridge

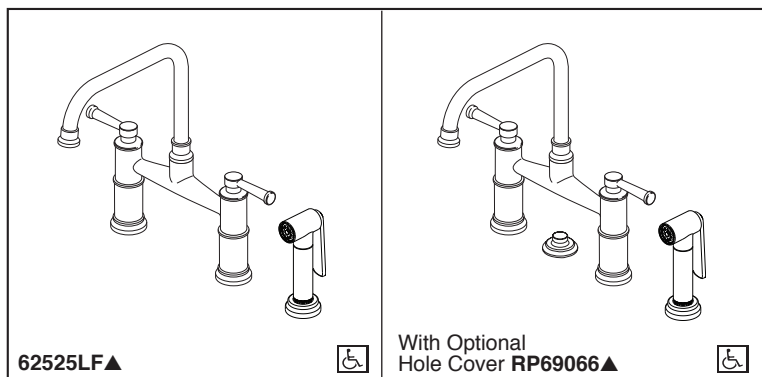

Submitted Model No.: _____

Specific Features: _____

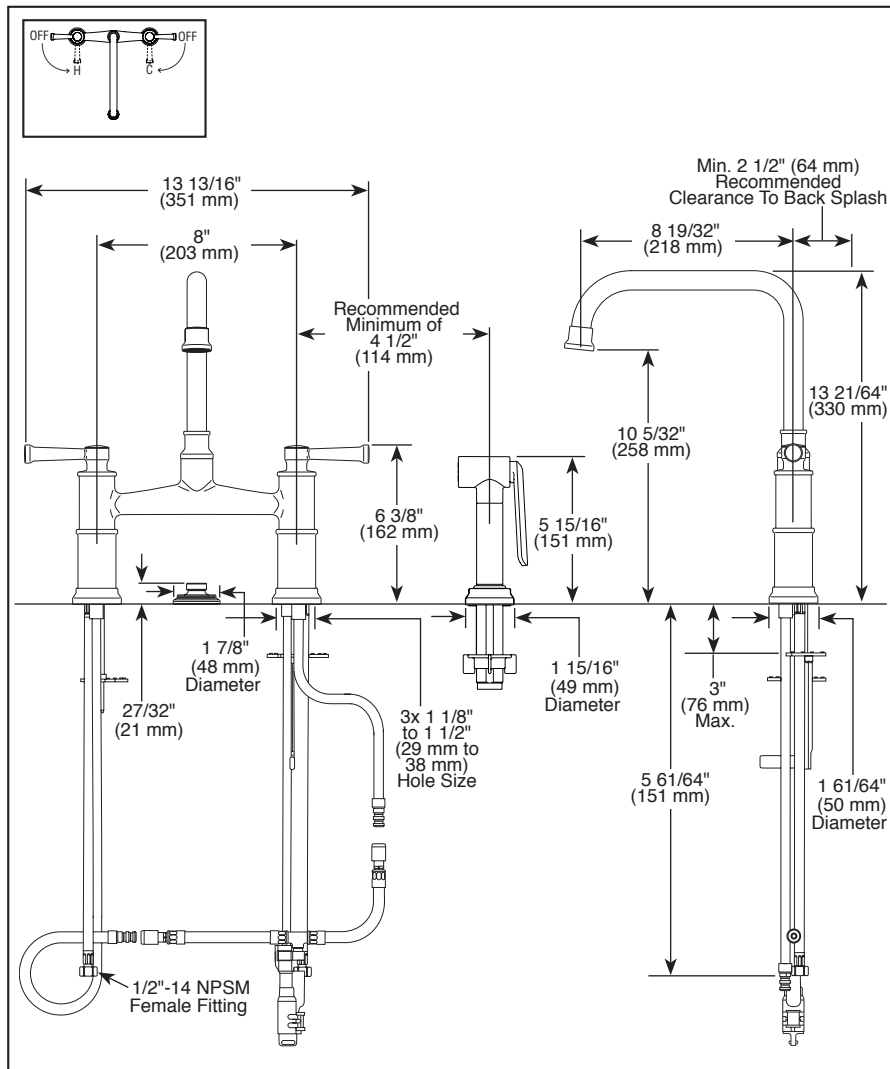

▲ Designate Proper Finish Suffix

STANDARD SPECIFICATIONS:

- Maximum 1.8 gpm @ 60 PSI, 6.8 L/Min @ 414 kPa
- Two, three, or four hole mount
- Ceramic cartridges
- Spout rotates 360°
- Solid brass with one-piece cast brass waterway
- Twin lever handles

WARRANTY

- Lifetime limited warranty on parts (other than electronic parts and batteries) and finishes: or, for commercial users, for 5 years from date of purchase.
- 5 year limited warranty on electronic parts (other than batteries); or, for commercial users, for 1 year from the date of purchase. No warranty is provided on batteries.

COMPLIES WITH:

- ASME A112.18.1 / CSA B125.1
- ♿ Indicates compliance to ICC/ANSI A117.1
- Verified compliant with .25% weighted average Pb content regulations.