

SPECIFICATIONS

FIGURE 751 UL FM VALVES



150# UL FM GATE VALVE

FEATURES

- 300 psi non-shock cold working pressure
- 32°-175°F temperature range
- Ductile iron body and bonnet
- 304 stainless steel stem
- EPDM encapsulated ductile iron disc
- Outside yoke and stem
- UL Listed/FM approved
- Pre-tapped and plugged for bypass
- Pre-grooved stem for tamper switch

PRODUCT SPECIFICATIONS

Standards

- Design Standard: AWWA C515
- Connection Ends: Flange to ASME B16.42 CL 150
- Coating: Fusion Bonded Epoxy Coating in accordance with ANSI/AWWA C550
- Certified to NSF/ANSI/CAN 61
- Certified to NSF/ANSI 372
- Lead-Free

CV FLOW COEFFICIENT

| Size | Cv (FULL OPEN) |
|------|----------------|
| 2.5" | 350 |
| 3.0" | 660 |
| 4" | 1000 |
| 6" | 2300 |
| 8" | 4115 |
| 10" | 6500 |



PRESSURE/TEMPERATURE

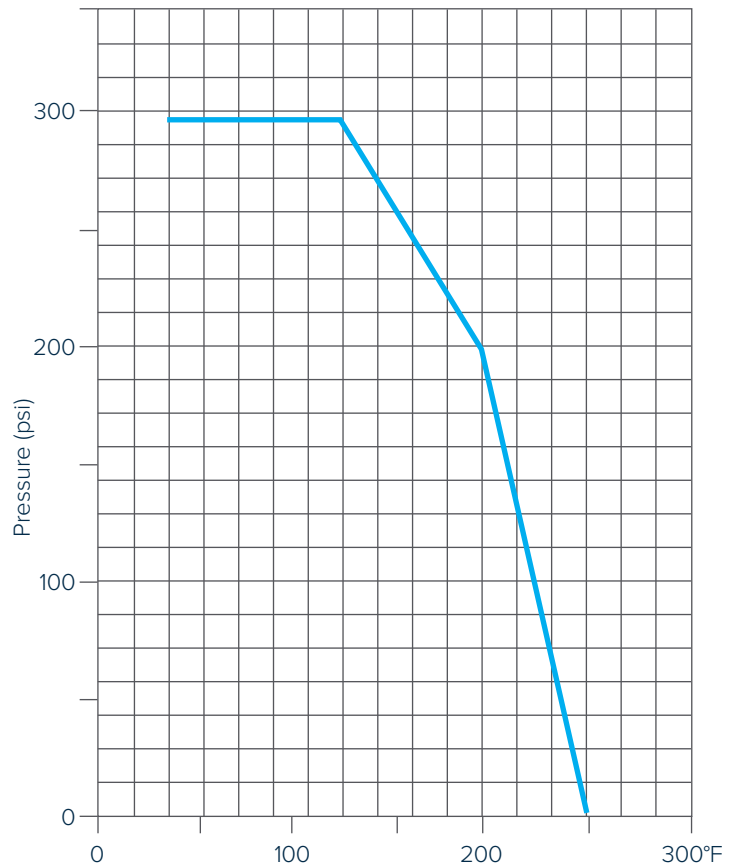

PARTS BREAKDOWN

FIGURE 751
UL FM VALVES



150# UL FM GATE VALVE

PARTS DIAGRAM

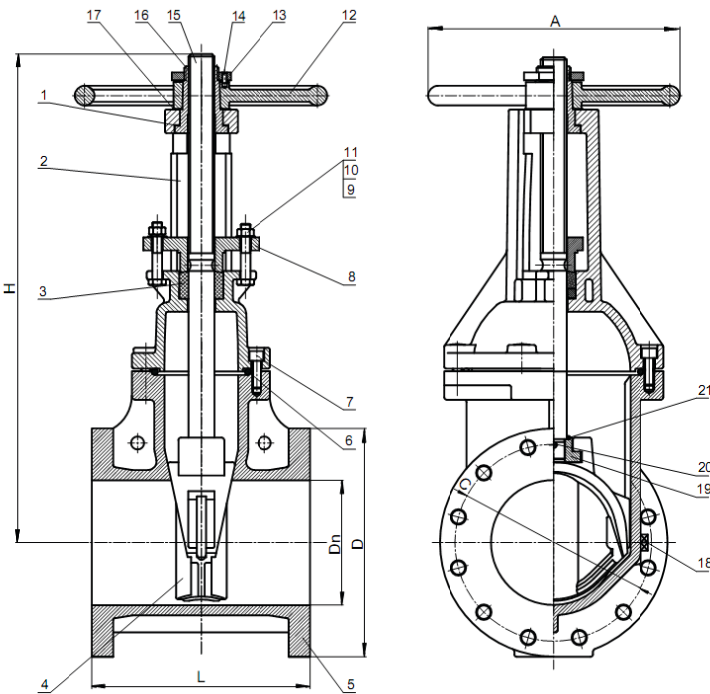

PART MATERIALS

| Ref # | Description | Material |
|-------|----------------------|--|
| 1 | Washer | Bronze C95400 |
| 2 | Yoke | Ductile Iron ASTM A536 |
| 3 | Stem Packing | Graphite |
| 4 | Disc and Encapsulate | Ductile Iron ASTM A536 + EPDM ASTM D2000 |
| 5 | Body | Ductile Iron ASTM A536 |
| 6 | Bonnet O-ring | EPDM ASTM D2000 |
| 7 | Bonnet Bolt | Carbon Steel Black |
| 8 | Gland | Ductile Iron ASTM A536 |
| 9 | Gland Nut | Stainless Steel SS304 |
| 10 | Flat Washer | Stainless Steel SS304 |
| 11 | Gland Bolt | Stainless Steel SS304 |
| 12 | Handwheel | Ductile Iron ASTM A536 |
| 13 | Lock Nut | Bronze C95400 |
| 14 | Locating Screw | Stainless Steel SS304 |
| 15 | Stem | Stainless Steel SS304 |
| 16 | Cap Nut | Bronze C95400 |
| 17 | Washers | Bronze C95400 |
| 18 | Plug | Stainless Steel SS304 |
| 19 | Stem Nut | Stainless Steel SS304 |
| 20 | Pin | Stainless Steel SS304 |
| 21 | O-ring | EPDM ASTM D2000 |

DIMENSIONS

| Item No. | Size | Dimensions (IN) | | | | | | |
|----------|------|-----------------|-------|-----------------|-------|---------|-------|-------------------------|
| | | Dn | L | D _{KD} | zC | n-d | H | Diameter of Handwheel A |
| FNW751L | 2.5" | 2.5 | 7.48 | 7.09 | 5.51 | 4-Φ0.75 | 14.57 | 7.24 |
| FNW751M | 3" | 3.00 | 7.99 | 7.48 | 5.98 | 4-Φ0.75 | 16.54 | 10 |
| FNW751P | 4" | 4.00 | 9.02 | 9.05 | 7.52 | 8-Φ0.75 | 17.60 | 10 |
| FNW751U | 6" | 6.00 | 10.51 | 11.02 | 9.49 | 8-Φ0.87 | 23.90 | 12.2 |
| FNW751X | 8" | 8.00 | 11.50 | 13.58 | 11.77 | 8-Φ0.87 | 29.69 | 14 |
| FNW75110 | 10" | 10.00 | 12.99 | 15.95 | 14.25 | 8-Φ1.00 | 35.04 | 17.5 |