

Specifications

PFB14CRS3/PFB14CLS3 – Rampart Series

Enameled Steel

Soaking Tubs 60" x 30"



Product Features

- Chemically Bonded enameled steel bathtub
- 60" x 30" x 14-1/4"
- 60" x 30" x 16-5/8" AFR
- High-density molded backing deadens noise, retains heat and resists impact damage
- Full length tile flange
- Standard and above floor rough-in
- High gloss, stain resistant porcelain finish
- 35 degree lumbar support
- Non-skid bottom surface
- Integral molded leveling feet
- Available in white, bone and biscuit
- Weight: 72 lbs / 76 lbs (AFR)



PFB14CRS3WH

Model Numbers

PFB14CRS3*	60" x 30" x 14-1/4" bathtub - RH
PFB14CLS3*	60" x 30" x 14-5/8" bathtub - LH
PFB16CRS3	60" x 30" x 16-5/8" bathtub - RH above floor RI
PFB16CLS3	60" x 30" x 16-5/8" bathtub - LH above floor RI

* = Complies with ADA

Warranty and Codes

These products come complete with installation, operating, care and maintenance instructions. PROFLO S3 Series Enameled Steel baths carry a limited lifetime warranty. These products meet or exceed ASME/ANSI A112.19.4M.



FERGUSON.COM/PROFLO

Specifications

PFB14CRS3/PFB14CLS3 – Rampart Series

Enameled Steel

Soaking Tubs 60" x 30"



Product Specification

PFB14CRS3/PFB14CLS3

Standard rough-in

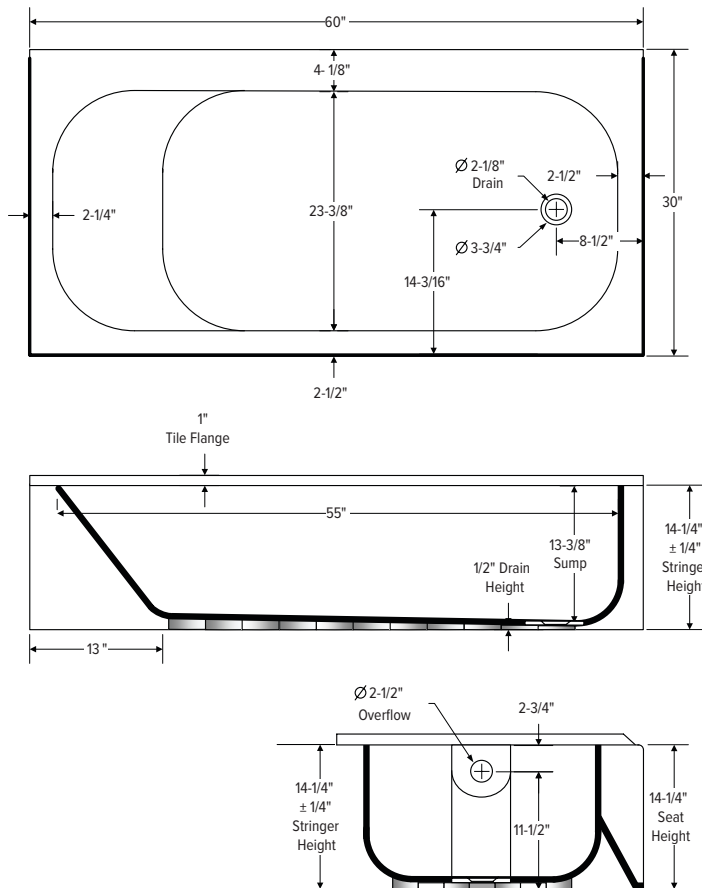

Product Specification

PFB16CRS3/PFB16CLS3

Above floor rough-in

