

FIGURE X531 BRASS BODY CHECK VALVES



LOW-LEAD COMPLIANT PUSH-FIT VALVE FOR WATER

FEATURES

- 200 PSI max. working pressure
- Push-fit ends
- For copper, CPVC, PEX* and PE-RT pipe
- NSF/ANSI 61 & NSF/ANSI 372 certified (IAPMO)
- cUPC certified
- ASSE 1061
- Max temperature: 200°F (water)



* Not for use with PEX-AL-PEX or PEX tubing with an oxygen barrier

NOT FOR USE AT OR BELOW GROUND LEVEL

The FNW X531 Push-Fit check valve saves valuable installation time. Its ability to connect to multiple pipe types reduces inventory levels by decreasing the number of different valves and fittings that would normally need to be stocked. Whether it's copper, CPVC, PEX* or PE-RT, X531 provides for an easy install.



Low-Lead Compliant: Referring to laws defining "Lead Free" as wetted surface of pipe, fittings and fixtures in potable water systems that have a weighted average lead content $\leq 0.25\%$ per the Safe Drinking Water Act (Sec. 1417) amended 1-4-2011 as well as other state regulations.



COPPER



CPVC

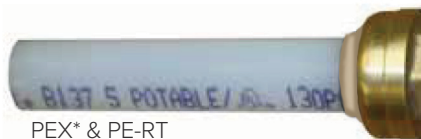

PEX* & PE-RT



Removal Tool Included

FIGURE NUMBER MATRIX

FNW X531 Size

SIZE CODE

1/2 = D

3/4 = F

FIGURE X531 BRASS BODY CHECK VALVES



LOW-LEAD COMPLIANT PUSH-FIT VALVE FOR WATER

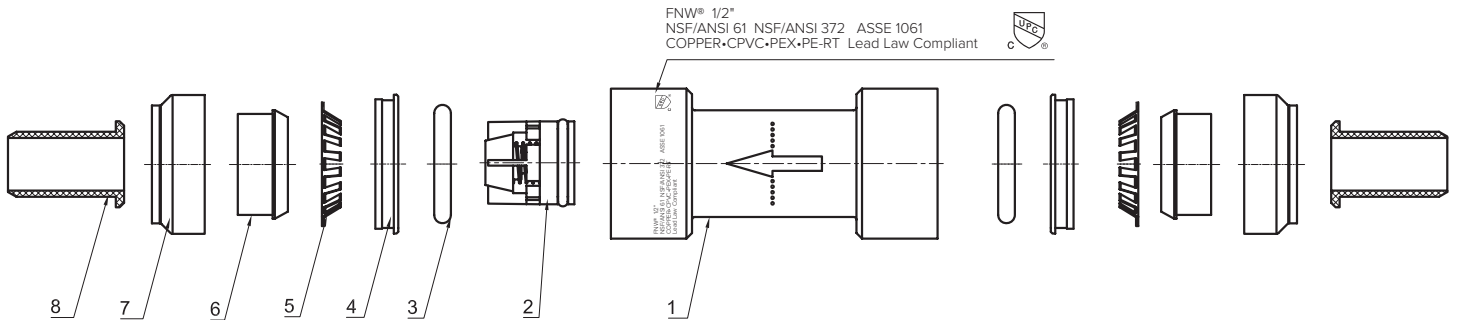

FLOW CAPACITY

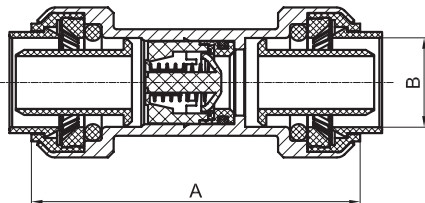
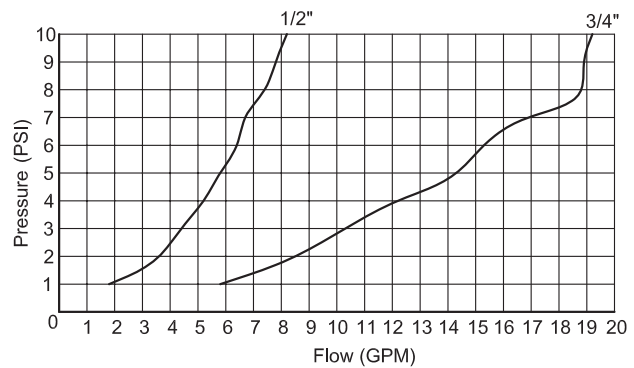

STANDARD MATERIALS

Ref #	Description	Material	Qty
1	BODY	LEAD FREE BRASS (C46500)	1
2	VALVE CORE ASSEMBLY	(POM+S304+EPDM)	1
3	O-RING	EPDM	2
4	LOCK RING	POM	2
5	GRIPPER RING	S304	2
6	RELEASER	POM	2
7	PROTECTOR	POM	2
8	TUBE SUPPORT	POM	2

DIMENSIONS

Size	Dimensions (In)		Lbs
	A	B	Weight
1/2"	2.35	0.63	0.17
3/4"	3.01	0.88	0.34