

SUBMITTAL SHEET

JOB NAME	ITEM TAG
JOB LOCATION	PART NUMBER
CONTRACTOR	DATE
ENGINEER APPROVAL	DATE

NO HUB COUPLINGS

Standard No Hub

Designed to connect cast iron no-hub soil pipe and no-hub fittings in above-ground and underground residential and commercial applications. Proper bracing and backfilling practices must be followed.

Easily installed in new-construction or repair applications, eliminating the need for labor-intensive hub-and-spigot caulking.

All heavy-pattern worm-gear band clamps are attached to the shield with a rivet through an elongated slot, which not only stabilizes the clamps during the tightening sequence, but also allows the clamps and shield to move independently, thus preventing uneven clamping force, binding and shield-crimping.

Durable 28-gauge stainless steel shields are corrugated, permitting even gasket compression and reduced buckling at the overlap.

Full-pattern Neoprene rubber gasket is tear-resistant and internally beaded, to ensure a positive seal and mechanical joint, with greater pull-out resistance.

Note: All 5/16" hex-head worm-gear screws must be incrementally tightened to 60 in-lb with a calibrated torque wrench to assure even compression and sealing.

Working Pressure, Non Shock (PSI)

Drain-Waste-Vent (DWV), gravity flow: < 10 psi

MATERIAL SPECIFICATION

PART	MATERIAL	SPECIFICATION
1 Shield	Stainless steel	AISI 300
2 Band clamp	Stainless steel	AISI 300
3 Worm gear screw -- 5/16" hex-head	Stainless steel	AISI 300
4 Worm gear cover	Stainless steel	AISI 300
5 Gasket	Neoprene rubber	ASTM C564-2014

DIMENSIONS

Size	# of band clamps	A	B	C	D	E	F
1-1/2"	2	2.12	0.55	8.31	2.13	1.47	0.12
2"	2	2.12	0.55	10.47	2.53	1.97	0.12
3"	2	2.12	0.55	13.50	3.53	2.97	0.12
4"	2	2.12	0.55	16.61	4.53	3.97	0.12
5"	4	3.00	0.55	20.51	5.53	4.97	0.12
6"	4	3.00	0.55	23.07	6.53	5.97	0.12
8"	4	4.00	0.55	29.76	8.53	7.97	0.12
10"	4	4.00	0.55	36.26	10.54	9.97	0.12
12"	6	5.50	0.55	42.95	12.62	11.97	0.12
15"	6	5.50	0.55	53.94	15.84	14.97	0.12

Certifications/Listing:

Third party certified.

ASTM C1277: Standard specification for shielded couplings joining hubless cast iron and soil pipe and fittings.

ASTM C1460: Standard specification for shielded transition couplings for use with dissimilar DWV pipe and fittings above ground.

CSA B602: Mechanical couplings for drain, waste and vent pipe and sewer pipe.

CISPI 310: Specification for coupling for use in connection with hubless cast iron, soil pipe and fittings for sanitary and storm, waste, and vent piping applications.



Pictured:
Standard No Hub

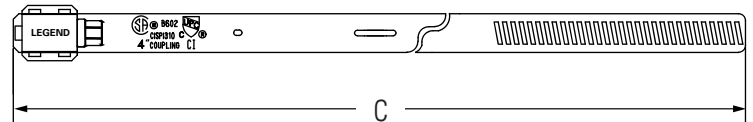

Pictured:
No hub band clamp detail

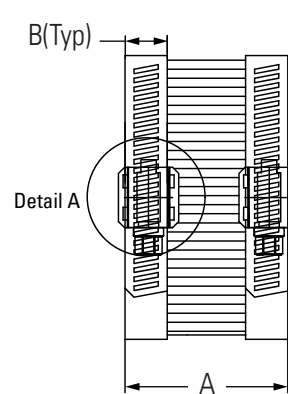

Pictured:
4" No hub detail

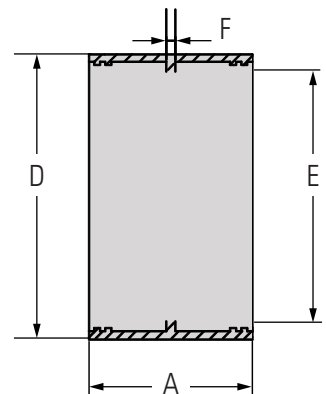

Pictured:
No hub gasket, cut-away view



Detail A
Worm-gear cover