

If your fill valve appears like the one below, replace with **1468016**

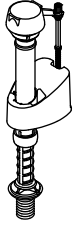

1378314** (LH)
1378313** (RH)

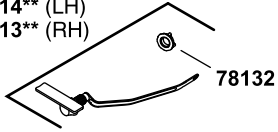

GP1083167

1267750



1213082
1225543**

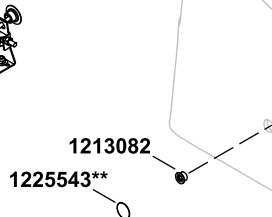

K-5383 (10" Rough-in)
1265858 (12" Rough-in)
K-5381 (14" Rough-in)

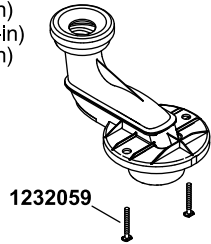

1232059

1378749**

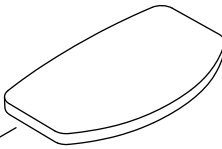

83143



1057940

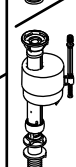

85307



1248135



GP1059291



1101470



GP1229656

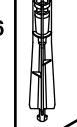

1070291



1378305

1324795



1057941



42398



42397



50751



1112256

