

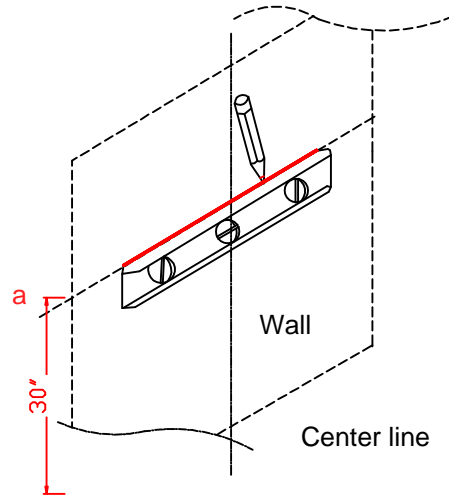

389-V48-AGR-A / 389-V48-CFO-A / 389-V48-GW-A / 389-V48-LTO-A Vanity
Assembly Instructions

Tools required

Screw driver drill with 5/16" bit Pencil Measuring tape Screw driver Leveler Hammer

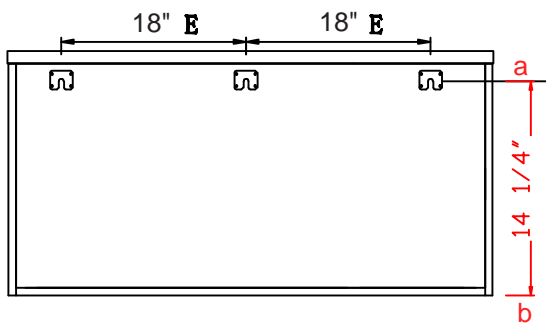
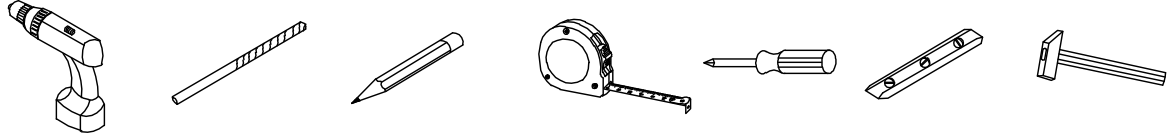

Step 1:
 Metal plates has been pre-installed to the back of cabinet, measure the distance between the bottom of the cabinet and point a.

Step 2:
 Draw a horizontal line from the point a by using a leveler.
 (suggested H30" from floor to "a" line)

- A=12PCS $\varnothing 8 \times 38$
- B=3PCS 58*48*7
- C=12PCS $\varnothing 4 \times 40$

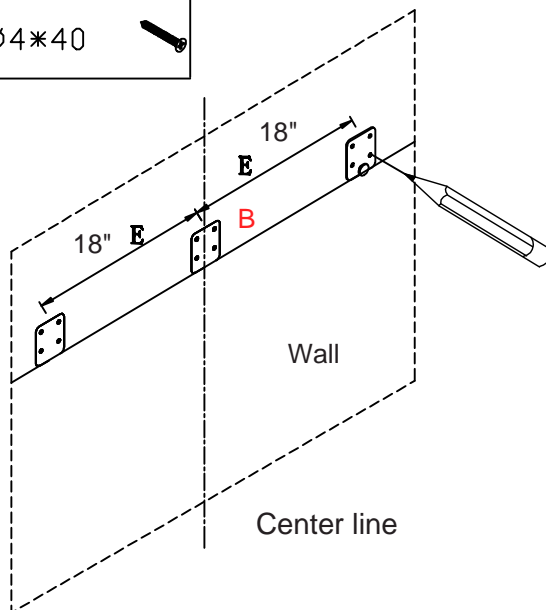

Step 3:
 Draw the points according to the hole of the mounting bracket

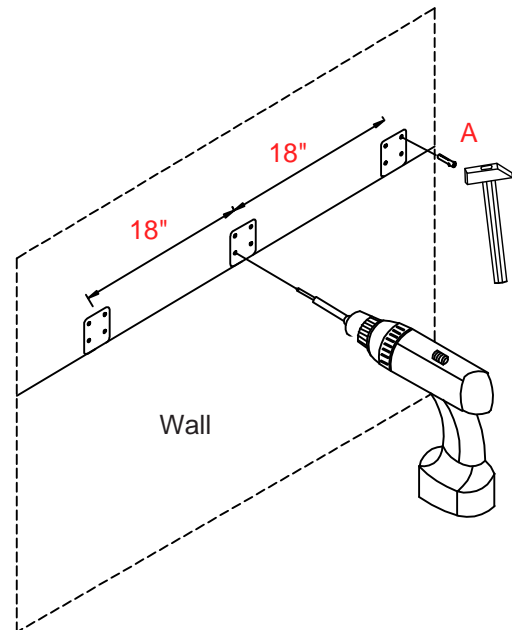

Step 4:
 Drill the holes' depth no less than 40mm, and insert "A" to the holes by using hammer.



389-V48-AGR-A / 389-V48-CFO-A / 389-V48-GW-A / 389-V48-LTO-A Vanity
Assembly Instructions

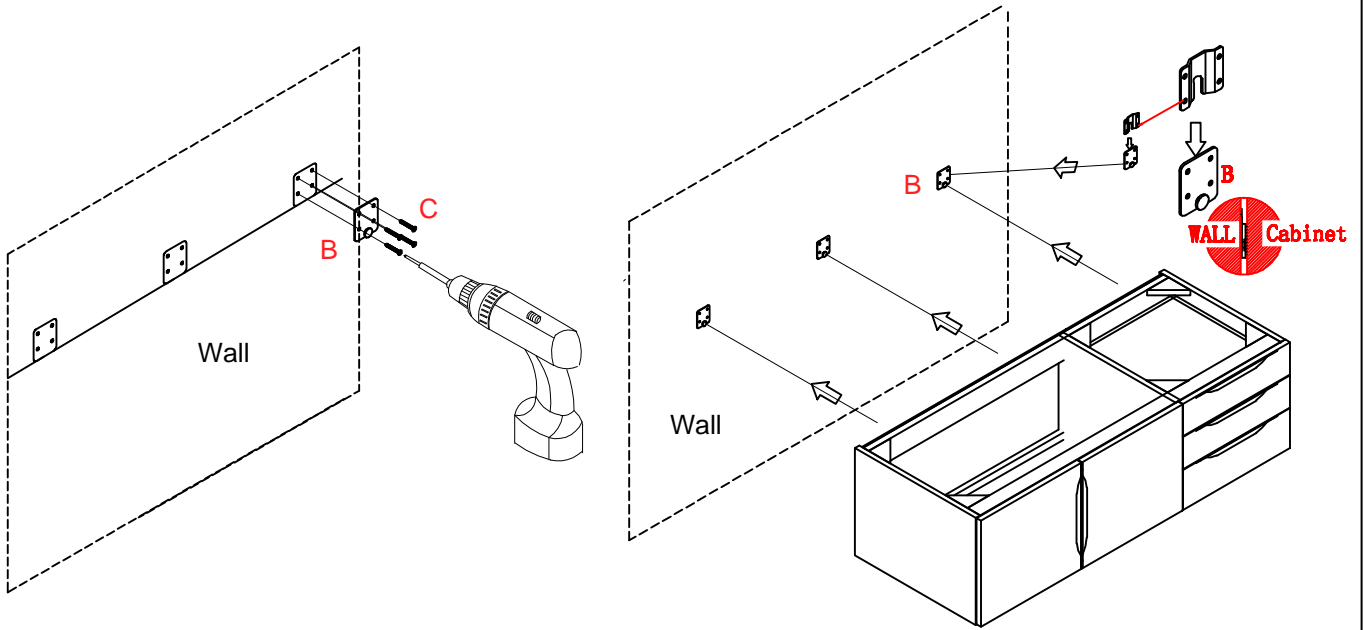

Step 5: Attach the mounting bracket to the wall.



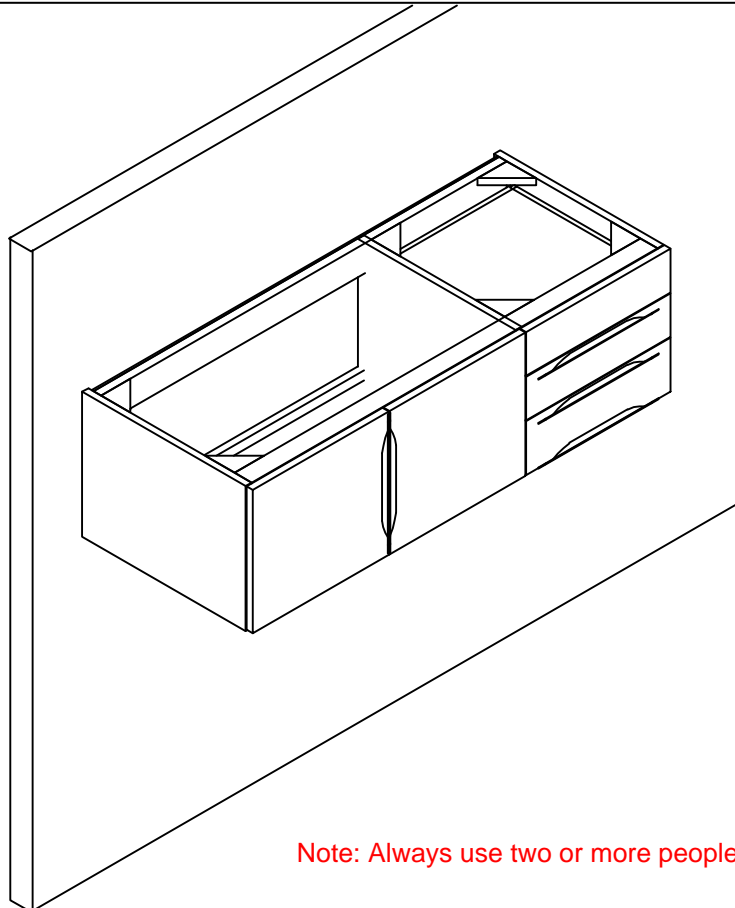

Step 6: Hang the cabinet on the mounting bracket.



Note: Always use two or more people when hanging cabinet.



389-V48-AGR-A / 389-V48-CFO-A / 389-V48-GW-A / 389-V48-LTO-A Vanity
Assembly Instructions

D =2pcs	Ø1/4*1-3/4	
E =1pc	Ø 4	
F =2pcs	Ø 1/4	
G =2pcs	Ø1/4 * 16	

Note:
Remove the top drawer from the cabinet for access to the pre-drilled holes.

Step 7: Attach washbasin to the top of cabinet, insert the bolt through the Spring Washer (F) and the Flat Washer (G) through the underneath of corner block by Allen wrench.

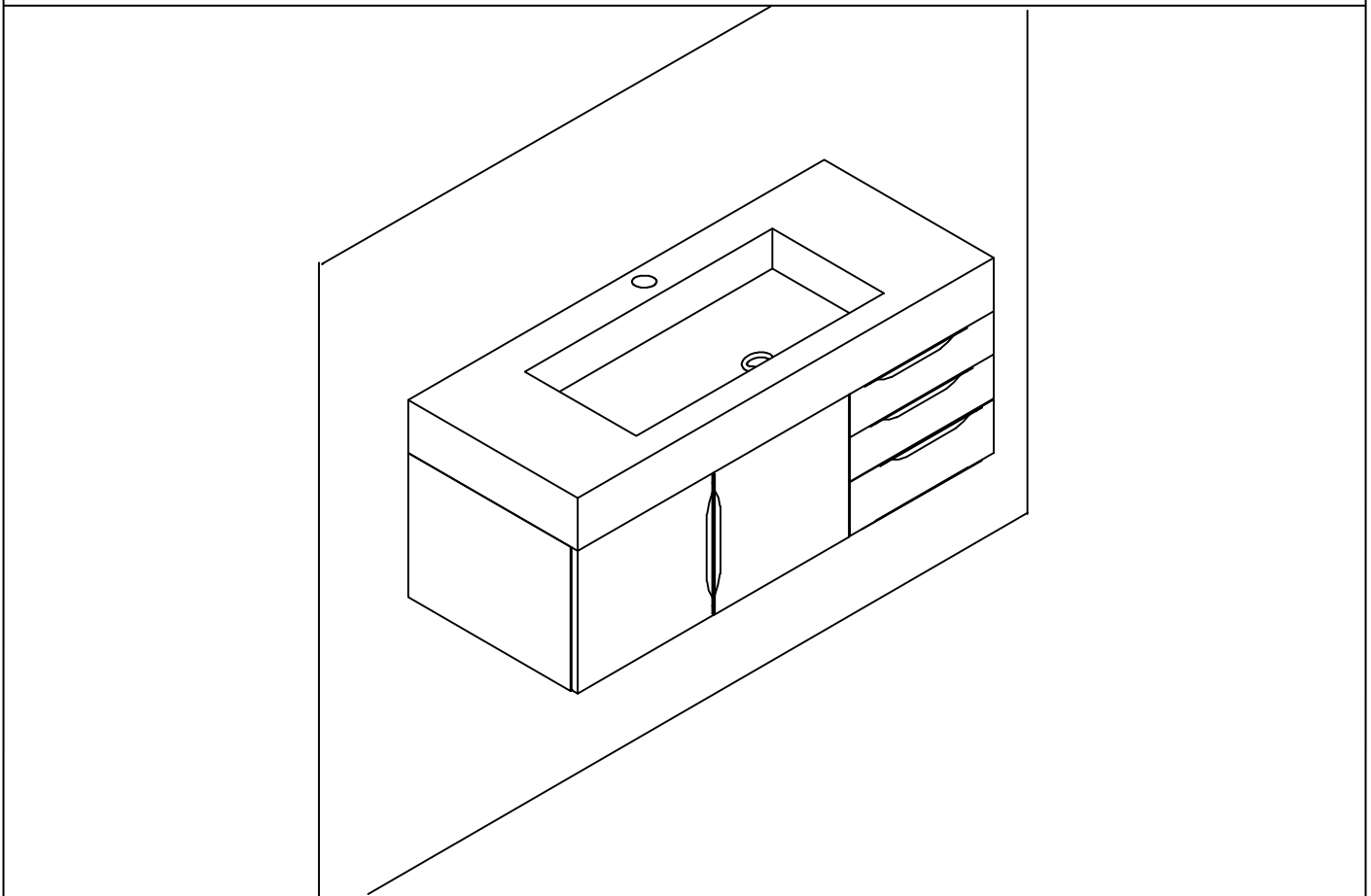



Drawer assembly and removal (with peg)

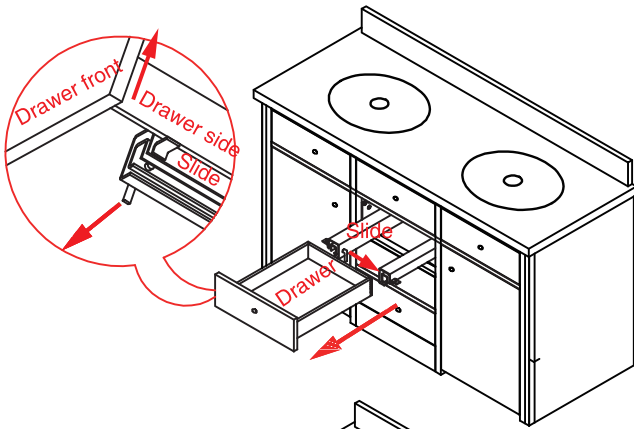

1. For removal, pull out the locking pin from the drawer side. Lift the drawer and pull it out from the cabinet.

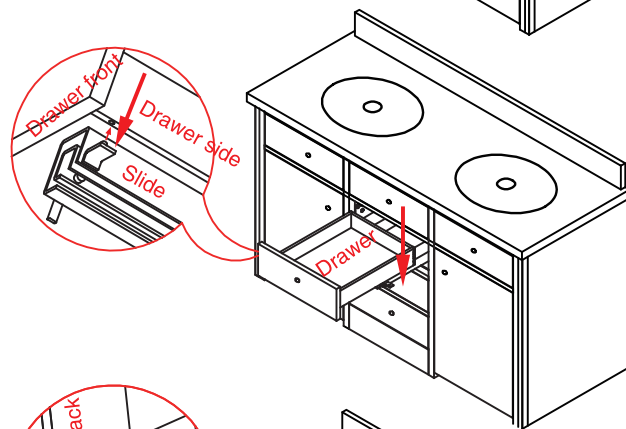

2. For the assembly of drawer, pull out the drawer member of the slide from the cabinet, lay the drawer onto the slide.

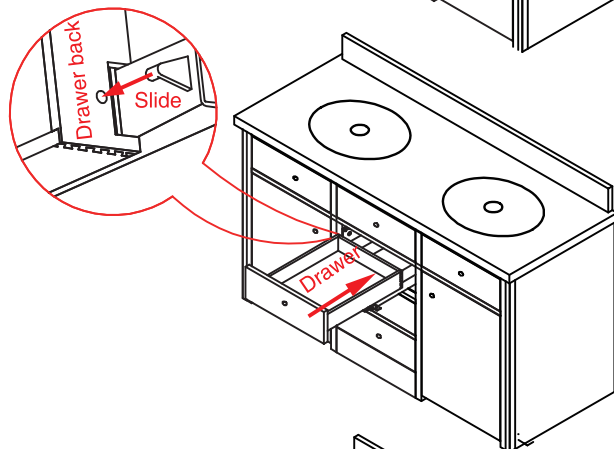

3. Align drawer back board hole and slide the hook of slide end, push the hook will slide into the hole.

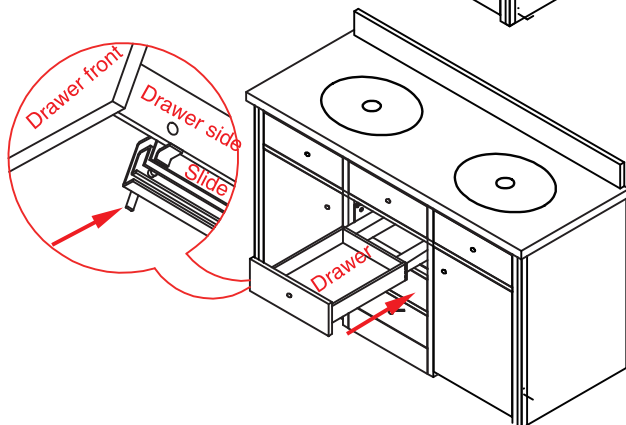

4. Press the locking pin into the drawer side hole to lock the position of the drawer.

Visit our website for a video showing drawer removal and installation.
www.jamesmartinvanities.com
 Knowledge Base / Solutions / Installation and Assembly