

### Features

- Premium construction ensures durability and reliability
- Cross handles
- Push-button diverter
- 35° spout
- NPT connection

### Required Accessories

K-11748-K

or

K-11748-KS

### Adapters, Rough-in and Extension Kits

1016154

88526



### Codes/Standards

ASME A112.18.1/CSA B125.1

ASSE 1016





DOE - Energy Policy Act 1992

California Energy Commission (CEC)

See website for detailed warranty information.

### Available Color/Finishes

*Color tiles intended for reference only.*

Color	Code	Description
	CP	Polished Chrome
	SN	Vibrant® Polished Nickel
	BGD	Vibrant® Moderne Brushed Gold
	BN	Vibrant® Brushed Nickel
	BV	Vibrant® Brushed Bronze

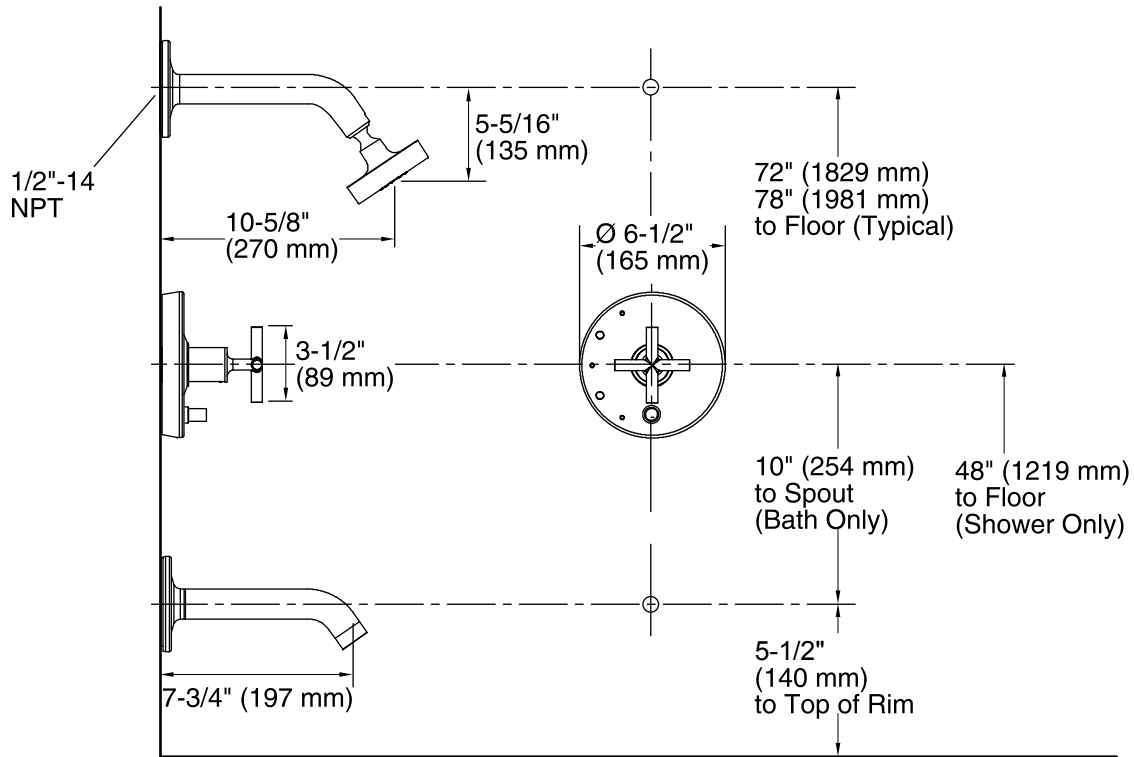

## Technical Information

All product dimensions are nominal.

### Showerhead:

Rated maximum flow: 2.5 gal/min (9.5 l/min)

Pressure: 80 psi (5.5 bar)

## Notes

Install this product according to the installation guide.

Avoid cross-flow conditions. Do not install shut-off device on either valve outlet.

Cap the shower outlet if deck-mount spout, diverter, or handshower is connected to the spout outlet.

## Product Information

Applicable faucet trim only:	
Bath and shower cross handle* (shown)	K-T14420-3
Bath and shower lever handle*	K-T14420-4
Shower cross handle*	K-T14421-3
Shower lever handle*	K-T14421-4
Shower only trim, cross handle	K-T14422-3
Shower only trim, cross handle	K-T14422-4
Non-diverter valve cross handle*	K-T14423-3
Non-diverter valve lever handle*	K-T14423-4
Valve W/diverter only trim, cross handle	K-T14501-3
Valve W/Diverter only trim, lever handle	K-T14501-4
35° Bath spout	K-14426
90° Bath spout	K-14427
*Rite-Temp® valve must be ordered to complete faucet.	

Required accessories:	
Rite-Temp® valve <b>OR</b>	K-304-*
HiFlow Rite-Temp valve with stops <b>OR</b>	K-2971-KS
Rite-Temp valve with diverter <b>OR</b>	K-11748-K
Rite-Temp valve with diverter and stops	K-11748-KS
* For a complete listing of all the Rite-Temp valves, refer to the K-304-* Specification Sheet or Roughing-In Sheet.	

### Optional accessories:

HiFlow Rite-Temp® thin wall installation kit	88526
Deep roughing-in kit for Rite-Temp® valve (lever and cross handles)	1016154

## Installation Notes

Install this product according to the installation guide.

**NOTICE: Risk of product damage.** Long screws, for installing trim, can damage the K-2971-KS valve. Consult the trim installation guide to verify if the thin wall installation kit (88526) is needed.

Install this product according to the installation guide.

Avoid cross-flow conditions. Do not install shut-off device on either valve outlet.

Cap shower outlet if deck-mount spout, diverter, or handshower is connected to spout outlet.

Install straight pipe or tube drop of 7" (17.8 cm) to 18" (45.7 cm) with single elbow between valve and wall-mount spout.

