



CASWELL™ 4-HOLE DECK MOUNT TUB FILLER WITH HANDSHOWER

Modern Caswell™

CA2211LM

FEATURES

- Solid brass construction
- Metal lever handles
- Single-function handshower with easy cleaning face
- 8 1/32" spout reach
- 4 29/32" spout height
- 1/4-turn ceramic valves; self-cleaning, self-lubricating, quiet operation
- Self leveling mounting hardware
- Flow rate: 15 to 16 GPM at 45 PSI
- Cutouts: 3 x 1 1/4", spout 2"
- 3/4" NPT connectors

COLORS/FINISHES

- Polished Chrome
- Polished Nickel
- Satin Nickel

WARRANTY

- Limited Lifetime

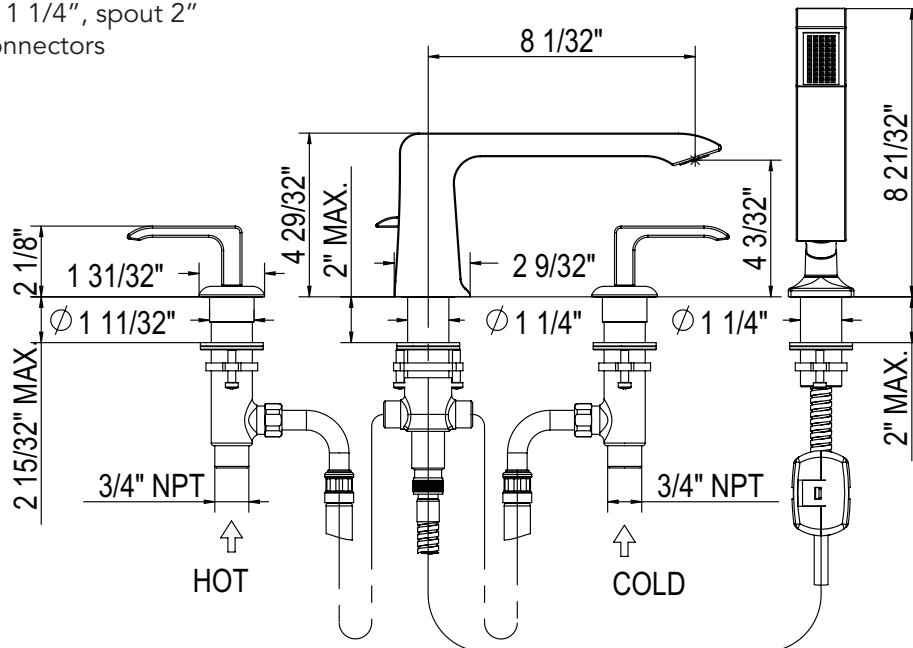

INSTALLATION INSTRUCTIONS

ROHL CASWELL 4 HOLE TUB FACUCET WITH HANDSET CA2211LMAPC, CA2211LMPN, CA2211LMSTN INSTALLATION INSTRUCTIONS

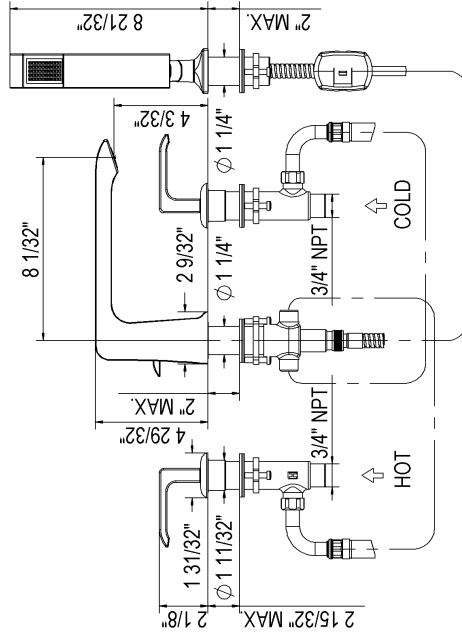

Please leave instructions with the home owner once installed.

SYSTEM REQUIREMENTS

To ensure the optimum performance and customer satisfaction, please adhere to the following:

- Flush out all pipe work prior to installation.
- Maximum operating pressure 75psi
- NOTE: Pressures over 75psi will require that the house have a pressure regulator installed to limit the pressure below 75psi.
- Maximum hot water temperature 145°F
- If the water temperature exceeds 145°F an approved tempering valve must be fitted.
- Maximum flow rate: 12 US gallons/minute at 60psi flow pressure.
- Flow rate for tub filler is 12gpm at 60psi.
- Hand shower flow rate is 2gpm.
- Please follow local code guidelines for Asse 1016.

#41908 12/13

5. From above the deck feed the knurled end of the hose #36 end through handset base gently and connect hose to base of diverter block #17, ensure washer #16 is in place.
6. Connect handset to hose ensuring washer #40 is in place.
7. Install the counter weight #28 to hose #36 and secure with clips on weight. Check travel and movement and reposition counter weight if necessary.

After Installation:

1. Test each side valve for leaks at each connection.
2. Test the faucet operation for leaks with the water running.
3. Access below the deck is required for handset hose.
Note: An access panel is recommended.

Recommended diverter operation:

The diverter is spring loaded and depends on pressure to stay engaged. With the water running, pull the diverter up to fully engage the hand spray. To use the tub filler again, turn the unit off and let the diverter re-set with no pressure. **Do not force the diverter back into position when the water is running.** This action may damage the diverter.

Care and Maintenance:

After use, wipe down with a soft, dry cloth. For all chrome plated surfaces clean this product with warm soapy water and then dry with a dry soft cloth. Nickel plated, satin and Inca brass finishes should be cleaned with a soft cloth and warm water. Then dry with a dry soft cloth. Do not use cream cleaners or cleaning agents containing a corrosive acid or scouring agent including: Softscrub, Comet, Ajax and Bonami, as these may damage the surface of the faucet. Do not use any spray cleaners with ammonia or alcohol like Windex, 409 or Fantastik. Any use of unsuitable cleaning agents causing damage to the surface will not be covered by the warranty.

WARRANTY: Warranty is limited lifetime. See ROHL website for details. (www.rohlhome.com). A basic in-line filter system is required for the house to protect any debris from entering the water supply line to the house (i.e. due to construction or service work on the street water main).

ROHL

Authentic Luxury for Kitchen and Bath®

ROHL LLC 3 Parker Irvine, CA 92688
714-557-1933 www.rohlhome.com

INSTALLATION INSTRUCTIONS

Installation Instructions

Flush out all pipework to remove any foreign material. The hot supply should be fitted on the left when viewed from the front.

Installing Hot & Cold Side Valves and Trim: (2 x 1 5/16" cut-outs)

- Remove trim parts #1 through #6.
 - Remove side valve escutcheon #8.
- Install the side valve #13 from below the deck with the outlets facing outwards.
 - From the top of the deck install and **tighten** the side valve escutcheon #8 onto side valve and ensure base o-ring seal #9 is in place.
 - Install the escutcheon #6.
 - Note: Escutcheon #6 has a pre-set height for fitting. Set the escutcheon to the pre-set height.
 - Set escutcheon square before installing the lever assembly.
 - Install the locking ring nut #5, then the plastic washer #4 and the lever #3, as shown.
 - Position the lever and escutcheon and tighten the jack screws #12.

Installing the Spout: (1 5/16" cut-out)

- Remove diverter parts #17 through #20.
- Install the spout complete with spout base tail #22 fitted into the bench top and ensure base o-ring seal #21 is in place.
- From below the deck.
 - Install mounting nut #18, steel washer #19 and rubber washer #20 and tighten jack screws.
 - Hand tighten diverter block #17 to spout base tail #22.
- Connect the hot (red) and cold (blue) flexi hoses #14 to side valves #13, ensure the sealing washers #15 are in place.
 - Note: The hoses can only be fitted one way to avoid kinks. (Refer to drawing.)
 - Turn the nut and not the hose.** Twisting the hose may cause damage or low flow.

Installing the Pull Out Handset: (1 x 1 5/16" cut-out)

- Remove escutcheon #35 by loosening grub screws, and parts #29 through #31.
- Install the hand set base tail #33 from top of the deck and ensure base o-ring seal #32 is in place.
- Install mounting nut #29, steel washer #30 and rubber washer #31 and tighten jack screws.
- Install the escutcheon #35.
 - Set escutcheon square and tighten grub screws, ensure base o-ring seal #34 is in place.

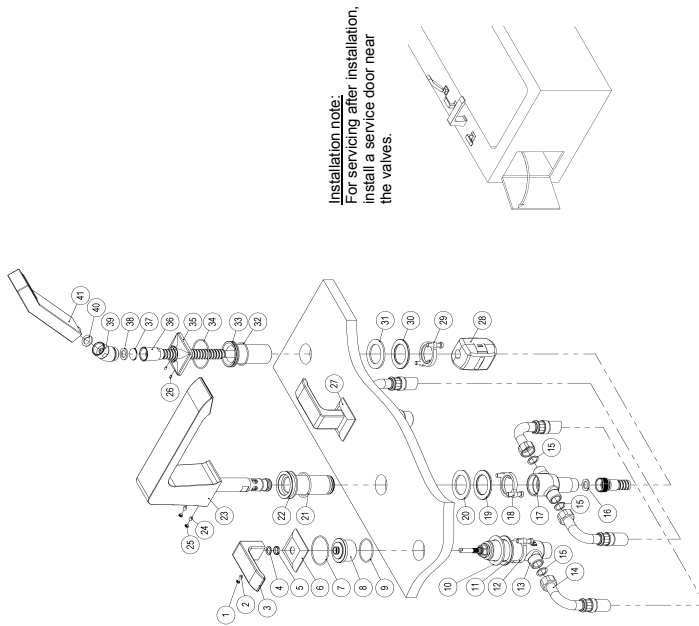

Installation note:
For servicing after installation,
install a service door near
the valves.

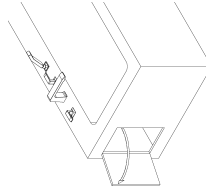

1	CHROME BUTTON
2	M5 GRUB SCREW
3	LEVER
4	PLASTIC WASHER
5	LOCKING RING NUT
6	ESCUTCHEON
7	HANDLE ASSEMBLY
8	SIDE VALVE ESCUTCHEON
9	O RING
10	RUBBER WASHER
11	STEEL WASHER
12	MOUNTING NUT
13	SIDE VALVE
14	G1/2" - G1/2" HOSE - 23.5/8" LONG
15	RUBBER WASHER
16	G1/2" RUBBER WASHER
17	DIVERTER BLOCK
18	MOUNTING NUT
19	STEEL WASHER
20	RUBBER WASHER
21	O RING
22	SPOUT BASE TAIL
23	BATH FILLER DECK MOUNTED SPOUT
24	M5 GRUB SCREW
25	CHROME BUTTON
26	M3 GRUB SCREW
27	HANDLE ASSEMBLY
28	COUNTER WEIGHT
29	MOUNTING NUT
30	RUBBER WASHER
31	RUBBER WASHER
32	O RING
33	HANDSET BASE TAIL
34	O RING
35	HANDSET ESCUTCHEON
36	2X HANDSET HOSE
37	FLOW RESTRICTOR
38	G1/2" RUBBER WASHER
39	ANGLE ELBOW
40	RUBBER WASHER
41	HANDSET