

DIMENSIONAL SPECIFICATIONS

STAINLESS STEEL ISO PATTERN FITTINGS 150 LB.

TEE (304)

Part #	Size (IN.)	Approx. Net WT. (LB.)	A	L
K406-02	1/8	0.12	0.67	0.75
K406-04	1/4	0.18	0.84	0.83
K406-06	3/8	0.23	0.93	0.98
K406-08	1/2	0.34	1.18	1.10
K406-12	3/4	0.49	1.38	1.30
K406-16	1	0.80	1.69	1.50
K406-20	1-1/4	1.18	2.05	1.77
K406-24	1-1/2	1.51	2.30	1.97
K406-32	2	2.35	2.81	2.28
K406-40	2-1/2	3.94	3.43	2.72
K406-48	3	4.06	3.94	3.07
K406-64	4	7.80	4.92	3.78

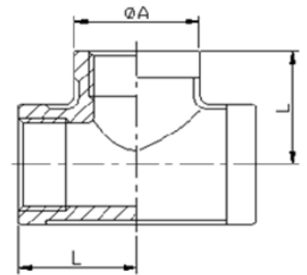

MERIT
BRASS

DIRECTING THE FLOW OF *Quality*