

DIMENSIONAL SPECIFICATIONS

STAINLESS STEEL ISO PATTERN FITTINGS 150 LB.

HEX HEAD PLUG (304)

| Part # | Size (IN.) | Approx. Net WT. (LB.) | L | SW |
|----------|------------|-----------------------|------|------|
| K417H-02 | 1/8 | 0.03 | 0.67 | 0.47 |
| K417H-04 | 1/4 | 0.04 | 0.69 | 0.63 |
| K417H-06 | 3/8 | 0.08 | 0.71 | 0.79 |
| K417H-08 | 1/2 | 0.11 | 0.98 | 0.94 |
| K417H-12 | 3/4 | 0.16 | 1.02 | 1.18 |
| K417H-16 | 1 | 0.26 | 1.14 | 1.50 |
| K417H-20 | 1-1/4 | 0.45 | 1.38 | 1.81 |
| K417H-24 | 1-1/2 | 0.66 | 1.50 | 2.05 |
| K417H-32 | 2 | 0.97 | 1.54 | 2.56 |
| K417H-40 | 2-1/2 | 1.55 | 1.73 | 3.19 |
| K417H-48 | 3 | 2.51 | 2.13 | 3.74 |
| K417H-64 | 4 | 4.34 | 2.17 | 4.69 |

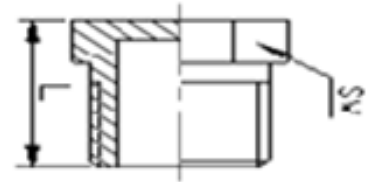

HEX HEAD PLUG (316)

| Part # | Size (IN.) | Approx. Net WT. (LB.) | L | SW |
|----------|------------|-----------------------|------|------|
| K617H-02 | 1/8 | 0.03 | 0.67 | 0.47 |
| K617H-04 | 1/4 | 0.04 | 0.69 | 0.63 |
| K617H-06 | 3/8 | 0.08 | 0.71 | 0.79 |
| K617H-08 | 1/2 | 0.11 | 0.98 | 0.94 |
| K617H-12 | 3/4 | 0.16 | 1.02 | 1.18 |
| K617H-16 | 1 | 0.26 | 1.14 | 1.50 |
| K617H-20 | 1-1/4 | 0.45 | 1.38 | 1.81 |
| K617H-24 | 1-1/2 | 0.66 | 1.50 | 2.05 |
| K617H-32 | 2 | 0.97 | 1.54 | 2.56 |
| K617H-40 | 2-1/2 | 1.55 | 1.73 | 3.19 |
| K617H-48 | 3 | 2.51 | 2.13 | 3.74 |
| K617H-64 | 4 | 4.34 | 2.17 | 4.69 |

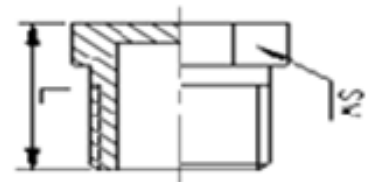

**MERIT
BRASS**

DIRECTING THE FLOW OF *Quality*