

PlumBite® Push On Check Valve

Specifications

- A heat-free method of joining Copper, CPVC, PE-RT or PEX tubing. Fittings can be removed and re-used, using the disassembly tool (sold separately).

Applications

- Commercial and residential potable and non-potable water applications
- NOTE:** Not for use with PEX-AL-PEX or PEX tubing with an oxygen barrier.
- NOT FOR USE AT OR BELOW GROUND LEVEL.

Materials

- Gasket- EPDM, Peroxide Cured
- Valve Body- Brass

Dimensions and Product Offering

Part Code	Part Code Bulk	A -Nominal (in.)	B -(in.)	B -Tolerance +/- (in.)
C77466LF	-	1/2	2.63	0.05
C77467LF	-	3/4	3.24	0.01

Performance Specifications

- Maximum Temperature: 180°F
- Maximum Pressure: 200 PSI
- Service: Potable Water
- Exposure to water with elevated levels of inorganic materials (including but not limited to: Cl, Na, Mg, Ca, K), especially in high temperatures and high water velocity areas, could quicken the corrosion process.

Certifications/Listings/Approvals

- NSF/ANSI/CAN 61
- NSF/ANSI/CAN 372
- NSF/ANSI 14
- IAPMO IGC 312-2018a
- SDWA Compliant
- Lead Law Compliant
- MASS Approved
- Vermont Act 193 Compliant

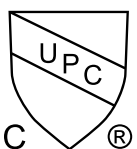

Job Name _____

Location _____

Engineer _____

Contractor _____

Tag _____ PO# _____

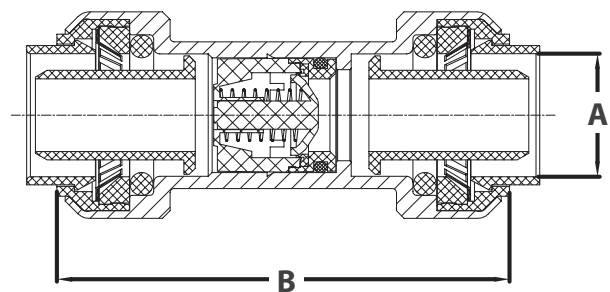

EXPLODED VIEW

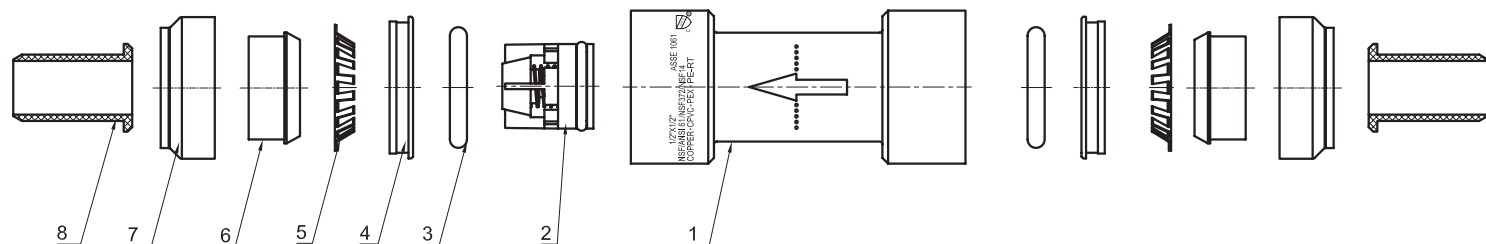

REF NO.	DESCRIPTION	MATERIAL	QTY
1	BODY	LEAD FREE BRASS (C46500)	1
2	VALVE CORE	ASSEMBLY (POM+S304+EPDM)	1
3	O-RING	EPDM	2
4	LOCK RING	POM or PA66	2
5	GRIPPER RING	STAINLESS STEEL (300 series)	2
6	RELEASER	POM	2
7	PROTECTOR	POM	2
8	TUBE SUPPORT	POM	2

Flow Capacity

