

DIMENSIONAL SPECIFICATIONS

STAINLESS STEEL ISO PATTERN FITTINGS 150 LB.

TEE (316)

| Part # | Size (IN.) | Approx. Net WT. (LB.) | A | L |
|---------|------------|-----------------------|------|------|
| K606-02 | 1/8 | 0.12 | 0.67 | 0.75 |
| K606-04 | 1/4 | 0.18 | 0.84 | 0.83 |
| K606-06 | 3/8 | 0.23 | 0.93 | 0.98 |
| K606-08 | 1/2 | 0.34 | 1.18 | 1.10 |
| K606-12 | 3/4 | 0.49 | 1.38 | 1.30 |
| K606-16 | 1 | 0.80 | 1.69 | 1.50 |
| K606-20 | 1-1/4 | 1.18 | 2.05 | 1.77 |
| K606-24 | 1-1/2 | 1.51 | 2.30 | 1.97 |
| K606-32 | 2 | 2.35 | 2.81 | 2.28 |
| K606-40 | 2-1/2 | 3.94 | 3.43 | 2.72 |
| K606-48 | 3 | 4.06 | 3.94 | 3.07 |
| K606-64 | 4 | 7.80 | 4.92 | 3.78 |

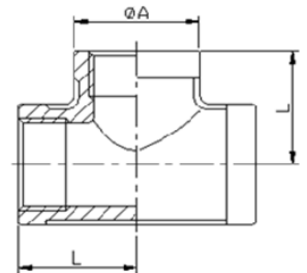

REDUCING TEE (304)

| Part # | Size (IN.) | Approx. Net WT. (LB.) | A | L |
|-------------|-------------------|-----------------------|------|------|
| K406-121208 | 3/4 x 3/4 x 1/2 | 0.50 | 1.38 | 1.18 |
| K406-161612 | 1 X 1 X 3/4 | 0.82 | 1.69 | 1.38 |
| K406-202016 | 1-1/4 X 1-1/4 X 1 | 1.25 | 2.05 | 1.57 |

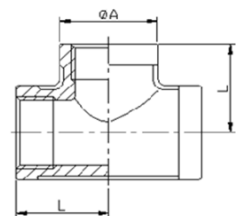

MERIT BRASS

DIRECTING THE FLOW OF *Quality*