

SPECIFICATIONS

FIGURE 780190
BEAM CLAMPS



MALLEABLE IRON ROD SUPPORT BEAM CLAMP

FEATURES

- Material: Malleable iron
- Standard finish: Electro-galvanized
- Maximum flange thickness of 1/2"

PRODUCT SPECIFICATIONS

Material Specifications and Finishes

Carbon Steel – ASTM A1011-00 SS GR 33 or ASTM A1011-00CS Type B

Z: Electro-Galvanized (standard finish). Electroplating deposits zinc on the surface of the steel by electrolysis from a bath of zinc salts. Recommended for relatively dry indoor use. This is the standard coating for most FNW products. Thickness of applied zinc is between 0.2 mils to 0.5 mils [5.1 µm to 12.7 µm]. Coatings on FNW Z products meet ASTM B633 SC1 Type III.

HD: Hot Dip Galvanized After Fabrication. Fabricated product is dipped in molten zinc and is completely covered on all surfaces. Recommended for outdoor use. Coatings on FNW HD products meet ASTM A123/153. The zinc coating is typically 2.6 mils [66.0 µm] or 1.5 oz. per square foot [0.46 kg per square meter] per side.

S6: 316 Stainless Steel – ASTM A240 (Type 316), 316 Stainless Steel Nuts – ASTM A276-03

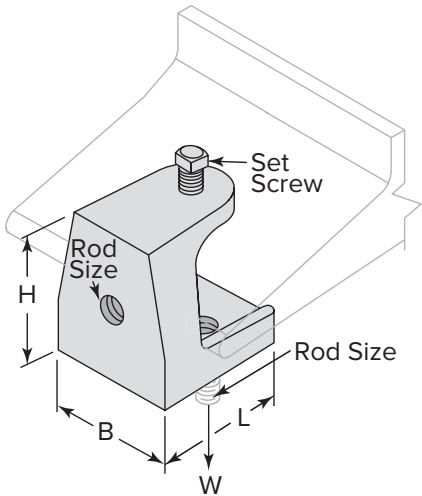
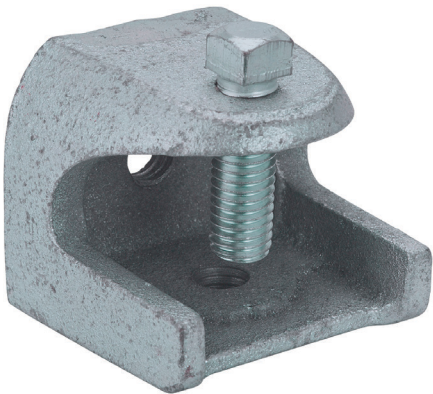

Catalog Number	Weight (lbs)	Rod Size	Set Screw Size	B (in.)	L (in.)	H (in.)	Max Load (W) lbs
FNW780190Z0025	0.20	1/4"–20	5/16"–18	1-3/16	1-3/8	1-3/8	335
FNW780190Z0037	0.67	3/8"–16	1/2"–13	2-1/16	1-7/8	1-3/4	525
FNW780190Z0050	1.22	1/2"–13	1/2"–13	2-1/2	2-3/8	2-3/16	750