

American Standard

Ultima™ Sensor-Operated Flush Valve

With Side-Mount Operator, Diaphragm-Type

MODEL NUMBERS
6145SM

M909318-0070A
INSIDE COVER

M954327-0070A
DIAPHRAGM ASSEMBLY - 0.125 GPF

M954326-0070A
DIAPHRAGM ASSEMBLY - 0.5 GPF

M954319-0070A
DIAPHRAGM ASSEMBLY - 1.0/1.6 GPF

SMGODIA.002
SIDE MOUNT OPERATOR

A912809-0070A
TAILPIECE O-RING

M964945-0020A
ADJUSTABLE TAILPIECE
(4-1/4" to 5-1/4" Rough-in)

OPTIONAL ADJUSTABLE TAILPIECE
(Purchased Separately)

M962836-0020A (8-1/4" to 9-1/4" Rough-in)

M962835-0020A (7-1/4" to 8-1/4" Rough-in)

M962834-0020A (6-1/4" to 7-1/4" Rough-in)

M962833-0020A (5-1/4" to 6-1/4" Rough-in)

M964402-0070A
HIGH BP VACUUM
BREAKER REPAIR KIT

M964075-0070A
3/4" SWEAT ADAPTER

M955058-0020A
3/4" STOP VALVE

M964412-0020A
3/4" VACUUM
BREAKER ASSEMBLY
FOR 11-1/2" (220 mm)
ROUGH-IN

M952261-0020A
3/4" INLET PIPE
ASSEMBLY

M970355-0020A
STOP VALVE REPAIR KIT

M924347-0020A
STOP VALVE CAP

M952262-0020A
ESCUTCHEON KIT

PART OF **LIXIL**



HOT LINE FOR HELP
For toll-free information and answers to your questions, call:
(844) CRT-TEAM / (844) 278-8326
Mon. - Fri. 8:00 a.m. to 8:00 p.m. EST Saturday 10:00 a.m. to 4:00 p.m. EST
IN MEXICO 01-800-839-1200
IN CANADA 1-800-387-0369 (TORONTO 1-905-306-1093)
Weekdays 8:00 a.m. to 7:00 p.m. EST

Product names listed herein are trademarks of AS America, Inc. ©2019

To learn more about American Standard Selectronic® Products visit our website at:
www.americanstandard-us.com or e-mail us at: CRTTEAM@lixilamericas.com

American Standard

Ultima™ Sensor-Operated Flush Valve

With Side-Mount Operator,
Diaphragm-Type

MODEL NUMBERS
6147SM

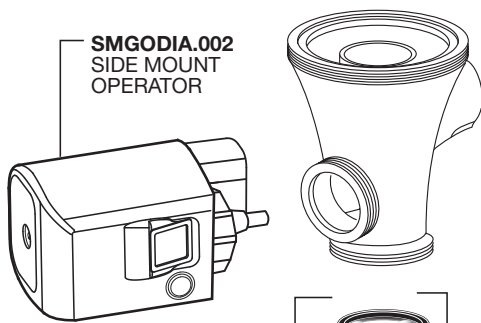
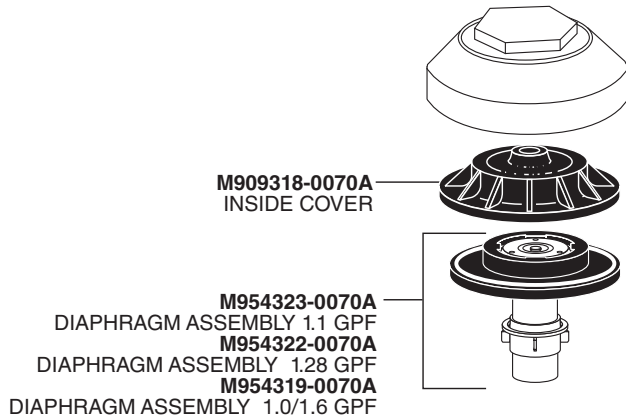

OPTIONAL ADJUSTABLE TAILPIECE
(Purchased Separately)

M962836-0020A (8-1/4" to 9-1/4" Rough-in)

M962835-0020A (7-1/4" to 8-1/4" Rough-in)

M962834-0020A (6-1/4" to 7-1/4" Rough-in)

M962833-0020A (5-1/4" to 6-1/4" Rough-in)

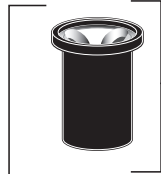

M964411-0020A
VACUUM BREAKER
ASSEMBLY 11-1/2"
(220 mm) ROUGH-IN

M964413-0020A
VACUUM BREAKER
ASSEMBLY 27"
(686 mm) ROUGH-IN

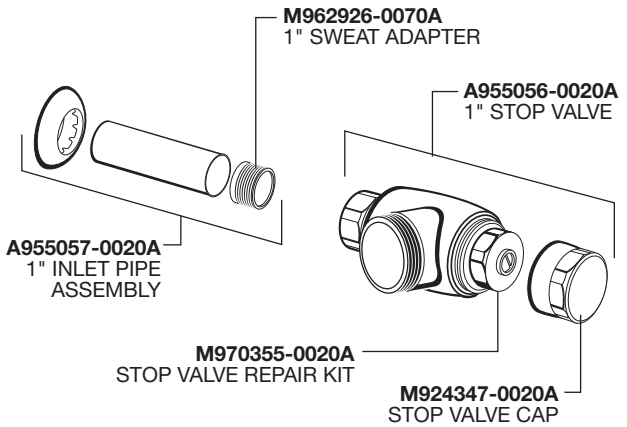

M952269-0020A
ESCUTCHEON KIT

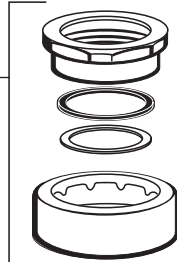

PART OF LIXIL



HOT LINE FOR HELP
For toll-free information and answers to your questions, call:
(844) CRT-TEAM / (844) 278-8326
Mon. - Fri. 8:00 a.m. to 8:00 p.m. EST Saturday 10:00 a.m. to 4:00 p.m. EST
IN MEXICO 01-800-839-1200
IN CANADA 1-800-387-0369 (TORONTO 1-905-306-1093)
Weekdays 8:00 a.m. to 7:00 p.m. EST

Product names listed herein are trademarks of AS America, Inc. ©2019

To learn more about American Standard Selectronic® Products visit our website at:
www.americanstandard-us.com or e-mail us at: CRTTEAM@lixilamericas.com

American Standard

Ultima,^{MC} robinet de chasse à capteur

Bouton latéral, type à diaphragme

NUMÉRO DE
MODÈLE

6145SM

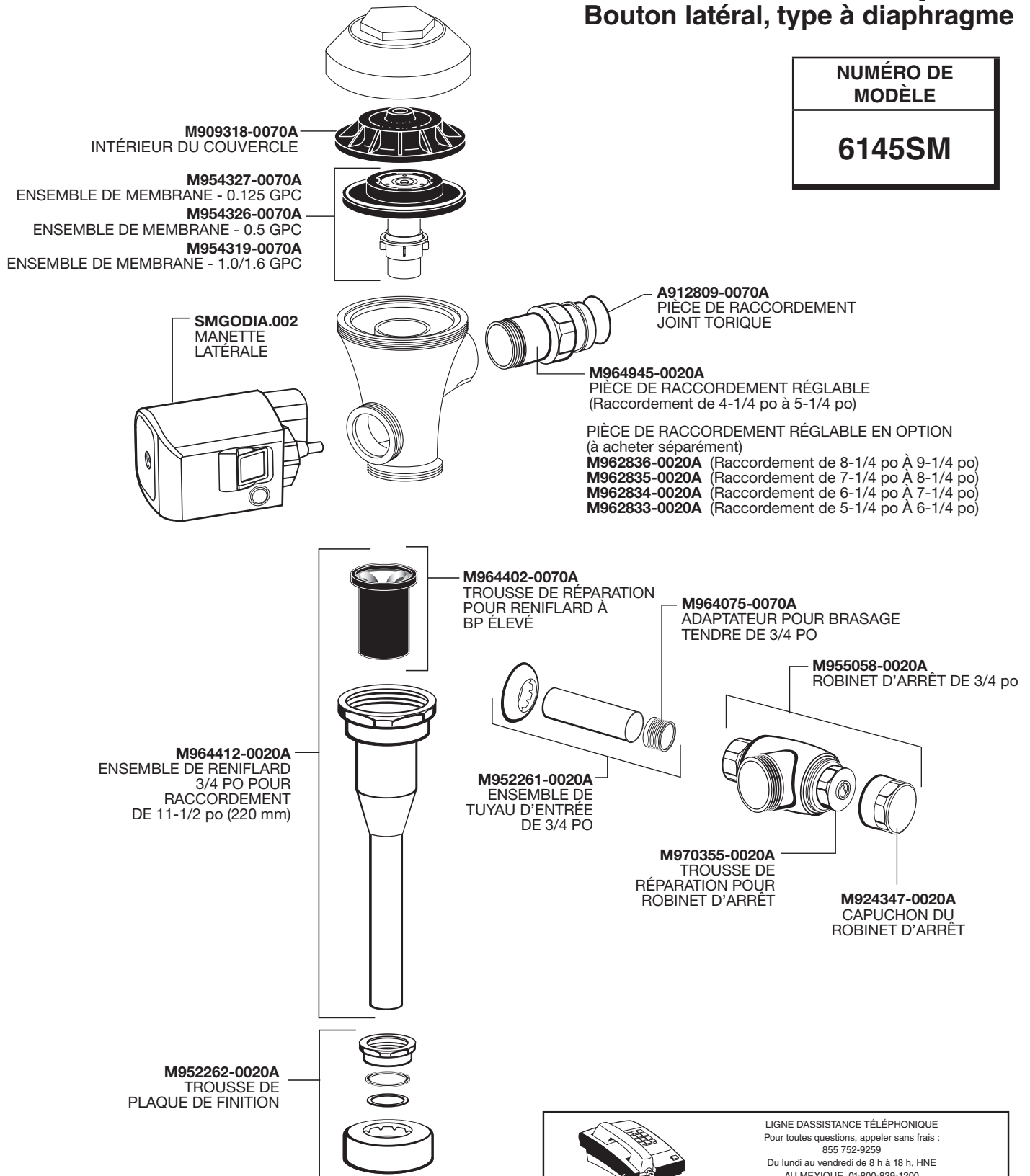

LIGNE D'ASSISTANCE TÉLÉPHONIQUE
Pour toutes questions, appeler sans frais :
855 752-9259
Du lundi au vendredi de 8 h à 18 h, HNE
AU MEXIQUE 01-800-839-1200
AU CANADA 1-800-387-0369 (TORONTO 1-905-306-1093)
Du lundi au vendredi de 8 h à 19 h, HNE

Les noms des produits énoncés dans les présentes sont des marques de commerce d'American Standard Inc. 2019

Apprendre plus de la Norme American Standard Selectronic® les Produits visitent notre site Internet à:
www.americanstandard-us.com ou l'e-mail nous à: CRITEAM@lifixamericas.com

PART OF LIXIL

American Standard

Ultima,^{MC} robinet de chasse à capteur

Bouton latéral, type à diaphragme

NUMÉRO DE
MODÈLE

6147SM

M909318-0070A
INTÉRIEUR DU COUVERCLE

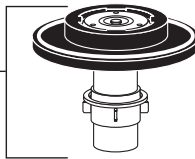
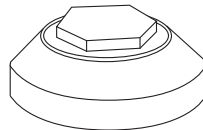

M954323-0070A
ENSEMBLE DE MEMBRANE 1.1 GPC
M954322-0070A
ENSEMBLE DE MEMBRANE 1.28 GPC
M954319-0070A
ENSEMBLE DE MEMBRANE 1.0/1.6 GPC

SMGODIA.002
MANETTE
LATÉRALE

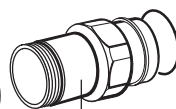
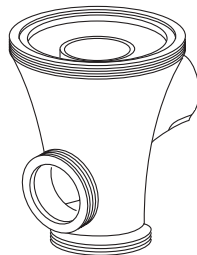
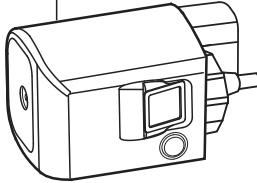

A912809-0070A
PIÈCE DE RACCORDEMENT
JOINT TORIQUE

M964945-0020A
PIÈCE DE RACCORDEMENT RÉGLABLE
(Raccordement de 4-1/4 po à 5-1/4 po)

PIÈCE DE RACCORDEMENT RÉGLABLE EN OPTION
(à acheter séparément)

M962836-0020A (Raccordement de 8-1/4 po À 9-1/4 po)
M962835-0020A (Raccordement de 7-1/4 po À 8-1/4 po)
M962834-0020A (Raccordement de 6-1/4 po À 7-1/4 po)
M962833-0020A (Raccordement de 5-1/4 po À 6-1/4 po)

M964402-0070A
TROUSSE DE RÉPARATION
POUR RENIFLARD À
BP ÉLEVÉ



M964411-0020A
ENSEMBLE DE RENIFLARD,
RACCORDEMENT
DE 11-1/2 po (220 mm)

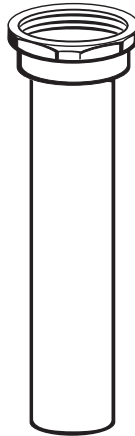

M964413-0020A
ENSEMBLE DE RENIFLARD,
RACCORDEMENT
DE 27 po (686 mm)

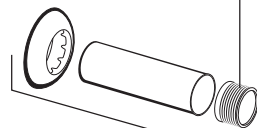

A955057-0020A
ENSEMBLE DE
TUYAU D'ENTRÉE
DE 1 PO

M962926-0070A
ADAPTATEUR POUR BRASAGE
TENDRE DE 1 PO

A955056-0020A
ROBINET D'ARRÊT DE 1 po

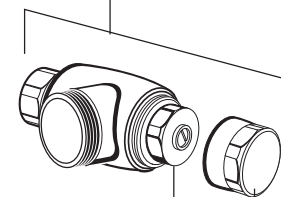

M970355-0020A
TROUSSE DE
RÉPARATION POUR
ROBINET D'ARRÊT

M924347-0020A
CAPUCHON DU
ROBINET D'ARRÊT

M952269-0020A
TROUSSE DE
PLAQUE DE FINITION

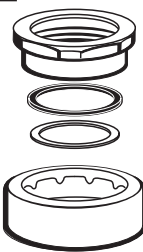

LIGNE D'ASSISTANCE TÉLÉPHONIQUE
Pour toutes questions, appeler sans frais :
855 752-9259

Du lundi au vendredi de 8 h à 18 h, HNE
AU MEXIQUE 01-800-839-1200

AU CANADA 1-800-397-0369 (TORONTO 1-905-306-1093)
Du lundi au vendredi de 8 h à 19 h, HNE

Les noms des produits énoncés dans les présentes sont des marques de commerce d'American Standard Inc. 2019

Apprendre plus de la Norme American Standard Selectronic® les Produits visitent notre site Internet à:
www.americanstandard-us.com ou l'e-mail nous à: CRTTEAM@lifixamericas.com

PART OF LIXIL

American Standard

Válvula de Descarga Operada por Sensor Ultima™

Con operador de montaje lateral, diafragma

NÚMERO DE MODELO

6145SM

M909318-0070A
TAPA INTERIOR

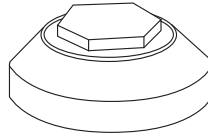

M954327-0070A
CONJUNTO DEL DIAFRAGMA - 0.125 G/D



M954326-0070A
CONJUNTO DEL DIAFRAGMA - 0.5 G/D



M954319-0070A
CONJUNTO DEL DIAFRAGMA - 1.0/1.6 G/D



SMGODIA.002
OPERADOR DE MONTAJE LATERAL

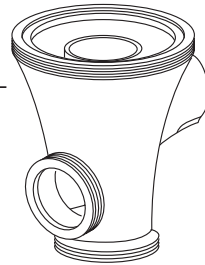
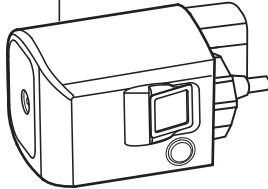

A912809-0070A
PIEZA POSTERIOR DE ANILLO O

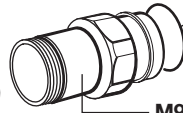

M964945-0020A
PIEZA POSTERIOR AJUSTABLE
(preparación de 4-1/4" a 5-1/4")

PIEZA POSTERIOR AJUSTABLE OPCIONAL
(se compra por separado)

M962836-0020A (preparación de 8-1/4" a 9-1/4")

M962835-0020A (preparación de 7-1/4" a 8-1/4")

M962834-0020A (preparación de 6-1/4" a 7-1/4")

M962833-0020A (preparación de 5-1/4" a 6-1/4")

M964402-0070A
KIT DE REPARACIÓN DE LA VÁLVULA DE CONTRAFLUJO DE BP ELEVADO



M964075-0070A
ADAPTADOR DE SOLDADURA DE 3/4"

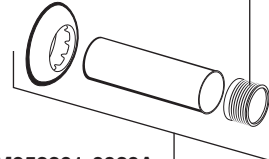

M955058-0020A
VÁLVULA DE CIERRE DE 3/4"

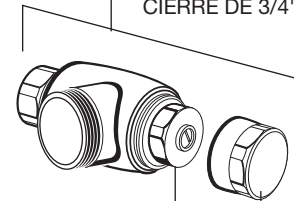

M964412-0020A
CONJUNTO DE LA VÁLVULA DE CONTRAFLUJO DE 3/4" PARA PREPARACIÓN DE 11-1/2" (220 mm)

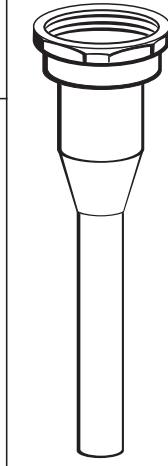

M952261-0020A
CONJUNTO DE TUBERÍA DE ENTRADA DE 3/4"

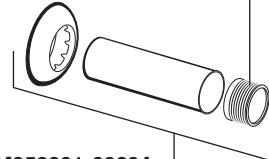

M970355-0020A
KIT DE REPARACIÓN DE LA VÁLVULA DE CIERRE

M924347-0020A
TAPA DE LA VÁLVULA DE CIERRE

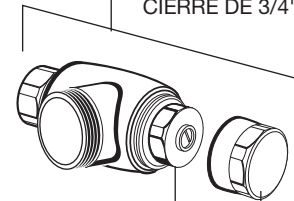

M952262-0020A
KIT DEL CHAPETÓN

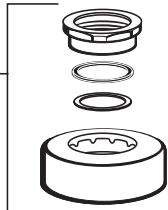

LÍNEA DE AYUDA DIRECTA
Si desea obtener información o tiene preguntas, llame sin cargo al (844) CRT-TEAM / (844) 278-8326
Los días de semana de 8:00 a.m. a 6:00 p.m. Hora normal del este.
EN MÉXICO: 01-800-839-1200

EN CANADÁ: 1-800-387-0369 (TORONTO 1-905-306-1093)
Los días de semana de 8:00 a.m. a 7:00 p.m. Hora normal del este.

Los nombres de producto mencionados en este documento son marcas de comercio de AS America, Inc. © 2019

Para obtener más información sobre los productos American Standard Selectronic™, visite nuestro sitio web: www.americanstandard-us.com o envíenos un correo electrónico a: CRTTEAM@lifixamericas.com

PART OF LIXIL

Válvula de Descarga Operada por Sensor Ultima™

Con operador de montaje lateral, diafragma

NÚMERO DE MODELO

6147SM

M909318-0070A
TAPA INTERIOR

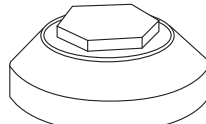

M954323-0070A
CONJUNTO DEL DIAFRAGMA 1.1 G/D



M954322-0070A

CONJUNTO DEL DIAFRAGMA 1.28 G/D

M954319-0070A

CONJUNTO DEL DIAFRAGMA 1.0/1.6 G/D

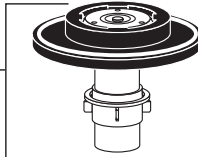

SMGODIA.002
OPERADOR DE MONTAJE LATERAL

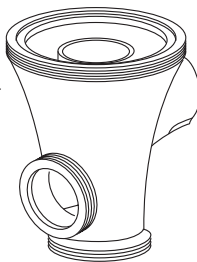
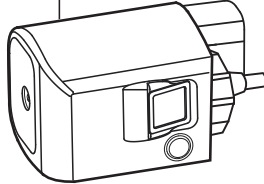

A912809-0070A
PIEZA POSTERIOR DE ANILLO O

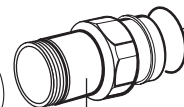

M964945-0020A
PIEZA POSTERIOR AJUSTABLE
(preparación de 4-1/4" a 5-1/4")

PIEZA POSTERIOR AJUSTABLE OPCIONAL
(se compra por separado)

M962836-0020A (preparación de 8-1/4" a 9-1/4")

M962835-0020A (preparación de 7-1/4" a 8-1/4")

M962834-0020A (preparación de 6-1/4" a 7-1/4")

M962833-0020A (preparación de 5-1/4" a 6-1/4")

M964402-0070A
KIT DE REPARACIÓN DE LA VÁLVULA DE CONTRAFLUJO DE BP ELEVADO



M964411-0020A
VACUUM BREAKER ASSEMBLY 11-1/2" (220 mm) ROUGH-IN



M964413-0020A
VACUUM BREAKER ASSEMBLY 27" (686 mm) ROUGH-IN

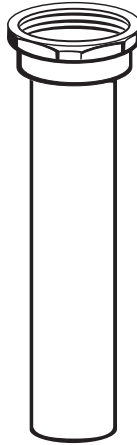

M952269-0020A
KIT DEL CHAPETÓN

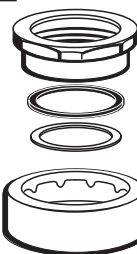

M962926-0070A
ADAPTADOR DE SOLDADURA DE 1"

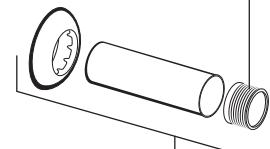

A955056-0020A
VÁLVULA DE CIERRE DE 1"

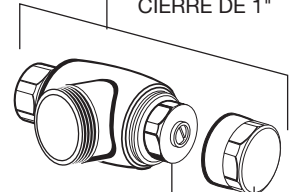

A955057-0020A
CONJUNTO DE TUBERÍA DE ENTRADA DE 1"

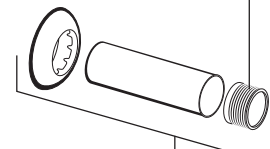

M970355-0020A
KIT DE REPARACIÓN DE LA VÁLVULA DE CIERRE

M924347-0020A
TAPA DE LA VÁLVULA DE CIERRE

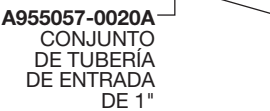

LÍNEA DE AYUDA DIRECTA
Si desea obtener información o tiene preguntas, llame sin cargo al (844) CRT-TEAM / (844) 278-8326
Los días de semana de 8:00 a.m. a 6:00 p.m. Hora normal del este.
EN MÉXICO: 01-800-839-1200
EN CANADÁ: 1-800-387-0369 (TORONTO 1-905-306-1093)
Los días de semana de 8:00 a.m. a 7:00 p.m. Hora normal del este.

Los nombres de producto mencionados en este documento son marcas de comercio de AS America, Inc. © 2019

Para obtener más información sobre los productos American Standard Selectronic®, visite nuestro sitio web: www.americanstandard-us.com o envíenos un correo electrónico a: CRTEAM@lixilamericas.com