



PFPSBVN SERIES PVC Solvent Weld Ball Valves

Product Features

- Working Non-Shock Pressure (1/2" – 2"): 150 psi @ 73°F
- Working Non-Shock Pressure (2-1/2" – 4") 100 psi @ 73°F
- Media Temperature Range: 32°F – 140°F
- Valve Port Opening: 1/2" – 3" full port design; 4" regular port design
- Low flow loss
- Socket diameter confirms to ASTM D2467
- Not for use with compressed air or gases
- Certified to: NSF/ANSI 372, NSF/ANSI 14, NSF/ANSI/CAN 61



PFPSBVND

No.	Part	Material	Pieces
1	Body	UPVC	1
2	Ball	UPVC	1
3	Stem (Only for 2-1/2"–4")	UPVC	1
4	Stem O-Ring	EPDM	1
5	Cap (Only for 1/2"–2")	ABS	1
6	Handle	ABS	1
7	Seat	EPDM	2
8	End Connector (Only for 2-1/2"–4")	UPVC	1

Dimensions (inches)

Model No.	Nom. Size	D1	d	b	P	L	D2	H	A
PFPSBVND	1/2	0.580	0.848	0.836	0.875	3.112	1.142	1.774	2.733
PFPSBVNF	3/4	0.780	1.058	1.046	1.000	3.389	1.381	1.919	3.155
PFPSBVNG	1	0.970	1.325	1.310	1.125	3.926	1.680	2.240	3.634
PFPSBVNH	1-1/4	1.250	1.670	1.655	1.250	4.449	2.054	2.484	4.112
PFPSBVNJ	1-1/2	1.510	1.912	1.894	1.375	5.130	2.316	2.886	4.401
PFPSBVNK	2	1.950	2.387	2.369	1.500	5.905	2.877	3.422	5.523
PFPSBVNL	2-1/2	2.550	2.889	2.868	1.750	7.638	3.780	5.550	7.480
PFPSBVNM	3	3.050	3.516	3.492	1.875	9.173	4.331	6.063	9.005
PFPSBVNP	4	3.910	4.518	4.491	2.250	11.000	5.350	6.700	10.790

1/2"–2"

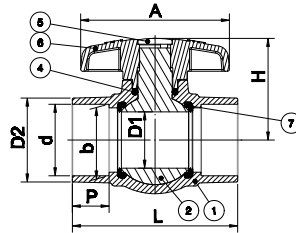

2-1/2"–4"

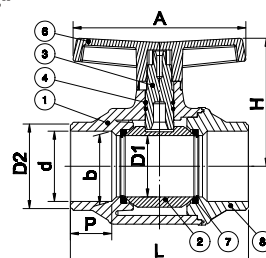

Warranty and Codes

This PROFLO product carries a 1-year limited warranty.

