



PFCBVN SERIES CPVC Ball Valves

Product Features

- Working Non-Shock Pressure: 100 psi @ 180°F
- Media Temperature Range: 32°F – 194°F
- Valve Port Opening: 1/2" – 3/4" full port design; 1" – 2" regular port design
- Solvent weld connection
- For use with hot or cold water
- Not for use with compressed air or gases
- Certified to: NSF/ANSI 372, NSF/ANSI 14, NSF/ANSI/CAN 61



PFCBVND

No.	Part	Material	Pieces
1	Body	CPVC	1
2	Ball	CPVC	1
3	Stem O-Ring	EPDM	1
4	Cap	ABS	1
5	Handle	ABS	1
6	Seat	PTFE	2

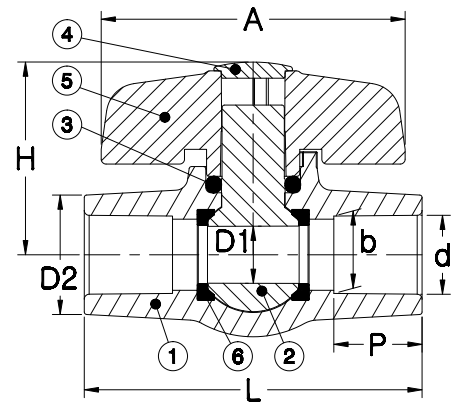

Dimensions (inches)

Model No.	Nom. Size	D1	d	b	P	D2	L	A	H
PFCBVND	1/2	0.492	0.633	0.619	0.500	0.965	2.701	2.441	1.327
PFCBVNF	3/4	0.716	0.884	0.870	0.700	1.248	3.120	2.807	1.791
PFCBVNG	1	0.748	1.135	1.121	0.900	1.512	3.551	2.988	2.185
PFCBVNH	1-1/4	.0984	1.386	1.372	1.100	1.740	4.024	3.528	2.402
PFCBVNJ	1-1/2	1.232	1.640	1.622	1.300	2.134	4.598	4.098	2.539
PFCBVNK	2	1.484	2.141	2.123	1.500	2.563	5.110	4.378	2.894

Warranty and Codes

This PROFLO product carries a 1-year limited warranty.

