



SKU(s): 429947

AMICI BARN DOOR HARDWARE INSTALLATION

BEFORE YOU BEGIN

We recommend consulting a professional if you are unfamiliar with installing door hardware. Signature Hardware accepts no liability for any damage to the hardware, door, walls, floor, or for personal injury during installation.

Observe all local building codes.

Unpack and inspect the items for shipping damage. If any damage is found, contact our Customer Relations team at 1-866-855-2284.

GETTING STARTED

- Ensure that you have gathered all the required materials that are needed for the installation.
- All fasteners must be mounted securely into solid wood studs, or wood blocking within the wall, for proper support.

TOOLS AND MATERIALS:

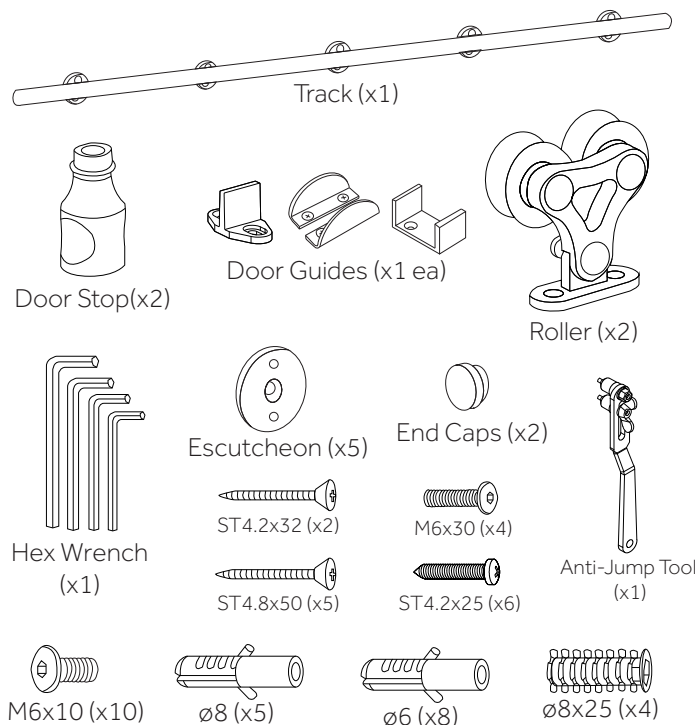
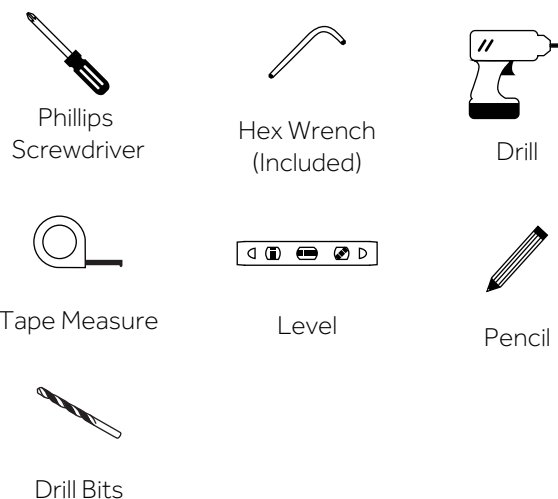

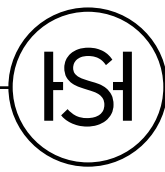

AMICI BARN DOOR HARDWARE INSTALLATION

INSTALLATION

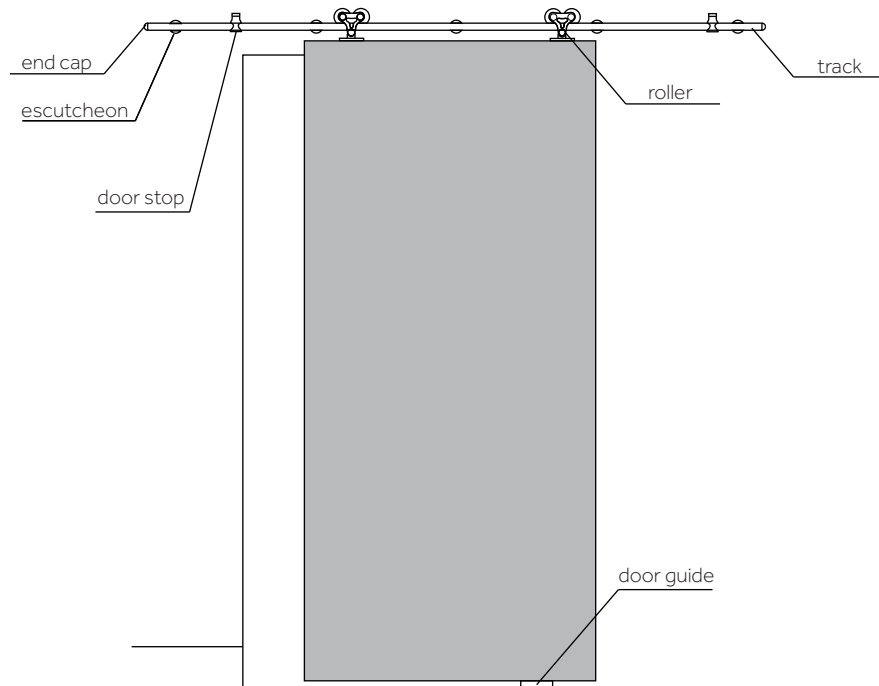
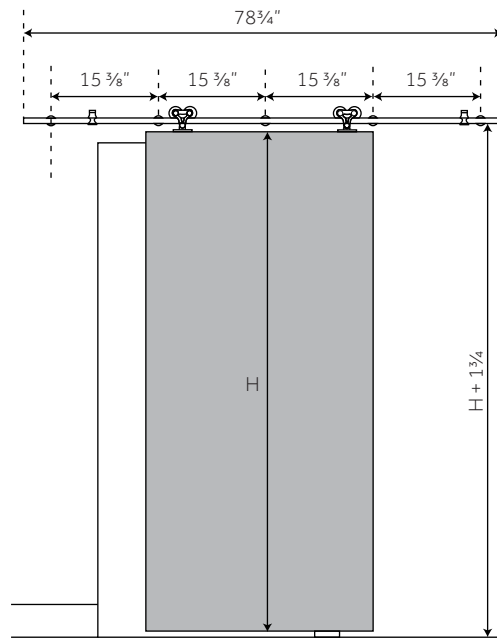



AMICI BARN DOOR HARDWARE INSTALLATION

1.

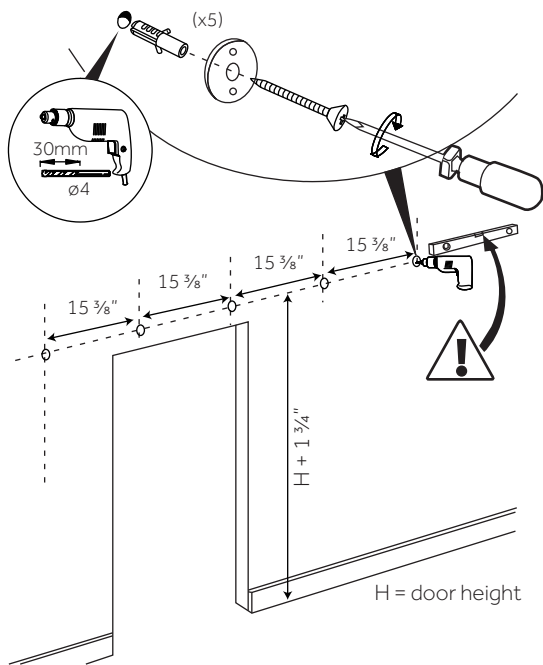

2.

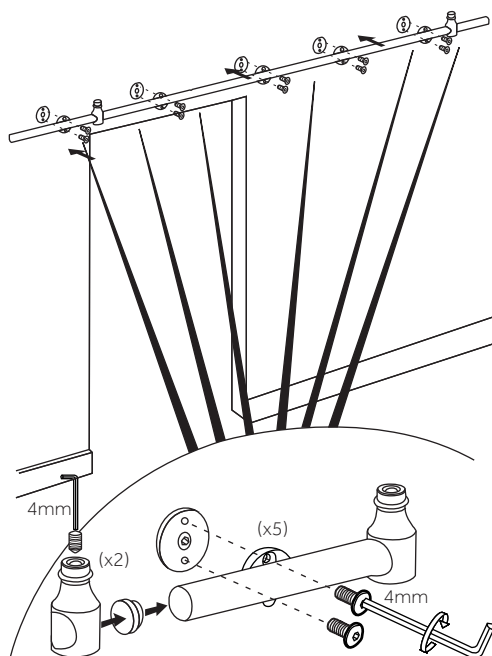

3. Remove anti-jump rollers. This will need to be reinstalled once door is hung.

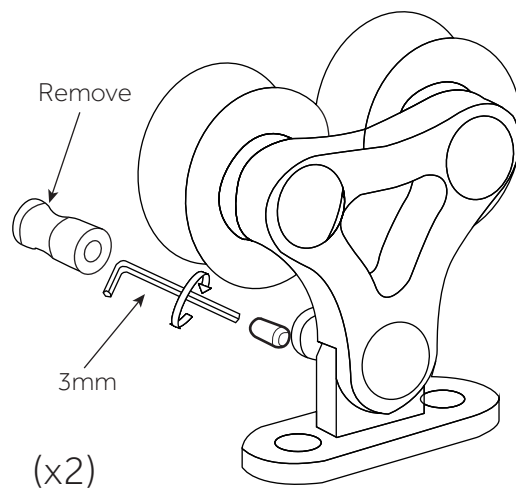

4. Determine a proper location on the top edge of the door to mount the rollers.

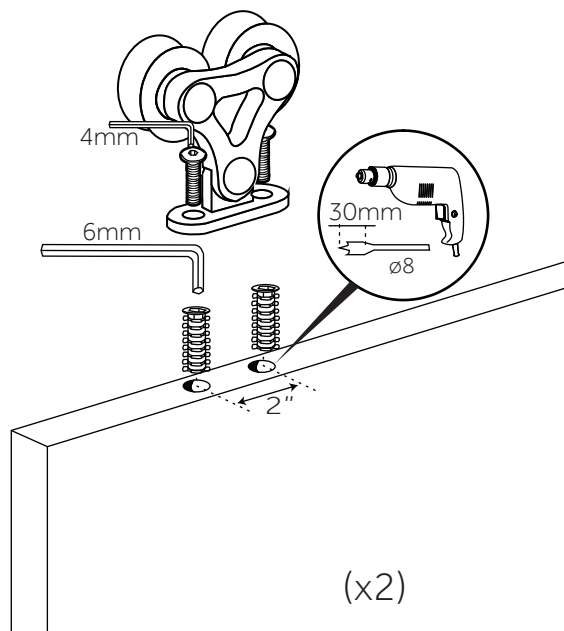



AMICI BARN DOOR HARDWARE INSTALLATION

5. Reinstall anti-jump rollers using the anti-jump tool provided.

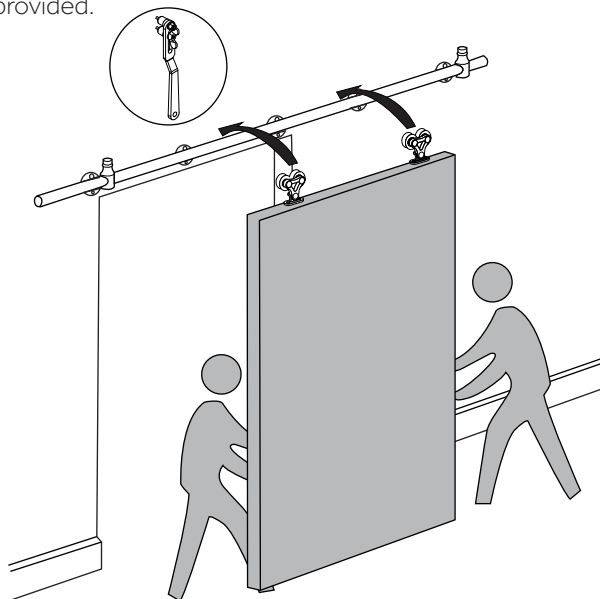

6. Install the door guide. For a door that has been notched on the bottom, use the concealed guide. For a door with standard thickness, use the U-shaped guide. For thicker doors, use the adjustable guide.

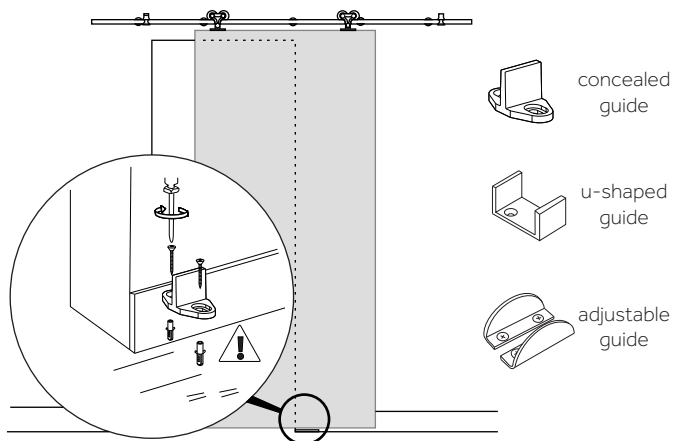

7.

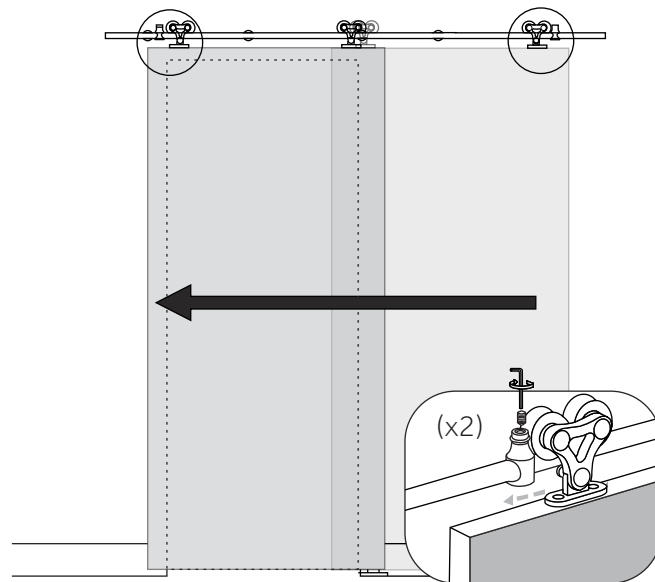

8.

