

DIMENSIONAL SPECIFICATIONS

STAINLESS STEEL ISO PATTERN FITTINGS 150 LB.

CAP (304)

Part #	Size (IN.)	Approx. Net WT. (LB.)	A	L
K416-02	1/8	0.03	0.71	0.51
K416-04	1/4	0.05	0.83	0.59
K416-06	3/8	0.07	0.94	0.67
K416-08	1/2	0.09	1.07	0.75
K416-12	3/4	0.16	1.38	0.87
K416-16	1	0.29	1.65	0.94
K416-20	1-1/4	0.45	2.05	1.06
K416-24	1-1/2	0.56	2.26	1.06
K416-32	2	0.85	2.73	1.26
K416-40	2-1/2	2.05	3.62	1.38
K416-48	3	2.82	4.17	1.50
K416-64	4	4.25	5.28	1.77

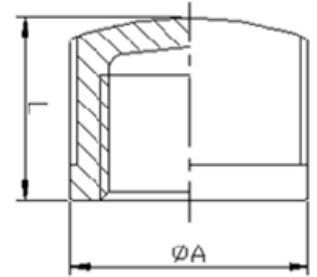

CAP (316)

Part #	Size (IN.)	Approx. Net WT. (LB.)	A	L
K616-02	1/8	0.03	0.71	0.51
K616-04	1/4	0.05	0.83	0.59
K616-06	3/8	0.07	0.94	0.67
K616-08	1/2	0.09	1.07	0.75
K616-12	3/4	0.16	1.38	0.87
K616-16	1	0.29	1.65	0.94
K616-20	1-1/4	0.45	2.05	1.06
K616-24	1-1/2	0.56	2.26	1.06
K616-32	2	0.85	2.73	1.26
K616-40	2-1/2	2.05	3.62	1.38
K616-48	3	2.82	4.17	1.50
K616-64	4	4.25	5.28	1.77

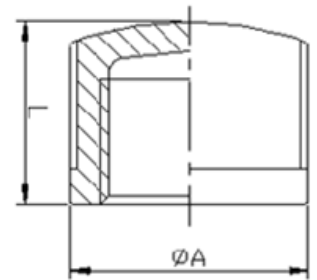

**MERIT
BRASS**

DIRECTING THE FLOW OF *Quality*