

LittleGIANT®

WATER FEATURES & POND PRODUCTS

PRODUCT CATALOG



littlegiant.com



Franklin Electric

TABLE OF CONTENTS

WATER PUMPS

Little Giant® Pumps	4
Wet Rotor Pumps	4
F-Series.....	4
FP-Series.....	6
Magnetic Drive Pumps	7
PES-Series.....	7
Direct Drive Pumps	8
PE-Series.....	8
Stainless Steel & Bronze.....	9
WGP-Series.....	10
WGFP-Series.....	11
Small Submersible	12
Helpful Information	13

FOUNTAINS & FEATURES

Disappearing Water Features	14
Basins, Vaults, & Fittings	14
Waterfall Weirs	15
Fountain Nozzles	16

FILTRATION

Mechanical filtration	17
Pump Pre-Filters.....	17
Skimmers.....	18
Biological filtration	19
Waterfall Filters.....	19

LIGHTING & CONTROLS

LED Lighting	20
LED EggLites	20
LED-K Lighting.....	20
Halogen Lighting	21
LVL Lighting	21

CONSTRUCTION

Virtual Pond Kits	22
Plumbing	23
Fittings.....	23
Liners & Accessories	24

POND CARE

Protection	25
Low Water Shut-Off	25
Fall & Winter	25
Pond Netting & Winter	25
Accessories	26
Aquatic Plant Baskets.....	26
Fish Nets	26
Replacement Parts	27

MERCHANDISING SYSTEM

Additional Product Lines	28
---------------------------------------	-----------

INDEX

Index of Items Alphabetically by Model	29
Index of Items Numerically by Item Number	31

For the most up-to-date product information, visit littlegiant.com.

Every effort has been made to ensure the accuracy of the information provided in this catalog. Little Giant reserves the right to change any information contained in this catalog without notice. Stenographic and clerical errors are subject to corrections.

FRANKLIN ELECTRIC COMPANY & LITTLE GIANT® PRODUCTS

Franklin Electric is a global leader in the production and marketing of systems and components that move water and automotive fuels. A world-renowned technical leader in its specialties, Franklin Electric serves residential, commercial, agricultural, industrial, municipal, and fueling customers.

Staffed by over 5,000 dedicated employees worldwide, Franklin Electric has manufacturing and distribution facilities located in 18 countries.

Little Giant® products are delivered worldwide without sacrificing personal service. Our unique customer assistance program matches highly trained customer service professionals with specific geographic regions, so they can maintain a thorough knowledge of a territory and its unique needs based on weather, trends, and more. With on-site engineers, we have the advantage in the market for developing new products, resolving issues, and general innovation.

Quality, availability, service, innovation, and cost bring value to Little Giant® products. An extensive market research on customer preferences of product features, informative marketing materials, and unique programs are the business components that keep customer confidence levels high.

Franklin Electric engineers design products for easy installation, high performance, long life, and exceptional value.

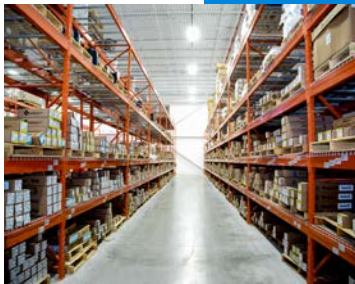

Our 200,000 sq ft centrally-located warehouse enables fast and complete fill rates.

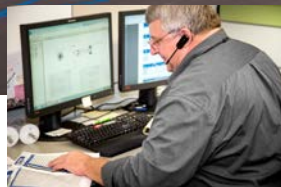

Responsive employees are ready to offer expert assistance.

METRIC CONVERSIONS

Metric Conversions: We are honored to offer our products to multiple countries to support all of our customers. All of the formulas and equations throughout the catalog are in U.S. units. If you prefer to use metric units, we offer conversion formulas on the right. The letters and symbols in parentheses are other ways that word is substituted.

Equations		
Distance	Feet (ft) (') x 0.3048 = Meter	Meter x 3.28 = Feet (ft) (')
	Inches (") x 2.54 = Centimeter	Centimeter x 0.39 = Inches (")
Volume	Gallons (g) x 3.78 = Liter	Liter x 0.264 = Gallons (g)
Pressure	PSI x 0.07 = Bar	Bar x 14.5 = PSI

STEP-BY-STEP SIZING GUIDE

Every pond and fountain has different sizing requirements for the equipment needed. For your feature to be enjoyed with minimal maintenance, it is important to select a properly sized pump, filter, liner, etc. Visit our website, www.littlegiant.com, for additional information and to download and print a sizing guide grid. All measurements are in feet and gallons.

1. The first step in any feature is to size the liner required for containment. Use the same formula for both the width and depth of the liner:

$$\text{Length} + (2 \times \text{Depth}) + 2 = \text{Length of liner}$$

$$\text{Width} + (2 \times \text{Depth}) + 2 = \text{Width of liner}$$

2. Now that the container is sized, the next step in sizing any feature is determining the amount of water you will have. To calculate gallons, use this formula:

$$\text{Length (ft)} \times \text{Width (ft)} \times \text{Depth (ft)} \times 7.48 = \text{Gallons}$$

3. All of the equipment for a pond or water garden is sized by the number of gallons that it contains. By flowing water at least once an hour through the filtration system, the amount of required maintenance is reduced. The flow down the stream and waterfall needs are calculated so it appears natural. Equipment selection is based on the size of the flow.

A 3,000 gallon pond will require products that can handle at least 3000 gallons per hour of flow.

$$\text{Width of stream (waterfall) ft} \times 1200 \text{ gph} = \text{Stream flow to appear natural}$$

4. The most important component of a feature is the pump. It is the heart of the pond, circulating the water through the filter and back down the stream into the pond. To determine the correct pump, the height from which it must push the water needs calculated.

Measure vertical distance from top of water level to discharge point (top of waterfall)

5. Now that the vertical distance the pump must push the water is known, a pump can be selected. There are multiple ways to select pumps and multiple styles of pumps to choose from. The primary method is a pump curve. When viewing a pump curve, the flow rate is on the top and bottom, and the height-to-push is on the sides.

A. Select your required flow rate on the chart, drawing a line up.

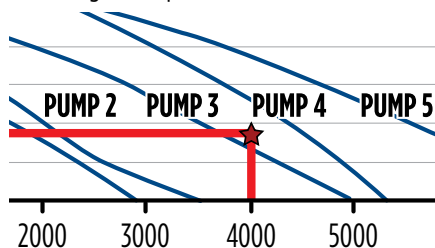

B. Select your height, drawing a line from the right.

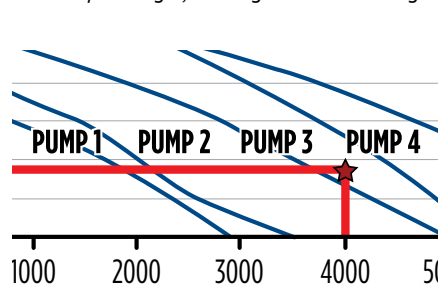

C. Choose the pump with a curve that is just above that point (example below, select Pump 4).

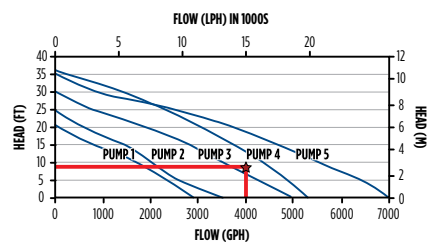

Use the information you calculated to browse through our product offering and select the best quality products for years of future enjoyment. Should you have any product-related questions, please visit our website at www.littlegiant.com or contact our technical support team at 888.956.0000.



LITTLE GIANT® PUMPS

Franklin Electric has developed the broadest and most reliable line of Little Giant® pumps on the market. Pumps are the heart of any water feature, because circulation is the key to a healthy aquatic environment. To facilitate that circulation, Little Giant® pumps are available in a complete range of flow rates. Each exceptionally-engineered pump features rugged construction to install easily and last for years.

F-SERIES PUMPS



WET ROTOR PUMPS - F-SERIES

Our wet rotor canned motor pumps are designed with multi-purpose flexibility right into the pump. They can be used submersed or externally, mounted vertically or horizontally. With MNPT threads and fittings built in, attaching fittings is a breeze. The included pre-filter makes these pumps built for flexibility and durability in any decorative water application.



FEATURES

- Constructed without mechanical seal or oil
- Screw attachment to hold screen in place
- Rope/cable loop for deep installation retrieval
- Modular screen ability

ORDERING INFORMATION

F-Series	Item No.	Amps	Watts	Cord (ft)	Submerged Use	Inline Use	Discharge & Inlet MNPT & SPIG	Gallons Per Hour (GPH) at height							Shut-off (ft)
								0'	1'	5'	10'	15'	20'	25'	
F10-1200	566724	1.3	157	20'	✓	✓	1.5"	1295	1255	1105	840	415	95	-	22'
F20-2700	566725	1.25	147	20'	✓	✓	1.5"	2770	2705	2095	960	-	-	-	14.9'
F30-4000	566726	1.82	215	20'	✓	✓	2"	4060	3850	2900	1920	730	-	-	18.8'
F40-5500	566727	3.0	360	20'	✓	✓	2"	5540	5255	4235	2895	1955	415	-	21.3'
F50-5000	566728	3.6	413	20'	✓	✓	2"	5020	4890	4330	3600	2800	1940	885	28.5'
F70-7300	566729	5.5	660	40'	✓	✓	2"	7365	7095	5930	4665	3195	2040	725	28'

DIMENSIONS

Dimensions (in)	A	B	C	D
F10-1200	9.93	5.71	7.54	3.40
F20-2700	9.93	5.71	7.54	3.40
F30-4000	13.25	6.10	8.00	5.60
F40-5500	13.25	6.10	8.00	5.60
F50-5000	13.25	6.10	8.00	5.60
F70-7300	13.25	6.10	8.00	5.60

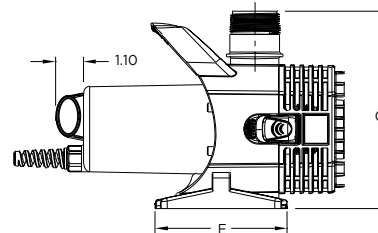
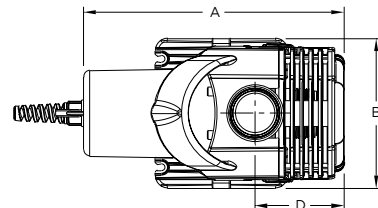

PERFORMANCE

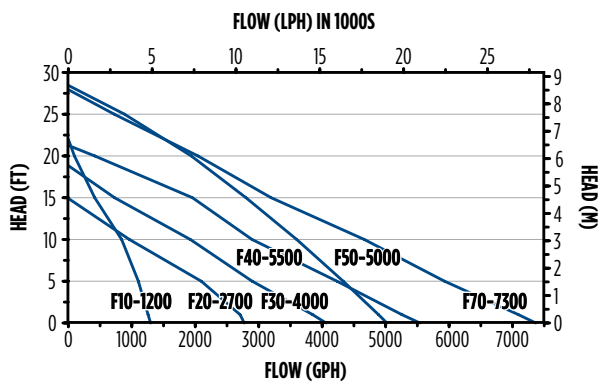

* Pump performance at 120 VAC with no intake screen



WET ROTOR PUMPS - FP-SERIES

Our wet rotor water feature pumps are energy efficient and ideal for powering water features and pond filtration systems with flow requirements from 1,000 gph to 8,100 gph. These pumps are rated for continuous duty to operate in the most rigorous applications.



FP1



FP9



FEATURES

- Fitting adapters included
- Use with a screen or skimmer recommended
- Energy efficient
- Can be used externally or submerged

ORDERING INFORMATION

FP-Series	Item No.	Amps	Watts	Cord (ft)	Submerged Use	Inline Use	Inlet FNPT	Discharge FNPT	Gallons Per Hour (GPH) @ Height					Shut-off (ft)
									5'	10'	15'	20'	25'	
FP1	566132	0.9	106	26	✓	✓	1-1/4"	1-1/4"	1000	390	-	-	-	14
FP2	566133	1.45	167	26	✓	✓	1-1/2"	1-1/2"	2220	1210	400	-	-	16
FP3	566134	1.85	226	26	✓	✓	2"	2"	3200	1640	690	-	-	17
FP6	566135	4.6	557	26	✓	✓	2"	1-1/2"	5760	4380	3000	1730	350	27
FP9	566137	6.5	730	26	✓	✓	2"	2"	8100	6580	4860	3290	1930	31

DIMENSIONS

Dimensions (in)	A	B	C	D	E	F
FP1	9.2	3.8	7.7	1.6	5.7	1.0
FP2	9.5	3.8	7.7	1.7	5.7	0.85
FP3	10.3	3.8	7.8	2.1	5.7	1.0
FP6	10.0	4.4	9.6	1.8	9.5	1.7
FP9	10.0	4.4	9.6	2.1	9.5	1.7

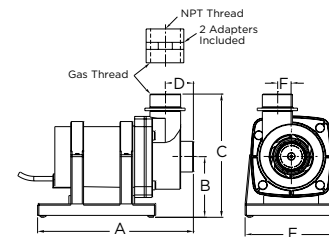

PERFORMANCE

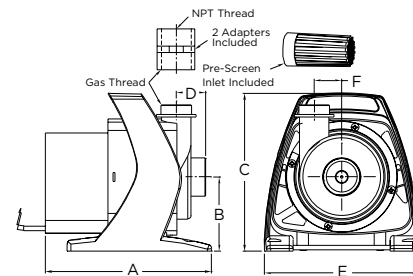
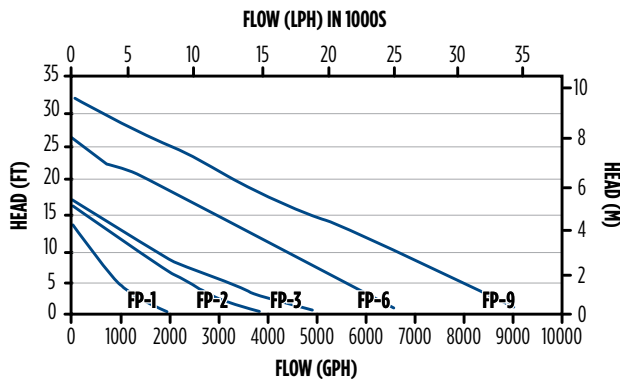

FP1, FP2, FP3, FP6, FP9

MAGNETIC DRIVE PUMPS - PES-SERIES

Designed to operate continuously with minimal energy consumption, magnetic drive pumps offer a corrosion-resistant body specifically for submersible use. Easy to install and maintain, magnetic drive pumps are ideal for a variety of applications.



FEATURES

- Built-in adjustable flow control valve
- Ceramic shaft for longer life
- Great for tabletop features

ORDERING INFORMATION

PES-Series	Item No.	Amps	Watts	Cord (ft)	Submerged Use	Discharge Barb	Gallons Per Hour (GPH) @ Height				Shut-off (ft)
							1'	3'	5'	10'	
PES-40-PW	566713	0.03	2.5	6'	✓	1/2", 3/8"	45	-	-	-	2.1
PES-80-PW	566714	0.14	8	6'	✓	1/2", 3/8"	77	20	-	-	3.5
PES-130-PW	566716	0.23	11	6'	✓	1/2", 5/8"	130	85	-	-	5.5
PES-290-PW	566717	0.4	23	6'	✓	1/2", 5/8"	300	180	115	-	7.25
PES-380-PW	566718	0.64	33	15'	✓	1/2", 5/8"	350	285	180	-	7
PES-700-PW	566720	0.75	57	15'	✓	3/4"	725	560	400	-	8.25
PES-800-PW	566721	0.95	109	15'	✓	3/4"	875	750	625	175	11.75
PES-1000-PW	566722	1.4	160	15'	✓	1"	1150	965	775	200	11.75

DIMENSIONS

Dimensions (in)	A	B	C
PES-40-PW	1.9	1.16	1.7
PES-80-PW	2.8	2.3	1.9
PES-130-PW	3.5	3.2	2.8
PES-290-PW	3.7	3.6	2.7
PES-380-PW	4.2	3.6	2.7
PES-700-PW	5.3	4	4.3
PES-800-PW	5.3	4	4.3
PES-1000-PW	5.7	4.4	4.3

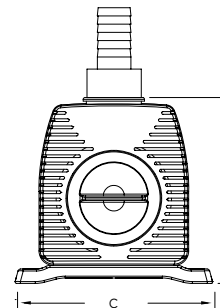

PERFORMANCE

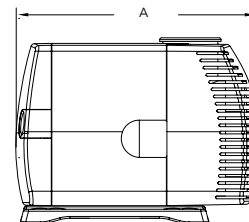
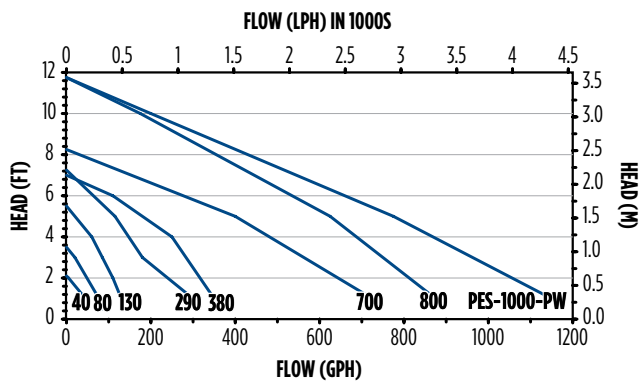

DIRECT DRIVE PUMPS - PE-SERIES

Designed to operate continuously, direct drive pumps produce greater starting torque and more pressure than comparable magnetic drive pumps. Direct drive pumps are ideal for statuary fountains. Pre-filter is included to protect the pump.



FEATURES

- Hooded volute option for lower intake (fountain)
- Hooded volute indicated by "H"
- Compact design



ORDERING INFORMATION

PE-Series	Item No.	Amps	Watts	Cord (ft)	Submerged Use	Discharge MNPT	Gallons Per Hour (GPH) @ Height				Shut-off (ft)
							1'	3'	5'	10'	
PE-1H-PW	566604	0.6	36	6'	✓	1/4"	170	140	100	-	7
PE-1F-PW	566608	0.6	36	15'	✓	1/4"	170	140	90	-	7
PE-2H-PW	566609	0.8	47	6'	✓	1/4"	300	255	205	70	12.2
PE-2F-PW	566611	0.8	47	15'	✓	1/4"	300	270	240	130	12.2
PE-2.5F-PW	566612	1.4	80	15'	✓	1/2"	475	440	395	205	13.4

DIMENSIONS

Dimensions (in)	A	B	C	D	E
PE-1H-PW	3.48	3.58	2.75	-	-
PE-1F-PW	4.9	3.6	2.8	0.9	1.89
PE-2H-PW	4.83	4.15	2.75	-	-
PE-2F-PW	5.6	4.2	2.8	0.9	2.38
PE-2.5F-PW	5.6	4.02	2.9	1.06	2.24

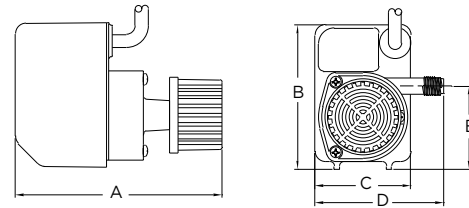

PE-2.5-PW, PE-2F-PW, PE-1F-PW

PERFORMANCE

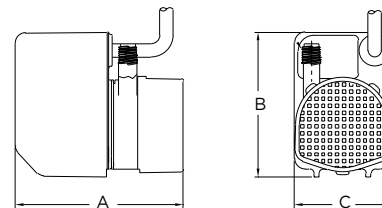
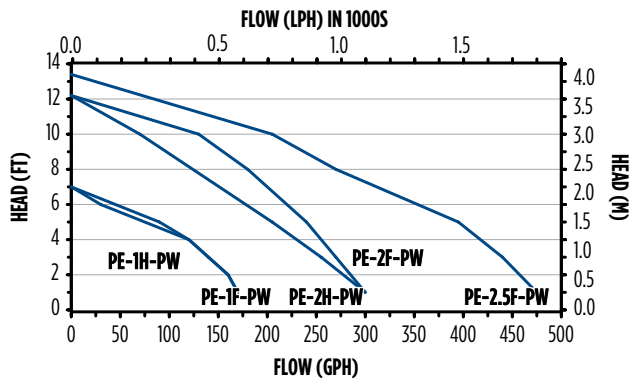

PE-2H-PW, PE-1H-PW

DIRECT DRIVE PUMPS - STAINLESS STEEL & BRONZE

Our premium stainless steel and bronze pumps come in four models and are a favorite in the industry. These trouble-free pumps can be used in fresh, salt, chlorinated or brominated water and can even be used in hot water up to 110 °F. These versatile pumps can be used submerged or in open air below water level for ponds, water gardens, medium to large fountains, water displays, waterfalls, streams, and for aeration.



S900T



With Pre-Screen

FEATURES

- Made in the U.S.A.
- Quiet operation
- Mounting stand option

ORDERING INFORMATION

S-Series	Item No.	Amps	Watts	Cord (ft)	Submerged Use	Inline Use	Pre-Screen Included	Dis-charge MNPT	Intake MNPT	Gallons Per Hour (GPH) @ Height				Shut-off (ft)
										1'	5'	10'	15'	
S320T-20	517003	1.2	89	20'	✓	✓	✓	1/4"	1/2"	290	255	163	-	13.5
S580T-20	517006	2.2	203	20'	✓	✓		1/2"	3/4"	755	590	320	-	12
S900T-20	517009	2.5	234	20'	✓	✓		1/2"	3/4"	810	667	425	-	14
S1200T-20	517012	3.4	255	20'	✓	✓		1/2"	3/4"	868	745	580	240	18

ACCESSORIES

Stainless Steel & Bronze Pump Accessories	Item No.	Amount
SPB1 - Positioning Bracket Fits S580, S900, S1200	517500	1 per pack



DIMENSIONS

Dimensions (in)	A	B	C	D	E	F	G MNPT	H MNPT
S320T	4.0	4.5	3.0	1.4	2.36	0.3	1/2"	1/4"
S580T	4.5	6.5	4.7	2.25	2.75	0.5	3/4"	1/2"
S900T	4.5	6.5	4.7	2.25	2.75	0.5	3/4"	1/2"
S1200T	4.5	6.5	4.7	2.25	2.75	0.5	3/4"	1/2"

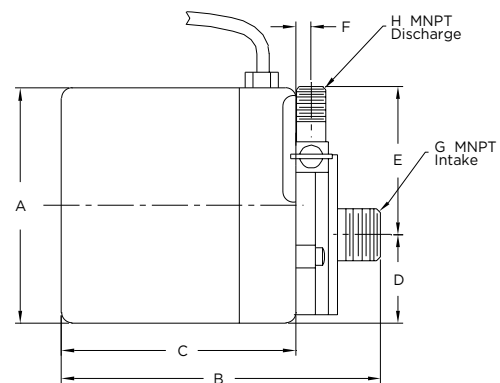

PERFORMANCE

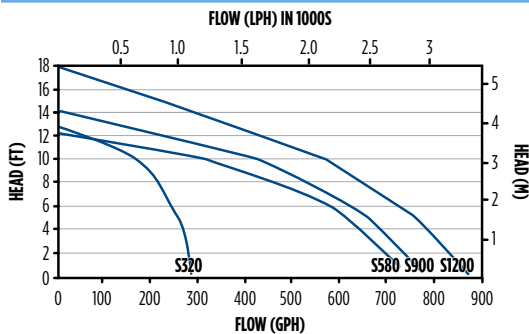

DIRECT DRIVE PUMPS - WGP-SERIES

Efficient, oil-less, direct-drive, dual-discharge pumps produce greater pressure, so each can serve two water features simultaneously. Installed either vertically or horizontally, the corrosion-resistant submersible body is designed for non-potable, continuous operation.



FEATURES

- Use vertically or horizontally
- Removable pre-filter for cleaning
- Ideal for filtration, waterfall, and streams

ORDERING INFORMATION

WGP Series	Item No.	Amps	Watts	Cord (ft)	Submerged Use	Discharge FNPT	Gallons Per Hour (GPH) @ Height						Shut-off (ft)
							1'	5'	10'	15'	20'	25'	
WGP-65-PW	566409	2	230	16'	✓	1-1/4"	1900	1250	785	325	-	-	20
WGP-80-PW	566417	6.3	700	16'	✓	1-1/4"	3500	3200	2700	2100	1300	695	29.5
WGP-95-PW	566407	6.3	700	16'	✓	1-1/4"	4280	4000	3500	2850	2200	1370	30

DIMENSIONS

Dimensions (in)	A	B	C
WGP-65-PW	9.6	8.1	6.35
WGP-80-PW	11.0	8.1	6.35
WGP-95-PW	11.0	8.1	6.35

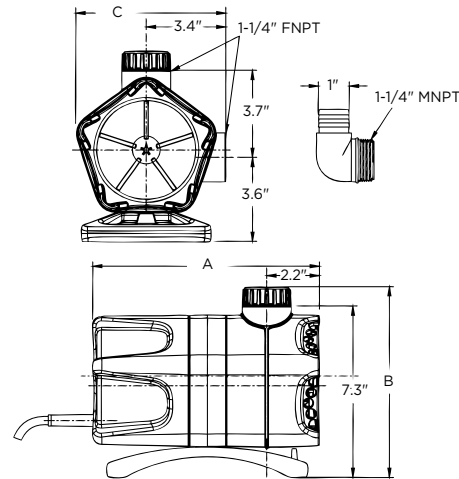

PERFORMANCE

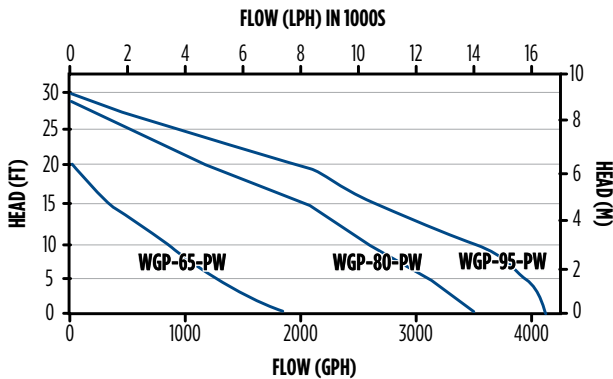

DIRECT DRIVE PUMPS - WGFP-SERIES

Constructed with stainless steel, cast iron and durable thermoplastic, our solids-handling submersible water feature pumps meet the rigorous demands of the most impressive water features. This year we have added a larger size to meet all of your decorative water needs.



FEATURES

- Designed for water features
- Dual seals for added protection in larger models
- Great as replacement pump and for new construction

ORDERING INFORMATION

WGFP Series	Item No.	Amps	Watts	Volts	Cord (ft)	Submerged Use	Discharge FNPT	Gallons Per Hour (GPH) @ Height								Solids Diameter	Shut-off (ft)
								5'	10'	15'	20'	25'	30'	35'	40'		
WGFP-75	566069	8	847	115 V	19'	✓	2"	4890	4350	3750	3070	2262	-	-	-	1.38"	36
WGFP-100	566070	12	1210	115 V	19'	✓	2"	6400	5500	4700	3700	2500	-	-	-	1.35"	35
WGFP-150	566071	11	1210	115 V	19'	✓	3"	9750	8200	6500	4600	2200	-	-	-	0.75"	32
WGFP-200	566072	9	2085	230 V	19'	✓	3"	16000	15000	13410	11575	9775	7645	5610	3120	0.75"	45

DIMENSIONS

Dimensions (in)	A	B	C	D	E
WGFP-75	14.44	3.88	8.78	4.53	5.83
WGFP-100	17.35	4.05	10.29	5.18	6.30
WGFP-150	18.50	5.00	11.75	6.50	7.50
WGFP-200	20.31	5.13	11.71	5.96	7.50

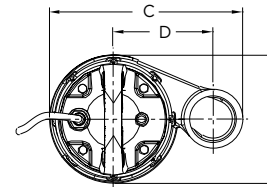

PERFORMANCE

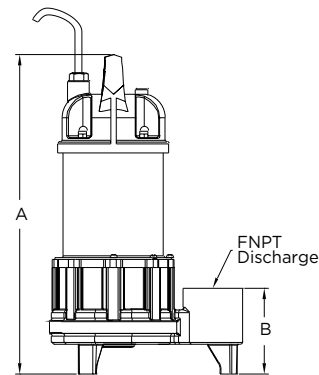
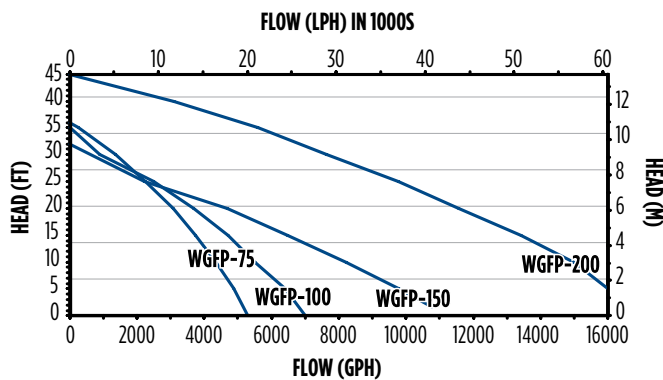

SMALL SUBMERSIBLE

Our Little Giant® pumps are designed for continuous circulation of statuary fountains. Made with some of the industry's most durable materials, our pumps reach peak performance when completely submerged.



FEATURES

- Oil-filled for cooling
- Prescreen included for protection
- Assorted options for every feature

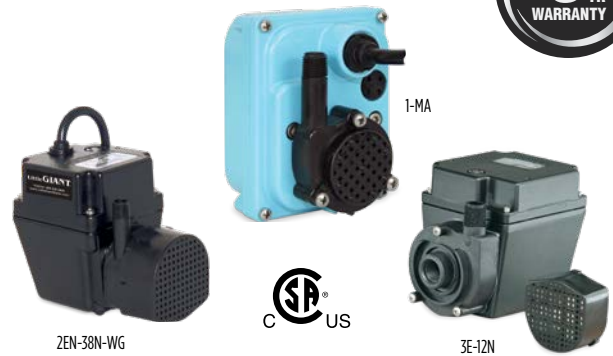

ORDERING INFORMATION

LG Small Submersibles	Item No.	Amps	Watts	Cord (ft)	Submerged Use	Discharge	Gallons Per Hour (GPH) @ Height					Shut-off (ft)
							1'	3'	5'	10'	15'	
#1	501004	1.1	70	6'	✓	1/4"	205	168	120	-	-	7.4
1-MA	521204	1.1	70	6'	✓	1/4"	170	140	100	-	-	7
2EN-38N-WG	502375	1.7	100	15'	✓	1/4"	300	255	205	-	-	11.8
3E-12N	503375	3.2	220	15'	✓	1/2"	500	435	337	210	65	17.3
P-AAA	523375	0.5	30	15'	✓	1/4"	120	70	-	-	-	4.6

DIMENSIONS

Dimensions (in)	A	B	C
#1	4.30	3.70	4.10
1-MA	4.30	3.30	3.50
2EN-38N-WG	4.64	3.50	5.55
3E-12N	5.50	4.50	7.00
P-AAA	3.90	3.90	3.00

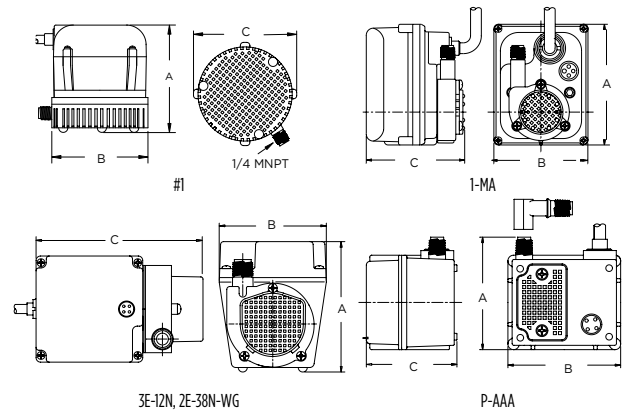

PERFORMANCE

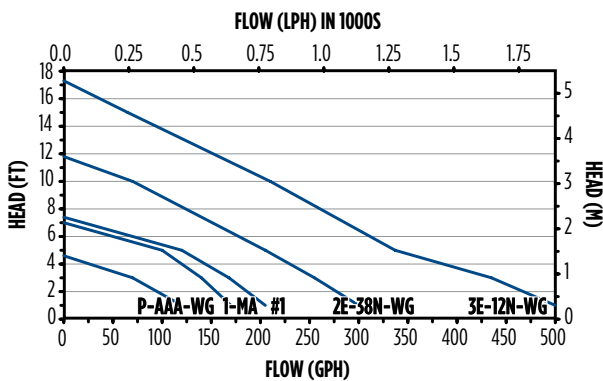

HELPFUL INFORMATION

PUMP SELECTION GUIDE BY FLOW RATE

Model	Item No.	Sub	In Line	Volts	Flow @ Head (GPH)					Shut-off	Watts	Electric Cost (Mo.)	Warr.
					5'	10'	15'	20'	25'				
PES-800-PW	566721	X		115	625	175	—	—	—	11.75'	85	\$5.64	3
PES-1000-PW	566722	X		115	775	200	—	—	—	11.75'	110	\$4.77	3
FP1	566132	X	X	115	1000	390	—	—	—	14'	106	\$7.72	5
F10	566724	X	X	115	1103	840	416	96	—	22'	157	\$10.08	2
WGP-65-PW	566409	X		115	1250	800	300	—	—	20'	230	\$15.77	3
F20	566725	X	X	115	2095	961	—	—	—	15'	147	\$10.22	2
FP2	566133	X	X	115	2220	1210	400	—	—	16'	167	\$11.93	5
PWM2600	PWM2600	X		115	1550	0	—	—	—	10'	164	\$10.49	1
FP30	566726	X	X	115	2897	1922	729	—	—	19'	215	\$18.14	2
FP3	566134	X	X	115	3200	1640	690	—	—	17'	226	\$16.15	5
WGP-80-PW	566417	X		115	3200	2700	2100	1300	695	29.5'	675	\$36.11	3
PWM3900	PWM3900	X		115	2700	1440	0	—	—	12.7'	260	\$19.04	1
PWM5200	PWM5200	X		115	3480	2460	1080	0	—	20'	506	\$28.18	1
F40	566727	X	X	115	4233	2894	1956	416	—	21.3'	520	\$22.90	2
WGP-95-PW	566407	X		115	4000	3500	2850	2200	1370	30'	700	\$33.92	3
F50	566728	X	X	115	4332	3599	2800	1938	885	28.5'	413	\$33.70	2
WGFP-75	566069	X		115	4900	4350	3750	3050	2250	36'	847	\$50.38	2
FP6	566135	X	X	115	5760	4380	3000	1730	350	27'	557	\$37.56	5
F70	566729	X	X	115	5930	4665	3196	2042	723	28'	660	\$39.74	2
WGFP-100	566070	X		115	6400	5500	4700	3700	2500	35'	1210	\$68.09	2
FP9	566137	X	X	115	8100	6580	4860	3290	1930	31'	730	\$52.24	5
WGFP 150	566071	X		115	9750	8200	6500	4600	2200	32'	1210	\$86.40	2
WGFP 200	566072	X		230	16000	15000	13410	11575	9775	45'	1210	\$149.98	2

NOTE: The Good, Better, Best color code illustrates how pump efficiency changes throughout the performance range of the pump.

* = Monthly electric cost calculated at Best Efficiency Point of Pump at 10 cents/kwh operating 24 hours, 7 days a week

GOOD

BETTER

BEST

RECOMMENDED MAXIMUM FLOW RATES

Pipe Diameter	Gallons Per Hour (GPH)	Gallons Per Minute (GPM)
3/4"	750	12.5
1"	1000	17
1-1/4"	2100	35
1-1/2"	3000	50
2"	4800	80
3"	9000	150
4"	16000	267

HELPFUL FORMULAS

To convert pressure to head height
Pressure (PSI) x 2.31 = Head Height (ft)
To convert head height to pressure
Head Height (ft) x 0.434 = Pressure (PSI)
To determine the gallons in a circular feature
0.79 x Diameter (ft) x Diameter (ft) x Depth (ft) x 7.48 = Gallons
To determine the approximate operating cost of running 24 hours a day
Watts x 0.072 = Estimated Monthly Operation Cost (at \$0.10/Kwh)

DISAPPEARING WATER FEATURES - BASINS & VAULTS

Little Giant® heavy-duty disappearing water feature basins are perfect for in-ground installations. Our basins are ideal for smaller applications when you want the soothing sounds of water but are limited on space. Basins sit flush with the ground, and the sectioned access plates make maintenance a breeze. Cover your basin with a wide variety of rocks or pottery (not included) for a disappearing water effect. Add your favorite container such as a ceramic or stone vase, and a pump (we recommend the PES series for this application) to build a stunning disappearing water feature. A great weekend project!



ORDERING INFORMATION

Basins, Vaults, & Fittings	Item No.	Dimensions (in)	Advantages
DFB36	566517	36" W x 36" L x 10.8" H	Supports up to 2000 lbs
DFB36PP	566559	-	Pallet includes (5) 36" basins
DFB44	566558	44" W x 44" L x 11" H	Supports up to 3000 lbs
DFB44PP	566560	-	Pallet includes (5) 44" basins
SF	566410	19" W x 19" L x 22" H	Pump vault for easy pump access

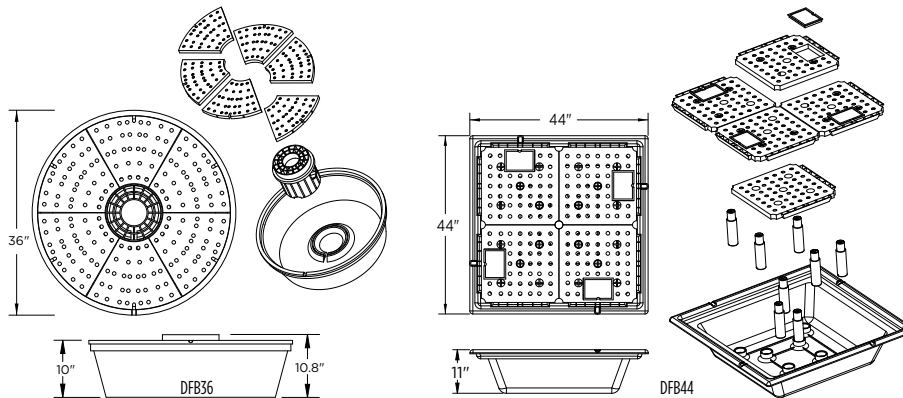

FOUNTAINS & FEATURES

DISAPPEARING WATER FEATURES - WATERFALL WEIRS

Waterfall weirs allow you to create a smooth beginning to any stream or waterfall. They install easily within or outside the liner. SPW comes with filter media, and all models come with plumbing attachments.



ORDERING INFORMATION

Waterfall Weirs	Item No.	Dimensions (in)	Max. Flow Rate	Weir Width
SPW10	517202	11" x 11-1/2" x 10-1/2"	1000 gph	10"
SPW18	517203	19" x 11" x 10-1/2"	4000 gph	18"
WFW	566239	9.5" H X 13" D	6000 gph	7.75"

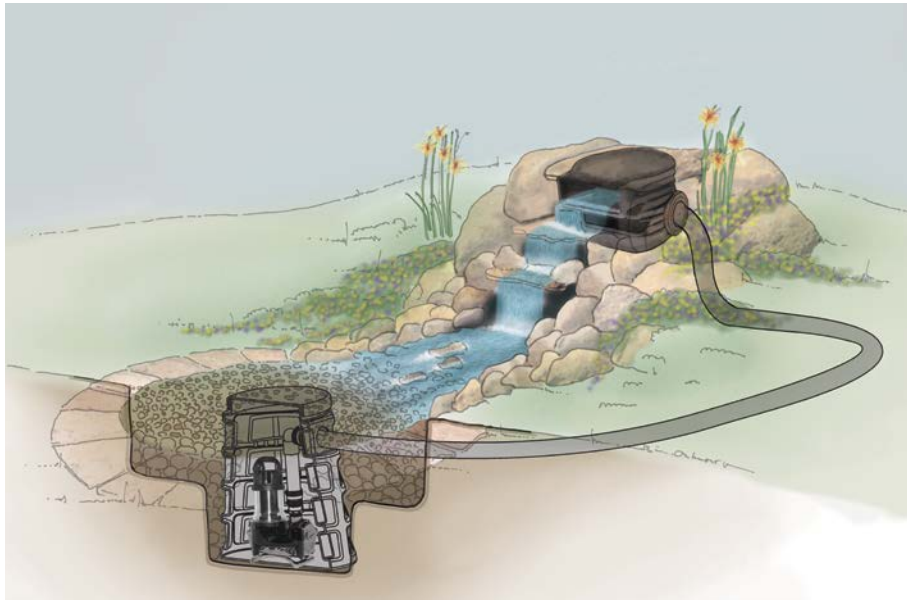
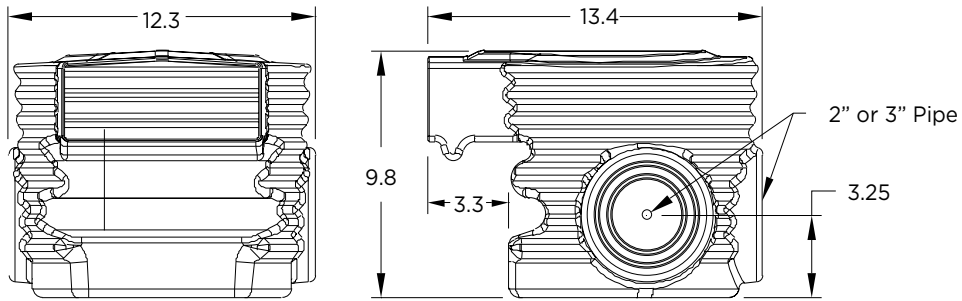

FOUNTAIN NOZZLE

The most appealing aspect of a water garden is the tranquil sights and sounds of moving water. We offer this fountain nozzle to create a unique effect in your customer's pond. This nozzle is easy to use and designed to work with a wide selection of Little Giant® pumps.



ORDERING INFORMATION

Fountain Nozzles	Item No.	Inlet	Advantages
Ring Jet RJ21	517200	1/2" FNPT	<ul style="list-style-type: none"> 17" diameter with 21 adjustable outward, inward or spiral spray pattern jet nozzles

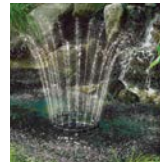

Ring Jet Alone

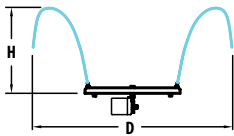

- 400 GPH = 4.5' H x 8' D
- 900 GPH = 9' H x 11' D
- 1500 GPH = 11' H x 19' D

MECHANICAL FILTRATION - PUMP PRE-FILTERS

Mechanical filters clean the water before it enters the pump, ensuring your pump runs more efficiently and effectively, and with less maintenance. Easy-to-use replacement media takes the hassle out of filter maintenance.

FEATURES

- Extends pump life
- Multiple sizes
- Simple replacement media

ORDERING INFORMATION

Pump Pre-Filters	Item No.	Inlet
PF-AD-PW	566107	1/2" push on
CFS-170T	517100	1" FNPT
CFS-155T	517506	1/2" and 3/4" FNPT
CFS-100	517505	1/2" push on

Replacement Filter Pads	Item No.	Included
FK-SBF-RP-PW	566111	1 coarse and 1 fine filter pad
SBF-1-RP-PW	566113	1 coarse and 1 fine filter pad
PF-RP-PW	566109	1 filter pad
CFS-955	517101	1 filter pad

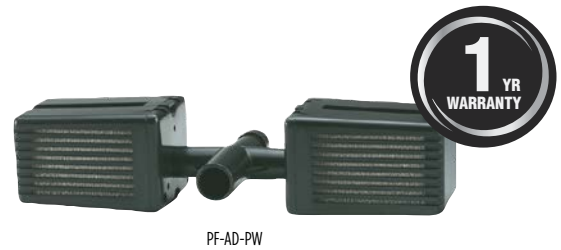

MECHANICAL FILTRATION - SKIMMERS

Little Giant® skimmers are engineered to encourage balanced ecosystems in new or existing ponds. These durable skimmers improve surface cleaning with an easy flow-through design that both simplifies installation and minimizes maintenance.



FEATURES

- Two stages of filtration provided
- Multiple sizes fit every feature

ORDERING INFORMATION

Skimmers	Item No.	Dimensions (in)			Max. Flow
		A	B	C	
SK2.5	566131	23.25	21.7	17.2	2500 gph
SK5	14940171	23.25	25.9	20.0	5000 gph
SK10	14940172	23.25	31.4	23.9	10000 gph

ACCESSORIES

Skimmer Accessories	Item No.	Dimensions (in)	Discharge	Included
AFV-GH Auto Fill Kit	566286	-	<ul style="list-style-type: none"> • 1/2" MNPT auto-fill valve • 1/2" barb adapter • 1/2" female adapter • 3/4" FGHT (garden hose adapter) 	-

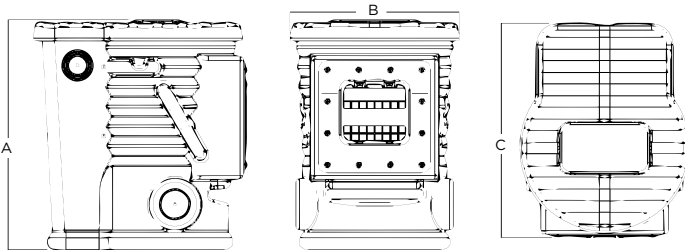

BIOLOGICAL FILTRATION - WATERFALL FILTERS

Little Giant® biological waterfall filters were created to help maintain a balanced ecosystem. These highly-efficient models use the latest filtration technology to decrease maintenance time and provide quick, toolless access to the filters. Our units produce natural-flowing waterfalls, with all plumbing hidden.



FEATURES

- One-step backwash capability
- Easily accessible media for maintenance
- Simple silicone-free installation

ORDERING INFORMATION

Waterfall Filters	Item No.	Dimensions (in)				Max. Flow	Pipe Connection
		A	B	C	D		
WF5	571010	24.3	25.8	33.8	8.8	5000 gph	2"
WF10	571011	28.8	32.3	40.2	8.8	10000 gph	2" or 3"

ACCESSORIES

Waterfall Filter Accessories	Item No.
WFF-20 - ROCKIN FOAM®	599057
BFK-M - Backflush Kit	14940321
BM-30-PW, 30 count	566112

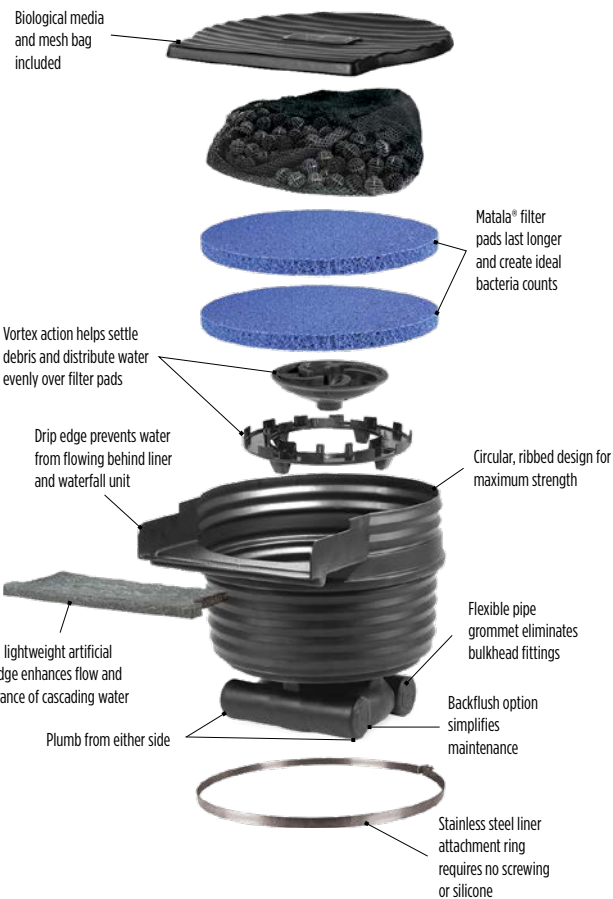
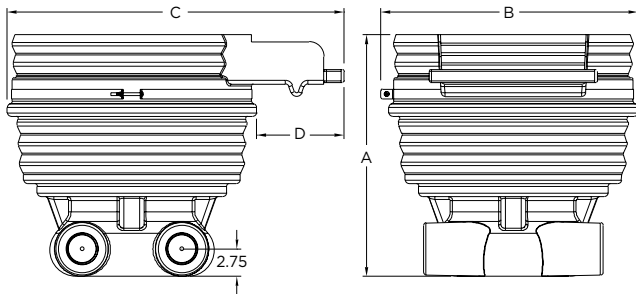

LED LIGHTING - LED EGGLETES

The LED EggLite offers a compact lighting option that operates wet or dry. They come in three color options and can be powered by the sun using the optional solar panel. Up to six lights will power on the solar panel.



ORDERING INFORMATION

LED EggLites	Item No.	Power Type	Watts	Color	Cord (ft)	Submerged Use	Dry Use	Transformer Included	Lights Included	Lamp Size	Dimensions
LXE2-W - White Add-on Light	566440	Solar/4 VDC	2	White	10'	✓	✓		2	1"	1" diameter
LXE2-G - Green Add-on Light	566441	Solar/4 VDC	2	Green	10'	✓	✓		2	1"	1" diameter
LXE2-B - Blue Add-on Light	566442	Solar/4 VDC	2	Blue	10'	✓	✓		2	1"	1" diameter
LC-10E - 10 Foot Extension	566449	-	-	-	10'	✓	✓		-	-	120" x 0.1"

LED-K LIGHTING

Energy-efficient LED fixtures consume only 3 Watts per lamp and last up to 10 years.



ORDERING INFORMATION

LED-K Lighting	Item No.	Power Type	Watts	Color	Cord (ft)	Submerged Use	Dry Use	Transformer Included	Lights Included	Lamp Size	Dimensions
LED-B - Multi-Color LED MR-16 Bulb	566224	12 VAC	3	Multi	-	✓	✓		Bulb	MR-16	3" diameter



With 11 light modes ranging from brilliant red to a continuous transition of soft color, you can easily reflect any mood.

HALOGEN LIGHTING - LVL LIGHTING

Our bright, 20 Watt halogen lamp lasts about 3,000 hours. Up to three lights can run on one transformer, which has a switch-selectable timer. Colored lenses create a variety of hues. Install them in or out of the water using the included mounting hardware.



ORDERING INFORMATION

LVL	Item No.	Power Type	Watts	Color	Cord (ft)	Submerged Use	Dry Use	Transformer Included	Lights Included	Lamp Size	Dimensions
LVLK-HAL Kit	566237	12 VAC	20	Multi	20'	✓	✓	✓	1	MR-16	3" diameter
LVL-PW Light	566527	12 VAC	20	Multi	20'	✓	✓		1	MR-16	3" diameter
LVL-HB-PW MR-16 BULB	566528	12 VAC	20	Multi	-	✓	✓		Bulb	MR-16	3" diameter



VIRTUAL POND KITS

TO BUILD 1400 GALLON POND

Description	Model	Item No.
Skimmer	SK2.5	566131
Filter	WF5	571010
Pump	F20-2700	566725
Liner	10' x 15'	566545
Auto Fill Kit	AFV-GH Auto Fill	566286
Backflush Kit	BFK-M	14940321
Waterfall Foam	WFF-20-Rockin Foam	599057

TO BUILD 3400 GALLON POND

Description	Model	Item No.
Skimmer	SK10	14940172
Filter	WF5	571010
Pump	F50-5000	566728
Liner	15' x 20'	566547
Auto Fill Kit	AFV-GH Auto Fill	566286
Backflush Kit	BFK-M	14940321
Waterfall Foam	WFF-20-Rockin Foam	599057

DISAPPEARING STREAM

Description	Model	Item No.
Vault	SF	566410
Waterfall Weir	WFW	566239
Pump	F30-4000	566726
Liner	Fit To Size	Page 24
Auto fill Kit	AFV-GH Auto Fill	566286
Waterfall Foam	WFF-20-Rockin Foam	599057



PLUMBING - FITTINGS

Our select group of quality plumbing components is affordable and always the right fit. We offer tubing fittings and Schedule 40 fittings for any installation, from vinyl tubing, PVC pipe, and flex PVC.

ORDERING INFORMATION

Model	Item No.	Pipe/Size Tubing	Type
C-2-PW Restrictor Clamp	566289	1/2"	Tubing
FC-1/4 Flow Control FNPT x Barb	566228	1/4"	Tubing
AD-3M-3S Male Adapter	566244	3"	PVC
AD-BH-2 Bulkhead Fitting	566257	2"	FNPT
BV-112S Ball Valve Slip x Slip	566250	1-1/2"	PVC
3" Flexible Pipe Grommet	925023	3"	BUNA-N
2" Flexible Pipe Grommet	925033	2"	BUNA-N
4" Flexible Pipe Grommet	925034	4"	BUNA-N
3/4" Flexible Pipe Grommet Fountain Connector	925035	3/4"	BUNA-N
1/2" Fountain Connector	925054	1/2"	BUNA-N
CV-SE1 Check Valve	940019	1-1/2"	PVC
CV-SE2 Check Valve	940022	2"	PVC
CV-SE3 Check Valves	940023	3"	PVC



Restrictor Clamp



Flow Control FNPT x Barb



Male Adapter



Bulkhead Fitting



Ball Valve Slip x Slip



Flexible Pipe Grommet



Check Valve



LINERS & ACCESSORIES

Pond liners are designed from strong, puncture-resistant material that allows for the customization of any water feature. Both Firestone 45-mil EPDM and our 20-mil PVC are flexible and safe for aquatic life too.



ORDERING INFORMATION

Cut Sizes	EPDM Item No.	Dimensions
10 x 15 Liner	566545	10' x 15'
15 x 15 Liner	566546	15' x 15'
15 x 20 Liner	566547	15' x 20'
10 x 15 6oz. Underlayment	566548	10' x 15'
15 x 15 6oz. Underlayment	566549	15' x 15'
15 x 20 6oz. Underlayment	566550	15' x 20'

ORDERING INFORMATION

EPDM Accessories	Item No.
6" x 25' Cover Seam Tape	566369
6" x 100' Cover Seam Tape	566370
LVOC QuickPrime Plus - Quart	566371
LVOC QuickPrime Plus - Gallon	566372
QuickSeam Scrubber Kit	566373
EPDM Repair kit	566374
Silicone Roller	566375
Pipe Boot	566376



ORDERING INFORMATION

Rolls	Item No.	Dimensions
10 x 100 EPDM Roll	566358	10' x 100'
15 x 100 EPDM Roll	566359	15' x 100'
20 x 100 EPDM Roll	566360	20' x 100'
25 x 100 EPDM Roll	566361	25' x 100'
30 x 100 EPDM Roll	566362	30' x 100'
35 x 100 EPDM Roll	566363	35' x 100'
40 x 100 EPDM Roll	566364	40' x 100'
50 x 100 EPDM Roll	566365	50' x 100'
20 x 50 EPDM Mini Roll	566366	20' x 50'
25 x 50 EPDM Mini Roll	566367	25' x 50'
30 x 50 EPDM Mini Roll	566368	30' x 50'
5 x 300 6oz. Underlayment	566377	5' x 300'



PROTECTION - LOW WATER SHUT-OFF

Whether a small disappearing fountain or full water garden, protecting your investment enhances enjoyment. Achieve that peace of mind with a low water cut-off switch for the pump, auto fill valve to keep the beauty flowing, or winter gear to protect your pond and fish.



ORDERING INFORMATION

Low Water Shut-Off	Item No.	Voltage	Cord
AFV-GH Auto Fill	566286	-	-
RS-5	566009	115 V	18'
RFSN-16	599211	115/230 V	20'
RFSN-20	599318	115/230 V	20'



FALL & WINTER - POND NETTING & WINTER

Whether a small disappearing fountain or full water garden, protecting your investment enhances enjoyment. Achieve that peace of mind with a low water cut-off switch for the pump, auto fill valve to keep the beauty flowing, or winter gear to protect your pond and fish.

ORDERING INFORMATION

Pond Netting & Winter	Item No.	Dimensions	Advantages
N-2828-PW	566047	28' x 28'	<ul style="list-style-type: none"> • 3/4" square mesh • Covers 28' x 28' area • Includes 12 anchoring stakes
N-1414-PW	566046	14' x 14'	<ul style="list-style-type: none"> • 3/4" square mesh • Covers 14' x 14' area • Includes 10 anchoring stakes
N-710-PW	566045	7' x 10'	<ul style="list-style-type: none"> • 3/4" square mesh • Covers 7' x 10' area • Includes 8 anchoring stakes
P-418-PW Pond De-icer	566049	7" dia. x 4"	<ul style="list-style-type: none"> • For ponds 50-600 gallons • De-ices 1' radius • 1200 Watts



ACCESSORIES - AQUATIC PLANT BASKETS

Little Giant aquatic plant baskets are designed to contain aquatic plants in your pond. The mesh baskets allow water to circulate around the plants' roots.

ORDERING INFORMATION

Model	Item No.	Description
UPB-R9-PW	566553	9" round plant basket
UPB-1212-PW	566556	12" square plant basket

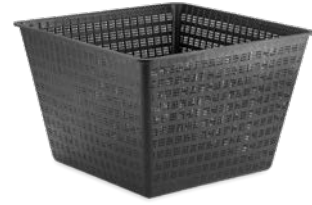

UPB-1212-PW

FISH NETS

Fish nets make catching the fish safer than using your hands, as does a skimmer net for removing floating debris.

ORDERING INFORMATION

Model	Item No.	Description
NS	566050	Skimmer Net Handle: 48" L; Net: 10" W x 9" L x 3" D
AFN	567574	Fish Net Extends: 39" to 57.5"; Net: 15.25" W x 13" L x 12" D



AFN

NS

REPLACEMENT PARTS

Accidents and wear and tear happen. When it does, rest easy knowing we have the right replacement parts for your equipment.

FOUNTAINS & FEATURES

Item No.	Model	Description
166468	-	36" Dfb Column
166469	-	36" Dfb Wedge
166471	-	44" Dfb Support Tube
166472	-	44" Dfb Plate

FILTRATION

Item No.	Model	Description
860-10	-	Filter pad for spillway 10"
860-18	-	Filter pad for spillway 18"
170277	-	Mesh bag for biomedica
170299	-	Skimmer net for SK5
170300	-	Skimmer net for SK10
170303	-	Grate for SK5
170304	-	Grate for SK10
170311	-	Lid for SK5
170312	-	Lid for SK10
170313	-	Black lid for WF5
170315	-	Black lid for WF10
170465	-	Skimmer net for SK2.5
170461	-	Lid for SK2.5
170463	-	Grate for SK2.5
517100	CFS170T	Barrel filter, 1" FNPT
517101	CFS955	Foam filter for CFS155T and CFS170T
517505	CFS100	Screen, plastic small
517506	CFS155T	Screen, plastic, for large SST, CFS955
566109	PF-RP-PW	PF-AD replacement pad
566111	FK-SBF-RP-PW	FB replacment filter pad
566112	BM-30-PW	Biomedica, 30 ct
566113	SBF-1-RP-PW	Replacement filters
566813	-	SK2.5 repair kit
566815	-	SK5 repair kit
566816	-	SK10 repair kit
990108	-	PTFE
14940208	-	RTV silicone sealant
14940343	F-SBRK	Skimmer brush kit
14940581	-	Skimmer lid plug

LIGHTING & CONTROLS

Item No.	Model	Description
170756	-	Light fixture glass lens for LVL and LED
517403	LEC-5M	Ext. cord, 16', EggLite
517410	LRB-10W-30	Replacement bulb, 12 V, 10 Watt, 30 °
924006	-	LED EggLite wire connection O-ring
924135	-	Light fixture O-ring for LVL and LED

PUMPS

Item No.	Model	Description
11200	-	Repair kit for S580
11205	-	Repair kit for S900T
11210	-	Repair kit for S1200T
10215	-	Repair kit A180 - A210 & S225
10216	-	Repair kit A180T - A210T & S225T
10220	-	Repair kit A280 - A430 & S320
10221	-	Repair kit A280T - A430T & S320T
118984	-	Kit, repair parts, PE-1F-PW
118985	-	Kit, repair parts, PE-2H-PW
118986	-	Kit, repair parts, PE-2F-PW
118987	-	Kit, repair parts, PE-1H-PW
118988	-	Kit, repair parts, PE-2.5F-PW
166055	-	FP1 Impeller and Rotor Assembly
166056	-	FP2 Impeller and Rotor Assembly
166057	-	FP3 Impeller and Rotor Assembly
166058	-	FP6 Impeller and Rotor Assembly
166059	-	FP9 Impeller and Rotor Assembly
166060	-	FP Pumps O-ring and Screws
166360	-	Impeller PES700
166361	-	Impeller PES800
166362	-	Impeller PES1000
166772	-	Replacement Screen Kit, F10-F70
166773	-	Replacement Housing, F10-F20
166774	-	Replacement Housing, F30-F70
166775	-	Replacement Volute Kit, F10
166776	-	Replacement Volute Kit, F20
166777	-	Replacement Volute Kit, F30-F50
166780	-	Replacement Volute Kit, F70
166781	-	Replacement Rotor Kit, F10
166782	-	Replacement Rotor Kit, F20
166783	-	Replacement Rotor Kit, F30
166784	-	Replacement Rotor Kit, F40
166785	-	Replacement Rotor Kit, F50
166786	-	Replacement Rotor Kit, F70
166787	-	Replacement Screen, F10-F70
170170	-	WGP 1" elbow
170194	-	WGP 1-1/2" elbow
170208	-	WGP plate
170209	-	WGP plug
517500	SPB1	Positioning bracket for S580 S900 S1200



ADDITIONAL PRODUCT LINES

AQUARIUM

Little Giant® aquarium products implement the highest quality of engineering and design in every product. Each product is designed specifically for aquarium-filtered applications in freshwater and saltwater environments.

AQUARIUM PUMP

ITEM 580507 | MODEL 2-MDQX-SC



HYDROPONICS

All Little Giant® Hydroponic pumps are manufactured with a corrosion-resistant body specifically designed for submersible use. Magnetic drive pumps offer better energy efficiency, while direct drive pumps produce greater starting torque and more pressure. Our extensive product line allows you to choose which pump features are best for your application.

325 GPH SUBMERSIBLE HYDROPONIC PUMP

ITEM 527003 | MODEL NK-2

200 GPH AUTOMATIC HYDROPONIC PUMP

ITEM 550523 | MODEL 1-ABS



POOL PRODUCTS

Little Giant® offers an extensive collection of pool cover pumps that are able to keep up with the needs of virtually any pool cover. These pumps offer industry-leading service, easy water removal, and superior pool cover protection.

AUTOMATIC POOL COVER PUMP

ITEM 577301 | MODEL APCP-1700

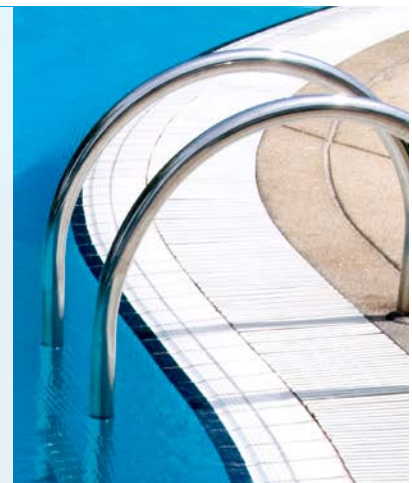

INDEX OF ITEMS ALPHABETICALLY BY MODEL

Model	Item No.	Description	Page
#1	501004	Direct drive oil-filled pump - 115 V, 60 Hz, 6', 205 gph	12
1-MA	521204	Direct drive oil-filled pump - 115 V, 60 Hz, 6', 170 gph	12
2E-38N-WG	502375	Direct drive oil-filled pump - 115 V, 60 Hz, 15' UL/CSA, 300 gph	12
3E-12N	503375	Direct drive oil-filled pump - 115 V, 60 Hz, 6' black, 500 gph	12
AD-3M-3S	566244	3" male adapter MNPT x slip	24
AD-BH-2	566257	2" bulkhead fitting	24
AFN	567574	Fish net	27
AFV-GH	566286	Auto fill valve kit, 1/2" MNPT	23
BFK-M	14940321	Manual backflush kit	19, 22
BM-30-PW	566112	Biomedica, 30 ct	19, 27
BV-112S	566250	Ball valve 1-1/2" slip, PVC	24
C-2-PW	566289	Restrictor clamp - case qty only	24
CFS-100	517505	Filter screen, small plastic	17, 27
CFS-155T	517506	Filter screen, plastic, for large SST, CFS-955	17, 27
CFS-170T	517100	Barrel filter, 1" FNPT	17, 27
CFS-955	517101	Foam filter for CFS-155T & CFS-170T	17, 27
CV-SE1	940019	Check valve, 1-1/2" ips (1-1/2" solids)	23
CV-SE2	940022	Check valve, 2" ips (2" solids)	23
CV-SE3	940023	Check valve, 3" ips (3" solids)	23
DFB36	566517	Disappearing fountain basin, 36" diameter	14
DFB36PP	566559	Pallet program 36" disappearing basin - case qty only	14
DFB44	566558	Disappearing basin, 44" square	14
DFB44PP	566560	Pallet program 44" disappearing basin - case qty only	14
F10-1200	566724	F-series wet rotor pump - 1200 gph	5
F20-2700	566725	F-series wet rotor pump - 2700 gph	5, 22
F30-4000	566726	F-series wet rotor pump - 4000 gph	5, 22
F40-5500	566728	F-series wet rotor pump - 5000 gph	5, 22
F50-5000	566727	F-series wet rotor pump - 5500 gph	5
F70-7300	566729	F-series wet rotor pump - 7300 gph	5
FB-PW	566108	Pump filter box	17
FC-1/4	566228	Flow control assembly, FNPT x barb - case qty only	23
FK-SBF-RP-PW	566111	FB replacement filter pad	17, 27
FP1	566132	Flex pump - 1000 gph	6
FP2	566133	Flex pump - 2000 gph	6
FP3	566134	Flex pump - 3000 gph	6
FP6	566135	Flex pump - 6000 gph	6
FP9	566137	Flex pump - 9000 gph	6
F-SBRK	14940343	Skimmer brush kit	27
LC-10E	566449	Extension cord, 10' male to female LED EggLite	20
LEC-5M	517403	EggLite extension cord, 16'	27
LED-B	566224	11-way multi-colored LED MR-16 bulb	20
LRB-10W-30	517410	Replacement bulb, 12 V, 10 Watt, 30 degrees	27
LVL-HB-PW	566528	Replacement halogen lamp	21
LVLK-HAL	566237	LVL Halogen Lighting Kit	21
LVL-PW	566527	Low voltage light kit	21
LXE2-B	566442	Blue Add-on Light	20
LXE2-G	566441	Green Add-on Light	20
LXE2-W	566440	White Add-on Light	20
N-1414-PW	566046	Netting, 14' x 14'	25
N-2828-PW	566047	Netting, 28' x 28'	25
N-710-PW	566045	Netting, 7' x 10'	25
NS	566050	Skimmer net	26
P-418-PW	566049	Pond de-icer, 1200 Watts	25
P-AAA	523375	Magnetic drive pump - 115 V, 60 Hz, 6', 120 gph	12
PE-1F-PW	566608	Direct drive pump - 170 gph, 36 Watts, 15' cord	8
PE-1H-PW	566604	Direct drive pump - 170 gph, 36 Watts, 6' cord	8
PE-2.5F-PW	566612	Direct drive pump - 475 gph, 80 Watts, 15' cord	8
PE-2F-PW	566611	Direct drive pump - 300 gph, 47 Watts, 15' cord	8
PE-2H-PW	566609	Direct drive pump - 300 gph, 47 Watts, 6' cord	8
PES-1000-PW	566722	Magnetic drive pump - 1150 gph, 160 Watts, 15' cord	7
PES-130-PW	566716	Magnetic drive pump - 130 gph, 11 Watts, 6' cord	7
PES-290-PW	566717	Magnetic drive pump - 300 gph, 23 Watts, 6' cord	7
PES-380-PW	566718	Magnetic drive pump - 380 gph, 36 Watts, 15' cord	7
PES-40-PW	566713	Magnetic drive pump - 47 gph, 5 Watts, 6' cord	7
PES-700-PW	566720	Magnetic drive pump - 725 gph, 46 Watts, 15' cord	7
PES-800-PW	566721	Magnetic drive pump - 875 gph, 100 Watts, 15' cord	7
PES-80-PW	566714	Magnetic drive pump - 77 gph, 8 Watts, 6' cord	7

Model	Item No.	Description	Page
PF-AD-PW	566107	Dual filter kit	17, 27
PF-RP-PW	566109	PF-AD replacement filter pad	17, 27
RFSN-16	599211	Low water pump shut-off, 115/230 V, 15 amps	25
RFSN-20	599318	Low water pump shut-off, 230 V, 20 amps	25
RJ21	517200	Spray ring with 21 jets	16
RS-5	566009	Low water pump shut-off, 115 V, 10 amps	25
S1200T-20	517012	SS & bronze pump - 1200 gph, 115 V with 20' cord	9
S320T-20	517003	SS & bronze pump - 320 gph, 115 V with 20' cord	9
S580T-20	517006	SS & bronze pump - 580 gph, 115 V with 20' cord	9
S900T-20	517009	SS & bronze pump - 900 gph, 115 V with 20' cord	9
SBF-1-RP-PW	566113	Replacement filter pads	17, 27
SF	566410	Simply falls pump vault	14, 22
SK10	14940172	Skimmer for ponds up to 10,000 gallons (S5000)	18, 22
SK2.5	566131	Skimmer for ponds up to 2,500 gallons	18, 22
SK5	14940171	Skimmer for ponds up to 5,000 gallons (S1000)	18
SPB1	517500	Positioning bracket for S580, S900, S1200	27
SPW10	517202	Spillway, 10"	15
SPW18	517203	Spillway, 18"	15
UPB-1212-PW	566556	Square 12" basket - case qty only	26
UPB-R9-PW	566553	Round 9" basket - case qty only	26
WF10	571011	Waterfall filter for ponds up to 10,000 gallons (F5000)	19
WF5	571010	Waterfall filter for ponds up to 5,000 gallons (F1000)	19, 22
WFF-20	599057	Black waterfall foam, 20 oz - case qty only	19, 22
WEW	566239	Waterfall weir, 6000 gph	15, 22
WGFP-100	566070	Pump - 6400 gph @ 5', 1210 Watts, 15' cord, 1-3/8" solids	11
WGFP-150	566071	Pump - 9750 gph @ 5', 1210 Watts, 19' cord, 3/4" solids	11
WGFP-200	566072	Pump - 16000 gph @ 5', 2085 Watts, 19' cord, 3/4" solids	11
WGFP-75	566069	Pump - 4900 gph @ 5', 847 Watts, 15' cord, 1-3/8" solids	11
WGP-65-PW	566409	Premium direct drive pump - 1900 gph, 230 Watts, 16' cord	10
WGP-80-PW	566417	Premium direct drive pump - 3500 gph, 640 Watts, 16' cord	10
WGP-95-PW	566407	Premium direct drive pump - 4280 gph, 700 Watts, 16' cord	10
	10215	Repair kit A180 - A210 & S225	27
	10216	Repair kit A180T - A210T & S225T	27
	10220	Repair kit A280 - A430 & S320	27
	10221	Repair kit A280T - A430T & S320T	27
	11200	Repair kit for S580	27
	11205	Repair kit for S900T	27
	11210	Repair kit for S1200T	27
	118984	Kit, repair parts, PE-1F-PW	27
	118985	Kit, repair parts, PE-2H-PW	27
	118986	Kit, repair parts, PE-2F-PW	27
	118987	Kit, repair parts, PE-1H-PW	27
	118988	Kit, repair parts, PE-2.5F-PW	27
	166055	FP1 impeller and rotor assembly	27
	166056	FP2 impeller and rotor assembly	27
	166057	FP3 impeller and rotor assembly	27
	166058	FP6 impeller and rotor assembly	27
	166059	FP9 impeller and rotor assembly	27
	166060	FP pumps O-ring and screws	27
	166360	Impeller PES700	27
	166361	Impeller PES800	27
	166362	Impeller PES1000	27
	166468	36" DFB column	27
	166469	36" DFB wedge	27
	166471	44" DFB support tube	27
	166472	44" DFB plate	27
	166772	Replacement screen kit, F10-F70	27
	166773	Replacement housing, F10-F-20	27
	166774	Replacement housing, F30-F70	27
	166775	Replacement volute kit, F10	27
	166776	Replacement volute kit, F20	27
	166777	Replacement volute kit, F30-F50	27
	166780	Replacement volute kit, F70	27
	166781	Replacement rotor kit, F10	27
	166782	Replacement rotor kit, F20	27
	166783	Replacement rotor kit, F30	27
	166784	Replacement rotor kit, F40	27



INDEX OF ITEMS ALPHABETICALLY BY MODEL

Model	Item No.	Description	Page
	166785	Replacement rotor kit, F50	27
	166786	Replacement rotor kit, F70	27
	166787	Replacement screen, F10-F70	27
	170170	WGP 1" elbow	27
	170194	WGP 1-1/2" elbow	27
	170208	WGP plate	27
	170209	WGP plug	27
	170277	Mesh bag for biomedica	27
	170299	Skimmer net for SK5	27
	170300	Skimmer net for SK10	27
	170303	Grate for SK5	27
	170304	Grate for SK10	27
	170311	Lid for SK5	27
	170312	Lid for SK10	27
	170313	Black lid for WF10	27
	170315	Black lid for WF10	27
	170461	Lid for SK2.5	27
	170463	Grate for SK2.5	27
	170465	Skimmer net for SK2.5	27
	170756	Light fixture glass lens for LVL and LED	27
	566358	Liner, 10' x 100' EPDM roll	24
	566359	Liner, 15' x 100' EPDM roll	24
	566360	Liner, 20' x 100' EPDM roll	24
	566361	Liner, 25' x 100' EPDM roll	24
	566362	Liner, 30' x 100' EPDM roll	24
	566363	Liner, 35' x 100' EPDM roll	24
	566364	Liner, 40' x 100' EPDM roll	24
	566365	Liner, 50' x 100' EPDM roll	24
	566366	Liner, 20' x 50' EPDM mini roll	24
	566367	Liner, 25' x 50' EPDM mini roll	24
	566368	Liner, 30' x 50' EPDM mini roll	24
	566369	6" x 25' cover seam tape	24
	566370	6" x 100' cover seam tape	24
	566371	LVOC QuickPrime Plus, quart	24
	566372	LVOC QuickPrime Plus, gallon	24
	566373	Quickseam scrubber kit	24
	566374	EPDM repair kit	24
	566375	Silicone roller	24
	566376	Pipe boot	24
	566377	5' x 300' 6 oz. liner underlayment	24
	566545	10' x 15' Liner	22, 24
	566546	15' x 15' Liner	24
	566547	15' x 20' Liner	22, 24
	566548	10' x 15' 6 oz. liner underlayment	24
	566549	15' x 15' 6 oz. liner underlayment	24
	566550	15' x 20' 6 oz. liner underlayment	24
	566813	SK2.5 repair kit	27
	566815	SK5 repair kit	27
	566816	SK10 repair kit	27
	860-10	Filter pad for spillway, 10"	27
	860-18	Filter pad for spillway, 18"	27
	924006	LED EggLite wire connection O-ring	27
	924135	Light fixture O-ring for LVL and LED	27
	925023	3" Flexible pipe grommet	23
	925033	2" Flexible pipe grommet	23
	925034	4" Flexible pipe grommet	23
	925035	3/4" Flexible pipe grommet - fountain connector	23
	925054	1/2" Flexible pipe grommet - fountain connector	23
	990108	PTFE	27
	14940208	RTV silicone sealant	27
	14940581	Skimmer lid plug	27

INDEX OF ITEMS NUMERICALLY BY ITEM NUMBER

Item	Model	Description	Page
	10215	Repair kit A180 - A210 & S225	27
	10216	Repair kit A180T - A210T & S225T	27
	10220	Repair kit A280 - A430 & S320	27
	10221	Repair kit A280T - A430T & S320T	27
	11200	Repair kit for S580	27
	11205	Repair kit for S900T	27
	11210	Repair kit for S1200T	27
	118984	Kit, repair parts, PE-1F-PW	27
	118985	Kit, repair parts, PE-2H-PW	27
	118986	Kit, repair parts, PE-2F-PW	27
	118987	Kit, repair parts, PE-1H-PW	27
	118988	Kit, repair parts, PE-2.5F-PW	27
	166055	FP1 impeller and rotor assembly	27
	166056	FP2 impeller and rotor assembly	27
	166057	FP3 impeller and rotor assembly	27
	166058	FP6 impeller and rotor assembly	27
	166059	FP9 impeller and rotor assembly	27
	166060	FP pumps O-ring and screws	27
	166360	Impeller PES700	27
	166361	Impeller PES800	27
	166362	Impeller PES1000	27
	166468	36" DFB column	27
	166469	36" DFB wedge	27
	166471	44" DFB support tube	27
	166472	44" DFB plate	27
	166772	Replacement screen kit, F10-F70	27
	166773	Replacement housing, F10-F20	27
	166774	Replacement housing, F30-F70	27
	166775	Replacement volute kit, F10	27
	166776	Replacement volute kit, F20	27
	166777	Replacement volute kit, F30-F50	27
	166780	Replacement volute kit, F70	27
	166781	Replacement rotor kit, F10	27
	166782	Replacement rotor kit, F20	27
	166783	Replacement rotor kit, F30	27
	166784	Replacement rotor kit, F40	27
	166785	Replacement rotor kit, F50	27
	166786	Replacement rotor kit, F70	27
	166787	Replacement screen, F10-F70	27
	170170	WGP 1" elbow	27
	170194	WGP 1-1/2" elbow	27
	170208	WGP plate	27
	170209	WGP plug	27
	170277	Mesh bag for biomedica	27
	170299	Skimmer net for SK5	27
	170300	Skimmer net for SK10	27
	170303	Grate for SK5	27
	170304	Grate for SK10	27
	170311	Lid for SK5	27
	170312	Lid for SK10	27
	170313	Black lid for WF10	27
	170315	Black lid for WF10	27
	170461	Lid for SK2.5	27
	170463	Grate for SK2.5	27
	170465	Skimmer net for SK2.5	27
	170756	Light fixture glass lens for LVL and LED	27
#1	501004	Direct drive oil-filled pump - 115 V, 60 Hz, 6', 205 gph	12
2E-38N-WG	502375	Direct drive oil-filled pump - 115 V, 60 Hz, 15' UL/CSA, 300 gph	12
3E-12N	503375	Direct drive oil-filled pump - 115 V, 60 Hz, 6' black, 500 gph	12
S320T-20	517003	SS & bronze pump - 320 gph, 115 V with 20' cord	9
S580T-20	517006	SS & bronze pump - 580 gph, 115 V with 20' cord	9
S900T-20	517009	SS & bronze pump - 900 gph, 115 V with 20' cord	9
S1200T-20	517012	SS & bronze pump - 1200 gph, 115 V with 20' cord	9
CFS-170T	517100	Barrel filter, 1" FNPT	17, 27
CFS-955	517101	Foam filter for CFS-155T & CFS-170T	17, 27
RJ21	517200	Spray ring with 21 jets	16
SPW10	517202	Spillway, 10"	15

Item	Model	Description	Page
SPW18	517203	Spillway, 18"	15
LEC-5M	517403	EggLite extension cord, 16'	27
LRB-10W-30	517410	Replacement bulb, 12 V, 10 Watt, 30 degrees	27
SPB1	517500	Positioning bracket for S580, S900, S1200	27
CFS-100	517505	Filter screen, small plastic	17, 27
CFS-155T	517506	Filter screen, plastic, for large SST, CFS-955	17, 27
1-MA	521204	Direct drive oil-filled pump - 115 V, 60 Hz, 6', 170 gph	12
P-AAA	523375	Magnetic drive pump - 115 V, 60 Hz, 6', 120 gph	12
RS-5	566009	Low water pump shut-off, 115 V, 10 amps	25
N-710-PW	566045	Netting, 7' x 10'	25
N-1414-PW	566046	Netting, 14' x 14'	25
N-2828-PW	566047	Netting, 28' x 28'	25
P-418-PW	566049	Pond de-icer, 1200 Watts	25
NS	566050	Skimmer net	26
WGFP-75	566069	Pump - 4900 gph @ 5', 847 Watts, 15' cord, 1-3/8" solids	11
WGFP-100	566070	Pump - 6400 gph @ 5', 1210 Watts, 15' cord, 1-3/8" solids	11
WGFP-150	566071	Pump - 9750 gph @ 5', 1210 Watts, 19' cord, 3/4" solids	11
WGFP-200	566072	Pump - 16000 gph @ 5', 2085 Watts, 19' cord, 3/4" solids	11
PF-AD-PW	566107	Dual filter kit	17
FB-PW	566108	Pump filter box	17
PF-RP-PW	566109	PF-AD replacement filter pad	17, 27
FK-SBF-RP-PW	566111	FB replacement filter pad	17, 27
BM-30-PW	566112	Biomedica, 30 ct	19, 27
SBF-1-RP-PW	566113	Replacement filter pads	17, 27
SK2.5	566131	Skimmer for ponds up to 2,500 gallons	18, 22
FP1	566132	Flex pump - 1000 gph	6
FP2	566133	Flex pump - 2000 gph	6
FP3	566134	Flex pump - 3000 gph	6
FP6	566135	Flex pump - 6000 gph	6
FP9	566137	Flex pump - 9000 gph	6
T-1-1/2-25-BF-PVC	566182	Black flexible PVC, 1-1/2"	22
T-2-25-BFPVC	566184	Black flexible PVC, 2"	22
LED-B	566224	11-way multi-colored LED MR-16 bulb	20
FC-1/4	566228	Flow control assembly, FNPT x barb - case qty only	23
LVLK-HAL	566237	LVL Halogen Lighting Kit	21
FWF	566239	Waterfall weir, 6000 gph	15, 22
AD-3M-3S	566244	3" male adapter MNPT x slip	23
BV-112S	566250	Ball valve 1-1/2" slip, PVC	23
AD-BH-2	566257	2" bulkhead fitting	23
AFV-GH	566286	Auto fill valve kit, 1/2" MNPT	22, 25
C-2-PW	566289	Restrictor clamp - case qty only	23
	566358	Liner, 10' x 100' EPDM roll	24
	566359	Liner, 15' x 100' EPDM roll	24
	566360	Liner, 20' x 100' EPDM roll	24
	566361	Liner, 25' x 100' EPDM roll	24
	566362	Liner, 30' x 100' EPDM roll	24
	566363	Liner, 35' x 100' EPDM roll	24
	566364	Liner, 40' x 100' EPDM roll	24
	566365	Liner, 50' x 100' EPDM roll	24
	566366	Liner, 20' x 50' EPDM mini roll	24
	566367	Liner, 25' x 50' EPDM mini roll	24
	566368	Liner, 30' x 50' EPDM mini roll	24
	566369	6" x 25' cover seam tape	24
	566370	6" x 100' cover seam tape	24
	566371	LVOC QuickPrime Plus, quart	24
	566372	LVOC QuickPrime Plus, gallon	24
	566373	Quickseam scrubber kit	24
	566374	EPDM repair kit	24
	566375	Silicone roller	24
	566376	Pipe boot	24
	566377	5' x 300' 6 oz. liner underlayment	24
WGP-95-PW	566407	Premium direct drive pump - 4280 gph, 700 Watts, 16' cord	10
WGP-65-PW	566409	Premium direct drive pump - 1900 gph, 230 Watts, 16' cord	10
SF	566410	Simply falls pump vault	14, 22
WGP-80-PW	566417	Premium direct drive pump - 3500 gph, 640 Watts, 16' cord	10
LXE2-W	566440	White Add-on Light	20



INDEX OF ITEMS NUMERICALLY BY ITEM NUMBER

Item	Model	Description	Page
LXE2-G	566441	Green Add-on Light	20
LXE2-B	566442	Blue Add-on Light	20
LC-10E	566449	Extension cord, 10' male to female LED EggLite	20
DFB36	566517	Disappearing fountain basin, 36" diameter	14
LVL-PW	566527	Low voltage light kit	21
LVL-HB-PW	566528	Replacement halogen lamp	21
	566545	10' x 15' Liner	22, 24
	566546	15' x 15' Liner	24
	566547	15' x 20' Liner	22, 24
	566548	10' x 15' 6 oz. liner underlayment	24
	566549	15' x 15' 6 oz. liner underlayment	24
	566550	15' x 20' 6 oz. liner underlayment	24
UPB-R9-PW	566553	Round 9" basket - case qty only	26
UPB-1212-PW	566556	Square 12" basket - case qty only	26
DFB44	566558	Disappearing basin, 44" square	14
DFB36PP	566559	Pallet program 36" disappearing basin - case qty only	14
DFB44PP	566560	Pallet program 44" disappearing basin - case qty only	14
PE-1H-PW	566604	Direct drive pump - 170 gph, 36 Watts, 6' cord	8
PE-1F-PW	566608	Direct drive pump - 170 gph, 36 Watts, 15' cord	8
PE-2H-PW	566609	Direct drive pump - 300 gph, 47 Watts, 6' cord	8
PE-2F-PW	566611	Direct drive pump - 300 gph, 47 Watts, 15' cord	8
PE-2.5F-PW	566612	Direct drive pump - 475 gph, 80 Watts, 15' cord	8
PES-40-PW	566713	Magnetic drive pump - 47 gph, 5 Watts, 6' cord	7
PES-80-PW	566714	Magnetic drive pump - 77 gph, 8 Watts, 6' cord	7
PES-130-PW	566716	Magnetic drive pump - 130 gph, 11 Watts, 6' cord	7
PES-290-PW	566717	Magnetic drive pump - 300 gph, 23 Watts, 6' cord	7
PES-380-PW	566718	Magnetic drive pump - 380 gph, 36 Watts, 15' cord	7
PES-700-PW	566720	Magnetic drive pump - 725 gph, 46 Watts, 15' cord	7
PES-800-PW	566721	Magnetic drive pump - 875 gph, 100 Watts, 15' cord	7
PES-1000-PW	566722	Magnetic drive pump - 1150 gph, 160 Watts, 15' cord	7
F10-1200	566724	F-series wet rotor pump - 1200 gph	5
F20-2700	566725	F-series wet rotor pump - 2700 gph	5, 22
F30-4000	566726	F-series wet rotor pump - 4000 gph	5, 22
F50-5000	566727	F-series wet rotor pump - 5500 gph	5
F40-5500	566728	F-series wet rotor pump - 5000 gph	5, 22
F70-7300	566729	F-series wet rotor pump - 7300 gph	5
	566813	SK2.5 repair kit	27
	566815	SK5 repair kit	27
	566816	SK10 repair kit	27
AFN	567574	Fish net	26
WF5	571010	Waterfall filter for ponds up to 5,000 gallons (F1000)	18, 22
WF10	571011	Waterfall filter for ponds up to 10,000 gallons (F5000)	18
WFF-20	599057	Black waterfall foam, 20 oz - case qty only	18, 22
RFSN-16	599211	Low water pump shut-off, 115/230 V, 15 amps	25
RFSN-20	599318	Low water pump shut-off, 230 V, 20 amps	25
	860-10	Filter pad for spillway, 10"	27
	860-18	Filter pad for spillway, 18"	27
	924006	LED EggLite wire connection O-ring	27
	924135	Light fixture O-ring for LVL and LED	27
	925023	3" Flexible pipe grommet	23
	925033	2" Flexible pipe grommet	23
	925034	4" Flexible pipe grommet	23
	925035	3/4" Flexible pipe grommet - fountain connector	23
	925054	1/2" Flexible pipe grommet - fountain connector	23
CV-SE1	940019	Check valve, 1-1/2" ips (1-1/2" solids)	23
CV-SE2	940022	Check valve, 2" ips (2" solids)	23
CV-SE3	940023	Check valve, 3" ips (3" solids)	23
	990108	PTFE	27
SK5	14940171	Skimmer for ponds up to 5,000 gallons (S1000)	18
SK10	14940172	Skimmer for ponds up to 10,000 gallons (S5000)	18, 22
	14940208	RTV silicone sealant	27
BFK-M	14940321	Manual backflush kit	19, 22
F-SBRK	14940343	Skimmer brush kit	27
	14940581	Skimmer lid plug	27





