



MULTI FITTINGS

LAYING LENGTH

ISSUE DATE: NOV 15/17
SUPERCEDES: MAY 10/05

TEE (HxHxH)

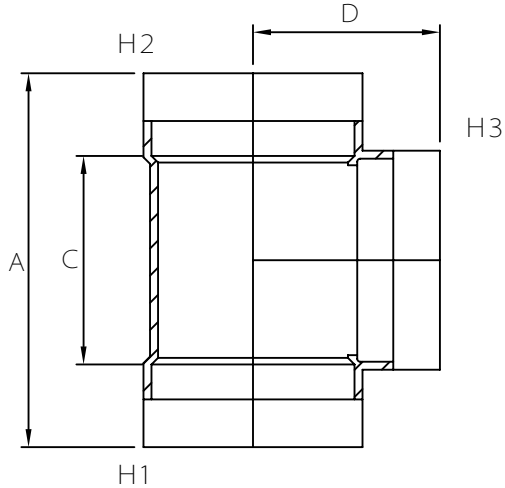

INJECTION MOLDED FITTING (M)

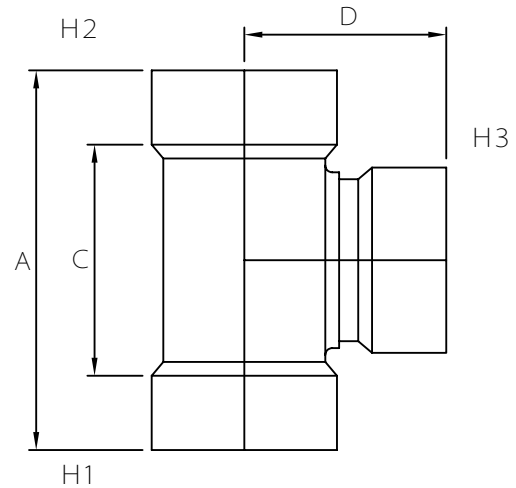

FABRICATED FITTING (F)

	SIZE H1xH2xH3	PART NUMBER	A REF	C REF	D REF
M	3x3x3	040102	5.250	3.750	2.625
M	4x4x3	040109	8.000	4.500	3.000
M	4x4x4	040104	7.875	4.375	4.000
M	6x6x4	040105	12.375	6.375	5.000
M	6x6x6	040106	12.375	6.375	6.250
M	8x8x4	040117	16.625	8.625	6.000
M	8x8x6	040118	16.625	8.625	7.375
M	8x8x8	040108	16.625	8.625	8.375
F	10x10x4	040119	-	-	-
F	10x10x6	040120	21.500	11.500	12.000
F	10x10x8	040121	-	-	-
F	10x10x10	040111	26.000	16.000	13.500
F	12x12x4	040122	-	-	-
F	12x12x6	040123	24.000	12.000	11.500
F	12x12x8	040124	28.000	16.000	11.500
F	12x12x10	040125	-	-	-
F	12x12x12	040112	30.000	18.000	16.000
F	15x15x6	040128	-	-	-
F	15x15x8	040126	-	-	-
F	15x15x10	040083	-	-	-
F	15x15x12	040127	34.000	19.000	17.000
F	15x15x15	040113	38.000	23.000	19.000
M	15x15x15	040185	31.250	16.250	15.625
F	18x18x6	040091	-	-	-
F	18x18x8	040092	-	-	-
P	18x18x15	040919	-	-	-
F	18x18x18	040115	46.000	28.000	23.000