



MULTI FITTINGS

LAYING LENGTH

ISSUE DATE: NOV 15/17
SUPERCEDES: MAY 10/05

45° WYE (HxHxH)

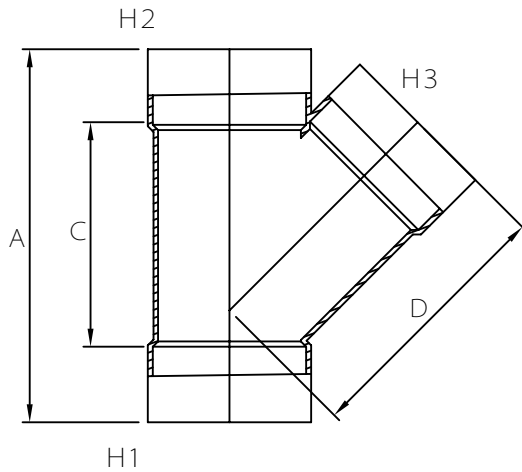

INJECTION MOLDED FITTING (M)

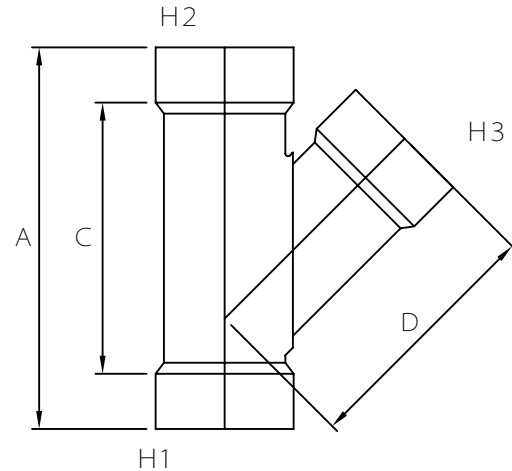

FABRICATED FITTING (F)

	SIZE H1xH2xH3	PART NUMBER	A REF	C REF	D REF
M	3x3x2	040303	7.875	4.875	4.125
M	3x3x3	040302	7.875	4.875	5.500
M	4x4x2	040308	9.750	6.250	4.875
M	4x4x3	040309	9.750	6.250	6.125
M	4x4x4	040304	9.625	6.125	7.000
M	6x6x4	040307	12.250	6.250	8.500
M	6x6x6	040306	15.000	9.125	10.875
M	8x8x4	040310	14.375	6.375	9.750
M	8x8x6	040312	17.375	9.375	12.125
M	8x8x8	040311	20.125	12.125	14.375
F	10x10x4	040315	-	-	-
F	10x10x6	040316	26.750	16.750	17.500
F	10x10x8	040317	29.750	19.750	20.500
F	10x10x10	040313	36.000	26.000	24.000
F	12x12x4	040305	-	-	-
F	12x12x6	040319	29.750	17.750	19.000
F	12x12x8	040320	31.000	19.000	21.000
F	12x12x10	040321	39.000	27.000	23.000
F	12x12x12	040314	41.000	29.000	27.000
F	15x15x4	040040	31.000	16.000	19.000
F	15x15x6	040323	-	-	-
F	15x15x8	040326	39.000	24.000	23.000
F	15x15x10	040327	-	-	-
F	15x15x12	040324	-	-	-
F	15x15x15	040325	-	-	-