

IN-WALL SHOWER DIVERTER  
SKU: 948905



FEATURES

- Shape: Square
- Handle Type: Lever
- Assembly Required: No
- Installation Type: Wall
- Metal Lever Handle
- Not Intended as a Shut Off Valve
- Six Total Settings Allow For Shared Water Flow Between Outlets, Giving You the Ability to Use Two Functions at Once
- Optional Rough-In Valve

SIGNATURE HARDWARE Lifetime Warranty

See website for detailed warranty information.

CONTENTS

DIVERTER	.....	PAGE 2
VALVE	.....	PAGE 3

## IN-WALL SHOWER DIVERTER

SKU: 948905

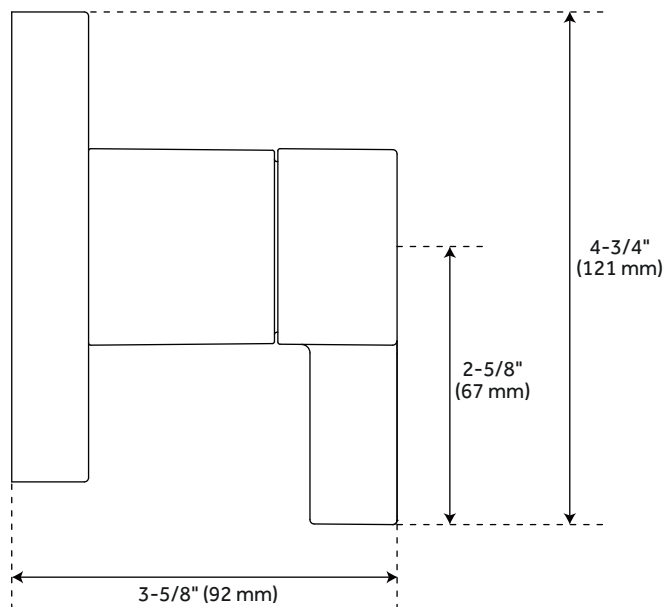

### FEATURES

Material: Brass  
 Width:  $4\frac{3}{8}$ "  
 Height:  $4\frac{3}{8}$ "  
 Depth:  $3\frac{5}{8}$ "  
 NPT Connection:  $\frac{3}{4}$ "  
 Wall Thickness Range: 1" -  $1\frac{3}{4}$ "

### CODES/STANDARDS

cUPC  
 ASME A112.18.1/CSA B125.1  
 ICC/ANSI A117.1 (when installed according to ADA standards)  
 Massachusetts Accepted

### SIGNATURE HARDWARE LIFETIME WARRANTY

See website for warranty information



All dimensions and specifications are nominal and may vary. Use actual products for accuracy in critical situations.

PAGE 2  
 Code: SHRI9005BN/SHRI9005CP

## OPTIONAL 3-WAY IN-WALL DIVERTER ROUGH-IN VALVE

SKU: 948905

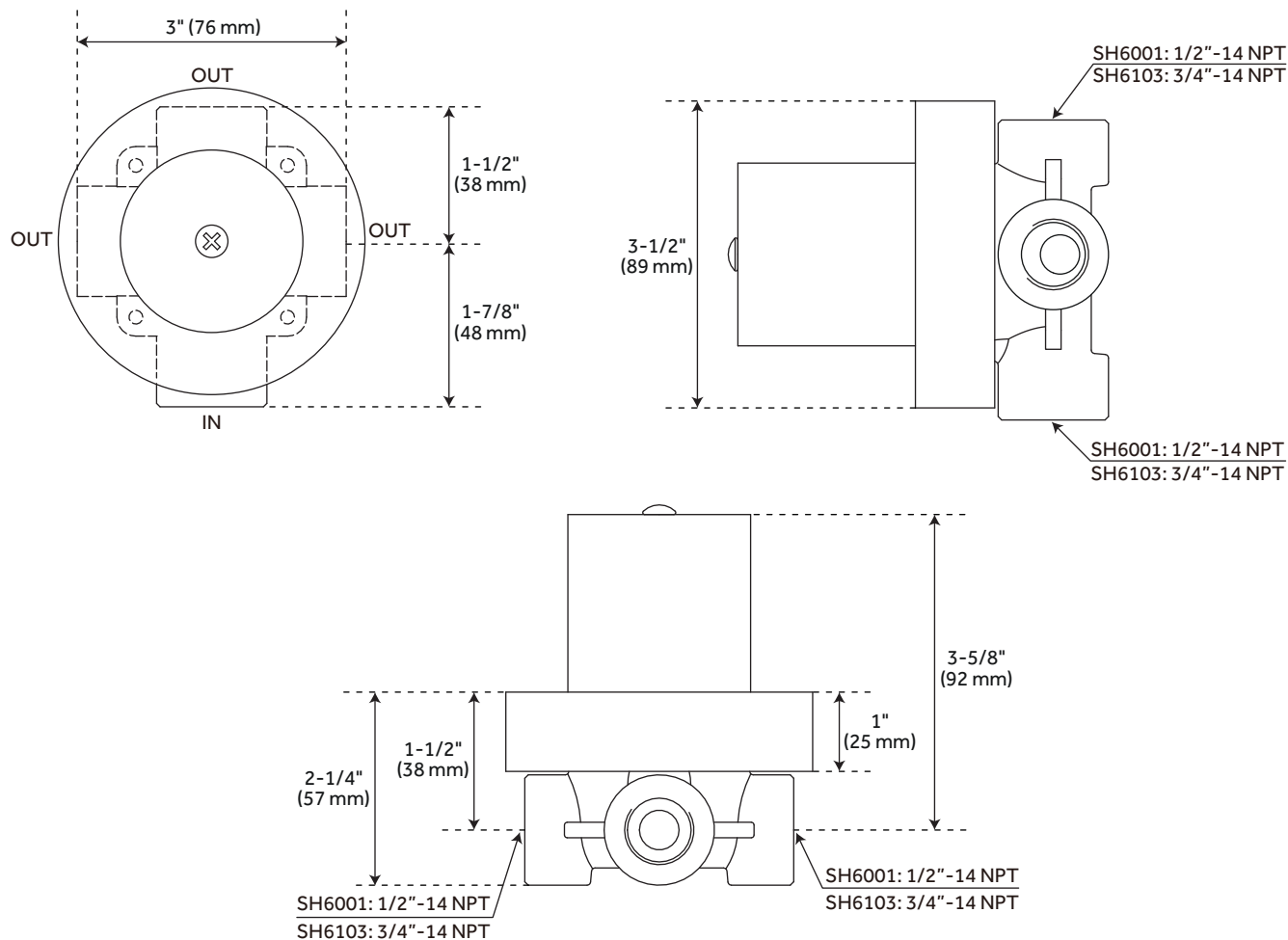

### FEATURES

- Material: Brass
- NPT Connection: 3/4"
- Available Single-Function Diverter Valve
- Cartridge Restricts Water Flow to One Outlet at a Time
- Ceramic Cartridge
- Must Be Installed in Accordance With Provided Installation Instructions

### CODES/STANDARDS

- cUPC
- ASME A112.18.1/CSA B125.1
- Massachusetts Accepted

### SIGNATURE HARDWARE LIFETIME WARRANTY

See website for warranty information



All dimensions and specifications are nominal and may vary. Use actual products for accuracy in critical situations.

PAGE 3  
Code: SH6103