

BA-350/350S

1/2"-3"

**BRONZE BALL VALVE
THREE-PIECE, FULL-PORT
600 WOG / 150 SWP (1)
SOLDERED ENDS
BLOW-OUT PROOF STEM**

FED. SPEC. WW-V-35C II, BZ, 1
MSS SP-110

MATERIALS LIST

ITEM	PART	MODEL	MATERIAL	ASTM SPEC.
1	Body	350&350S	Bronze	B584
2	End Cap	350&350S	Bronze	B584
3	Stem	350	Brass	B16
		350S	316 Stainless Steel	A276
4	Packing Nut	350&350S	Brass	B16
5	Packing	350&350S	PTFE	
6	Thrust Washer	350&350S	25% Glass RPTFE	
7	Ball	350	Chrome Plated Brass	B16
		350S	316 Stainless Steel	A276
8	Seat	350&350S	15% Glass RPTFE	
9	O-ring	350&350S	Viton	
10	Handle	350&350S	Zinc Plated Steel	
11	Handle Grip	350&350S	Vinyl	
12	Handle Nut	350&350S	Zinc Plated Steel	
13	Bolt	350&350S	Zinc Plated Steel	
14	Nut	350&350S	Zinc Plated Steel	

- (1) Milwaukee Valve Company recommends the use of Stainless Steel ball and stem for steam applications. Please consult factory for more information.
(2) Ball and stem are stainless for 350S

PRESSURE and TEMPERATURE CHART

VALVES RATED FOR VACUUM SERVICE TO 29 INCHES Hg.

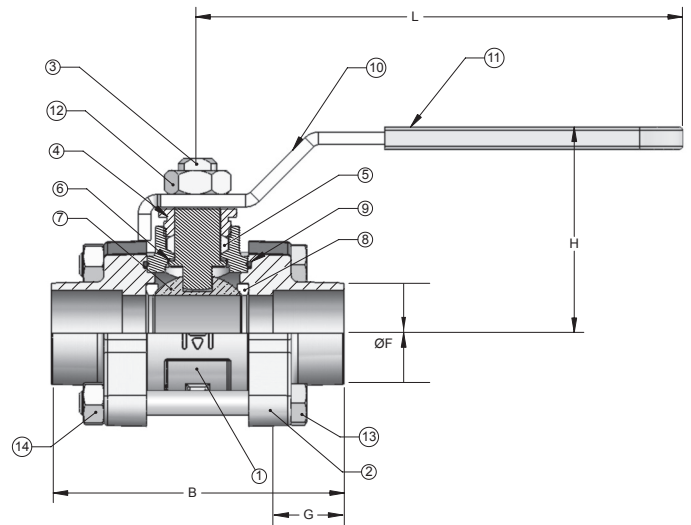
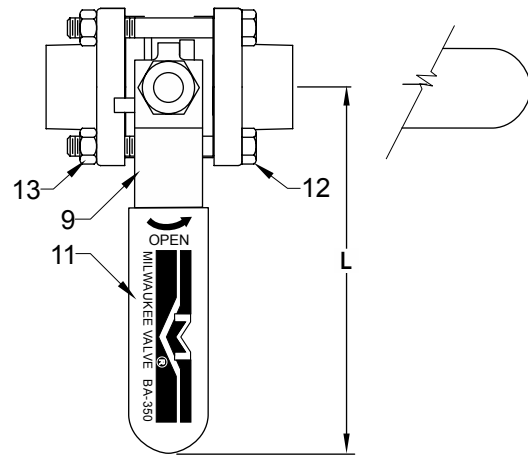
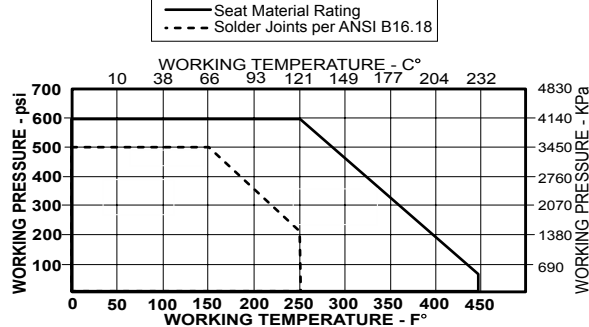

DIMENSIONS

	UNITS	1/2"	3/4"	1"	1 1/4"	1 1/2"	2"	2 1/2"	3" *
		DN15	DN20	DN25	DN32	DN40	DN50	DN65	DN80
A	INCHES	0.50	0.75	1	1.25	1.50	2	2.50	2.50
	mm	13	19	25	32	38	51	64	64
B	INCHES	2.80	3.44	3.87	4.75	5.25	6.10	6.94	6.94
	mm	72	88	94	121	134	153	176	176
H	INCHES	1.95	2.26	2.44	2.80	3.12	3.58	4.09	4.09
	mm	50	57	62	71	79	91	104	104
L	INCHES	3.88	4.75	4.75	6.50	7.38	7.38	8	8
	mm	99	121	121	165	187	187	203	203
W	INCHES	1.91	2.19	2.46	2.98	3.25	4	5	5
	mm	49	56	62	76	76	102	127	127
F	THREAD	1/2"	3/4"	1"	1 1/4"	1 1/2"	2"	2 1/2"	3"
	SIZE	NPT	NPT	NPT	NPT	NPT	NPT	NPT	NPT
Cv		17	31	60	110	185	360	390	390

* 3" is Standard Port

Rev. 8

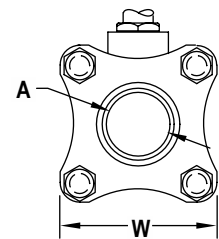

The information presented on this sheet is correct at the time of publication. Milwaukee Valve reserves the right to change design, and/or material specifications without notice. For the Installation, Operation and Maintenance Manual (IOM) see the engineering section on our website. For the most current information access www.milwaukeevalve.com

