



Freewill®
Barrier-free Shower Stall
K-12111-C



Codes/Standards

CSA B45.5/IAPMO Z124

ASTM E162

ASTM E662



Greenguard UL 2818 - Gold

See website for detailed warranty information.



Available Color/Finishes

Color tiles intended for reference only.

Color	Code	Description
-------	------	-------------

	0	White
	96	Biscuit
	47	Almond

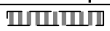
*Recess opening must be 52-1/4" (1327 mm) x 84-1/4" (2140 mm).

	Represents control area for faucets
	Represents 24" (610 mm) wall mount slide bar.

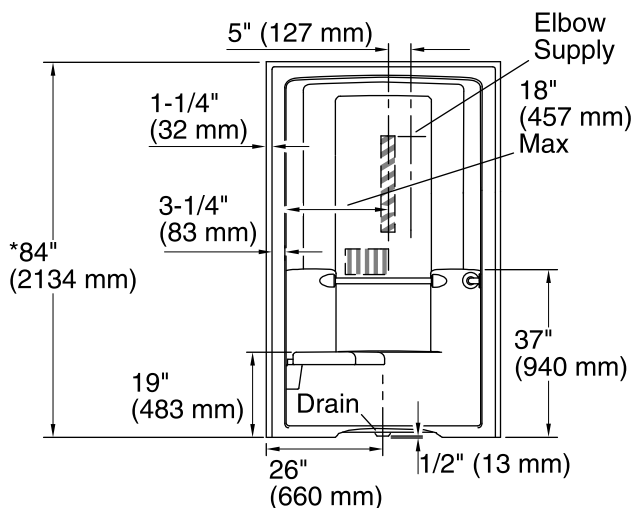
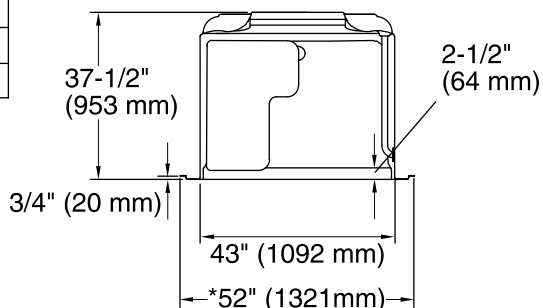
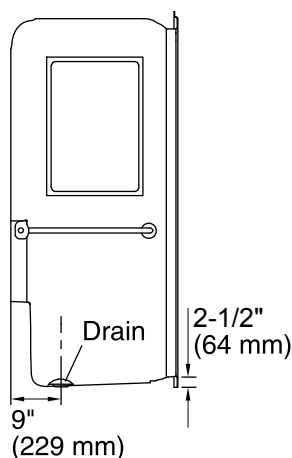

Technical Information

All product dimensions are nominal.

Drain location: Center rear

Drain hole diameter: 3-3/8" (86 mm)

Weight: 200 lbs (90.7 kg)

Notes

Measure your actual product for rough-in details.

Install this product according to the installation instructions.

Measure your actual product for roughing-in details.

Install this product according to the installation guide.

For increased accessibility, utilize "pit" installation as detailed in instructions.

For optimum accessibility, specify faucets and fittings to install and operate within the control area shown.

The fixture is not drilled for supply fittings.

Stud opening tolerance is + 1/4" (6 mm), - 0" (0 mm).

Shimming may be required to level the fixture.

Shimming between stud frame and fixture may be required.

When fire rated construction is specified, dimensions are to the inside of the fire-rated wall.