

Safety Precautions

Read all safety precautions and installation instructions carefully before installing or servicing this fixture. Failure to comply with these instructions could result in potentially fatal electric shock and/or property damage.

It is recommended that a qualified electrician perform all wiring. This fixture must be wired in accordance with all national and local electrical codes.

Do not handle any energized fixture or attempt to energize any fixture with wet hands or while standing on a wet or damp surface or in water.

This fixture is designed for use in a 120-277VAC, 60Hz fused circuit. Do not use on a dimming circuit.

To reduce the risk of electrical shock, and to assure proper operation, this fixture must be adequately grounded. To accomplish proper grounding, there must be a separate ground wire (green) contact between this fixture and the ground connection of your main power supply panel.

This fixture is intended to be used for general indoor lighting in dry or damp locations only.

Assembly Instructions

1. Preparing for installation

- Disconnect electrical power** at fuse or circuit breaker box before installing or servicing any part of this fixture.
- Carefully remove the fixture from the carton, and check that all parts are included, as shown in figure below. Be careful not to misplace any of the screws or parts which are needed for installing the fixture.
- If required, remove four decorative screws (8) from standoffs (5), and remove diffuser (7).

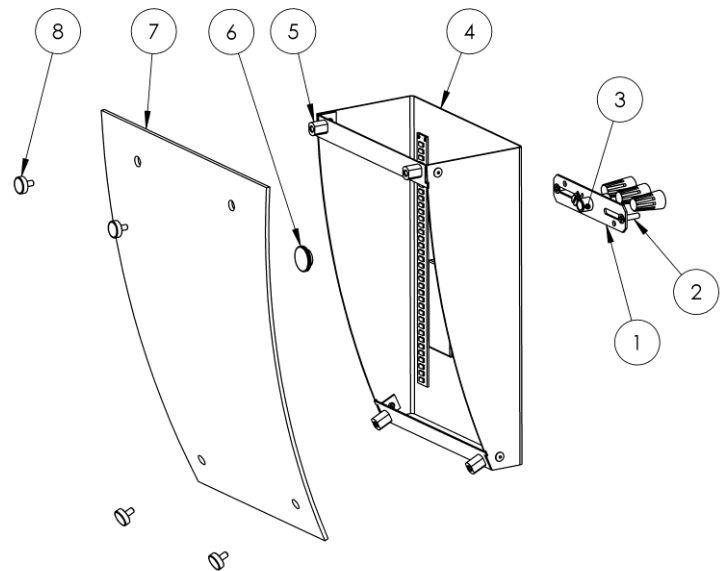

2. Wiring (all wiring must take place inside junction box)

Caution: Make sure power is off at fuse or circuit breaker box.

Check power wires for damage or scrapes. Use wire suitable for at least 90C (194F).

Note: Most dwellings built before 1985 have supply wire rated to 60C. Consult a qualified electrician before installing.

- This unit will not operate properly unless connected to a "grounded" electrical circuit. Electrical shock, over heating, low or no light output, and shortened LED life can result if proper grounding is not done. Securely attach green (or green and yellow) wire to back of fixture with provided hardware.
- Using wire nuts (provided), connect white (common) supply wire to white fixture lead. Connect black (hot) supply wire to black fixture lead. **Do not mix wires.** Pull on each wire lead to make sure connections are secure. Make certain no bare wires are exposed outside of wire connectors. **Note:** fixtures with universal voltage power supplies are pre-wired with a disconnect. Refer to the included guide for using the disconnect.

3. Mounting

- Thread two mounting screws (2) to the gem bar (1). Adjust the effective length of the fixture mounting nipple (3) as necessary.
- Secure gem bar (1) on the junction box (not supplied) with two screws (2) (supplied).
- Install back panel (4) over nipple (3) and secure it with the thumbnut (6).

4. Installing Shade

- Align diffuser (7) with the standoffs (5) and secure it with four screws (8).
- Restore power at fuse or circuit breaker box.

8060769 R2

Limited Factory Warranty

This product is manufactured by AFX Inc. This fixture is warranted to be free from defects in materials and workmanship when installed and used under normal operating conditions for a period of 5 years from date of purchase. This warranty covers all component parts and extends only to replacement of defective fixture or components; it does not cover failure due to improper installation, misuse, mishandling or damage incurred in transit.