

456 Malleable Split Ring Hanger for Copper Tube – 4560050CP

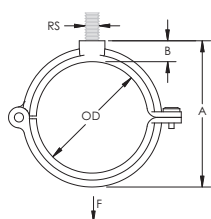

- Recommended for the suspension of stationary non-insulated copper tube lines
- Allows for piping runs close to ceiling or walls
- Conforms with Federal Specification WW-H-171 (Type 25), Manufacturers Standardization Society (MSS) SP-58 (Type 12)



Part Number	4560050CP
Material	Cast Iron
Finish	Copper Electroplated
Copper Tube Size	1/2"
Outer Diameter (OD)	5/8"
Rod Size (RS)	3/8"
A	1 1/8"
B	3/8"
Static Load (F)	180 lb
Standard Packaging Quantity	100 pc
UPC	78285636882

Bolt and rivet are carbon steel.

WARNING

nVent products shall be installed and used only as indicated in nVent's product instruction sheets and training materials. Instruction sheets are available at www.erico.com and from your nVent customer service representative. Improper installation, misuse, misapplication or other failure to completely follow nVent's instructions and warnings may cause product malfunction, property damage, serious bodily injury and death and/or void your warranty.

© 2019 nVent. All rights reserved.

nVent, nVent CADDY, nVent ERICO, nVent ERIFLEX and nVent LENTON are owned by nVent or its global affiliates.

All other trademarks are the property of their respective owners. nVent reserves the right to change specifications without prior notice.

