

SPECIFICATIONS

FIGURE 509A

Y-STRAINER



BRONZE 250 WOG Y-STRAINER

FEATURES

- 250 WOG
- 150 SWP
- Threaded NPT ends (3/8"–2")
- Cast bronze body
- 20 mesh stainless steel screen
- Blow-off plug included



PRODUCT SPECIFICATIONS

Standards

- NPT ends: ANSI/ASME B1.20.1
- Shell (hydro) test pressure: 375 PSI

FIGURE NUMBER MATRIX

FNW 509A	
SIZE (IN.)	
3/8 = C	1-1/4 = H
1/2 = D	1-1/2 = J
3/4 = F	2 = K
1 = G	

REPLACEMENT SCREENS

FNW 509A
FIGURE NUMBER
1/2 = FNWX509SCD
3/4 = FNWX509SF
1 = FNWX509SG
1-1/4 = FNWX509SH
1-1/2 = FNWX509SJ
2 = FNWX509SK

REPLACEMENT GASKETS

FNW 509A
FIGURE NUMBER
1/2 = FNWX509GD
3/4 = FNWX509GF
1 = FNWX509GG
1-1/4 = FNWX509GH
1-1/2 = FNWX509GJ
2 = FNWX509GK

CV & WEIGHT

Size (in.)	Cv	Wt (lbs)
3/8	4.90	0.801
1/2	5.16	0.728
3/4	9.79	1.163
1	16.77	1.823
1-1/4	27.78	2.690
1-1/2	38.58	3.379
2	45.11	5.713

FIGURE 509A

Y-STRAINER



BRONZE 250 WOG Y-STRAINER

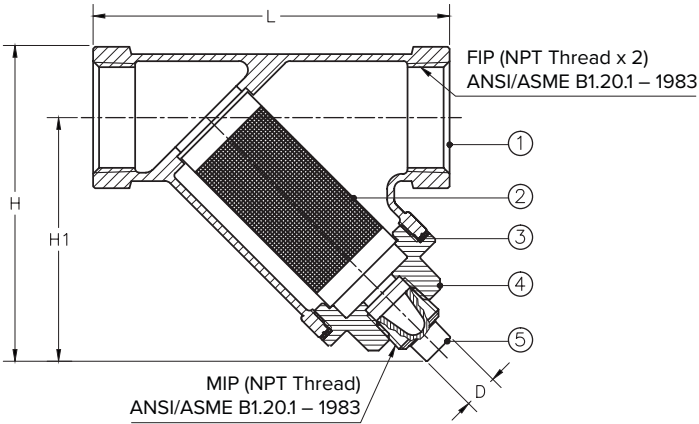

STANDARD MATERIALS

Ref #	Description	Material	Qty
1	Body	Cast Bronze C84400	1
2	Filter	Stainless Steel 304 - #20 Mesh	1
3	Packing	Non-Asbestos	1
4	Bonnet	Cast Bronze C84400	1
5	Plug	Cast Bronze C84400	1

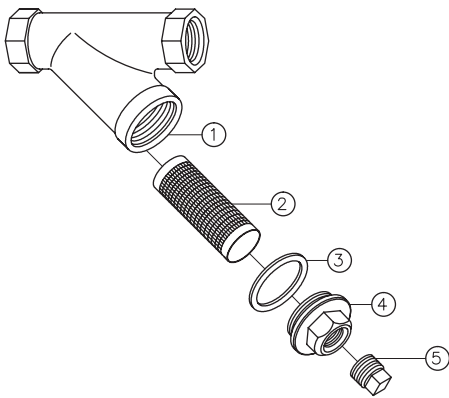

DIMENSIONS

Size (in.)	Dimensions (in.)					Flow Rate (GPM)	Pressure Test (PSI)	Pressure Drop (PSI)
	H	H1	L	L1	D			
3/8	3.03	2.44	3.21	1.56	0.45	12.95	25	10
1/2	3.01	2.44	3.23	1.56	0.45	16.32	25	10
3/4	3.49	2.78	3.94	2.19	0.45	30.97	25	10
1	4.04	3.19	4.53	2.62	0.52	53	25	10
1-1/4	4.70	3.66	5.33	3.07	0.52	87.9	25	10
1-1/2	5.02	3.82	6.20	3.46	0.52	122.09	25	10
2	6.14	6.65	7.44	4.65	0.52	143	25	10