

# FIGURE 509A Y-STRAINER



## BRONZE 250 WOG Y-STRAINER

### FEATURES

- 250 WOG
- 150 SWP
- Threaded NPT ends (3/8"-2")
- Cast bronze body
- 20 mesh stainless steel screen
- Blow-off plug included

### STANDARDS

- NPT Ends: ANSI/ASME B1.20.1
- Shell (Hydro) Text Pressure: 375 PSI



### FIGURE NUMBER MATRIX

FNW 509A		
<i>Replacement Screens</i>	<i>Replacement Gaskets</i>	<i>Size Code</i>
1/2 = FNWX509SCD	1/2 = FNWX509GD	3/8" = C    1-1/4" = H
3/4 = FNWX509SF	3/4 = FNWX509GF	1/2" = D    1-1/2" = J
1 = FNWX509SG	1 = FNWX509GG	3/4" = F    2" = K
1-1/4 = FNWX509SH	1-1/4 = FNWX509GH	1" = G
1-1/2 = FNWX509SJ	1-1/2 = FNWX509GJ	
2 = FNWX509SK	2 = FNWX509GK	

### CV & WEIGHT

Size	Cv	Wt (lbs)
3/8	4.90	0.801
1/2	5.16	0.728
3/4	9.79	1.163
1	16.77	1.823
1-1/4	27.78	2.690
1-1/2	38.58	3.379
2	45.11	5.713

# FIGURE 509A Y-STRAINER



## BRONZE 250 WOG Y-STRAINER

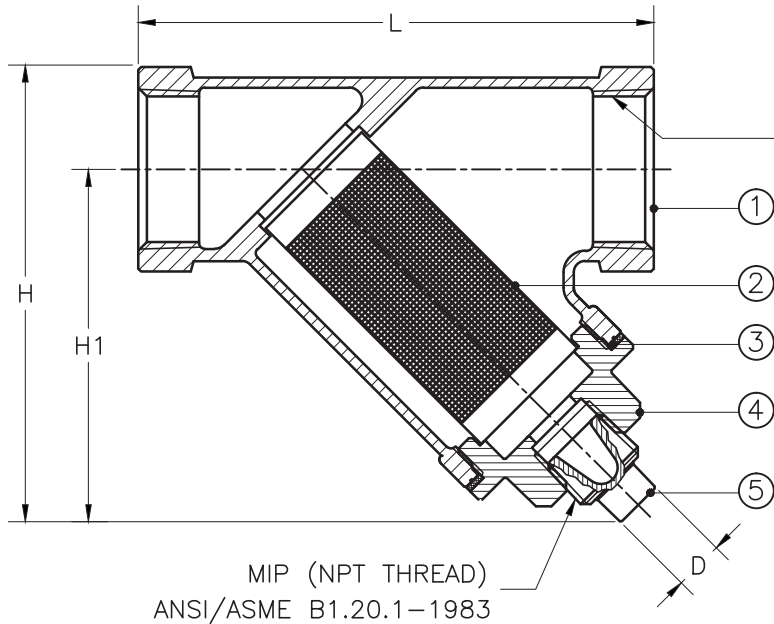

FIP (NPT THREAD X 2)  
ANSI/ASME B1.20.1-1983

MIP (NPT THREAD)  
ANSI/ASME B1.20.1-1983

### DIMENSIONS (INCHES)

Size	Dimensions					Flow Rate (GPM)	Pressure Test (PSI)	Pressure Drop (PSI)
	H	H1	L	L1	D			
3/8	3.03	2.44	3.21	1.56	0.45	12.95	25	10
1/2	3.01	2.44	3.23	1.56	0.45	16.32	25	10
3/4	3.49	2.78	3.94	2.19	0.45	30.97	25	10
1	4.04	3.19	4.53	2.62	0.52	53	25	10
1-1/4	4.70	3.66	5.33	3.07	0.52	87.9	25	10
1-1/2	5.02	3.82	6.20	3.46	0.52	122.09	25	10
2	6.14	6.65	7.44	4.65	0.52	143	25	10

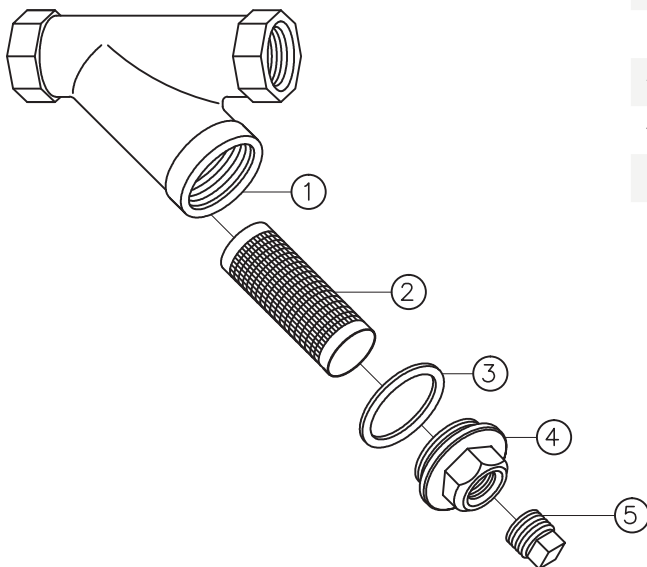

### STANDARD MATERIALS

Ref. No.	Description	Material	Qty
1	Body	Cast Bronze C84400	1
2	Filter	Stainless Steel 304 - #20 Mesh	1
3	Packing	Non-Asbestos	1
4	Bonnet	Cast Bronze C84400	1
5	Plug	Cast Bronze C84400	1