

Door Lock Installation

Step 1 Adjust Latch Backset

Adjust the Backset to match your door:

- A) To Adjust to 2-3/4" Backset pull square latch cam out.
- B) To Adjust to 2-3/8" Backset push square latch cam in

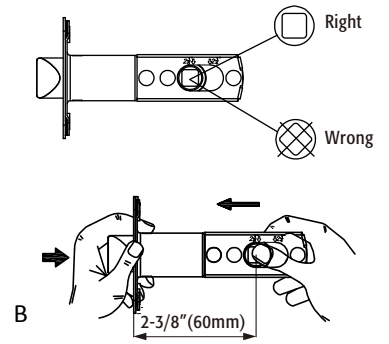
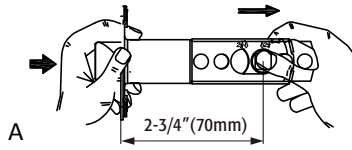

Step 2 Install Latch into the door

Install Latch into door positioned so that wedged shaped side of Bolt engages the strike first when closing the door

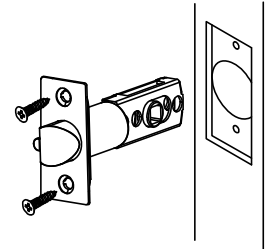

Step 3 Install Lock body

- A) Install exterior of lock by Inserting Lock Spindle Through Square Latch Cam and Studs through round holes until lock is Flush with the door.
- B) For Knobs with vertical key slots the knob should be installed with the Key Slot positioned so that the Key will be teeth up when used.
- C) Install the interior of the lock by inserting it over the spindle. Insert screws through holes and tighten down with a hand-held screwdriver.

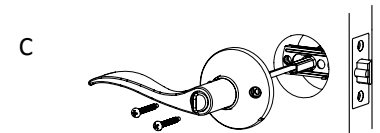
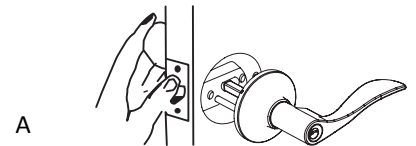

Note: Check alignment of the lock as you tighten the screws to keep lock centered over the bore Hole

Step 4 Wave Lever Only Left Handing Adjustment

Only Shaped Levers need to be adjusted for handing, straight Levers can be simply installed flipped to the proper handing.. Wave Levers are shipped Right-Handed.

- A) Handles are removed by rotating the lever 45 Degrees and pushing the release catch while pulling the lock off the spindle.
- B) Once both sides are off they can be swapped so that the handles point onto the door.
- C) Secure the levers by pushing until they snap into place. Test by pulling out on the lever

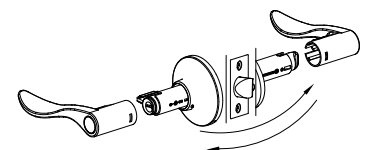
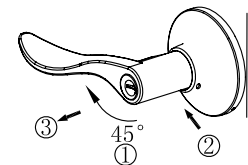
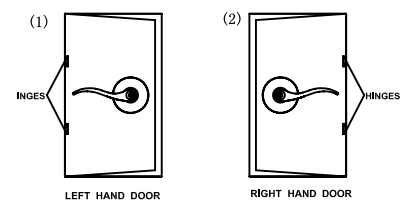

Note: Levers can only be removed when the lock is unlocked

Step 5 Install Strike

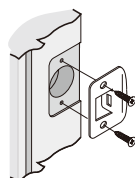

Entry Lock only –
Ensure Security Pin
Seats Properly

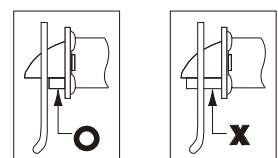

Door Lock Instructions New Door Preparation

Step 1 : Mark Door

A) Fold Template below on Fold Line and Mark Door for Lock Bore Hole at 2-3/4" or 2-3/8" Backset and lock Edge Hole Centered on the door edge.

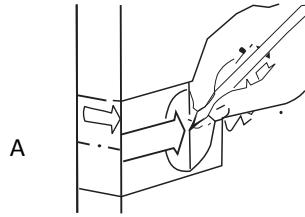

B) For set of 2 Locks, Deadbolt should be 5.5" above the entrance Knob or lever

Note: Most exterior doors 2-3/4" Backset is used

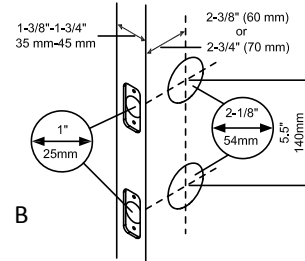

Common Standard for Lock Height off Floor is 36" to 39" above the floor.

Step 2 : Drill Holes

A) Drill through Door Face with 2-1/8" hole saw. Drill one side until Guide Bit punches through then Drill from through with the Hole saw from the other side to Complete the Lock Bore Hole

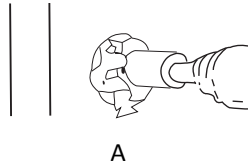

B) Drill the 1" Latch Hole from the door edge fully into the Lock Bore hole

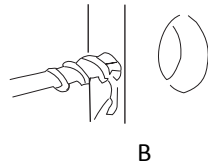

Step 3 : Mortise Door for Latch



A

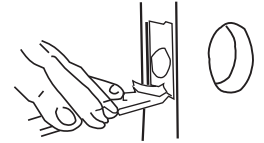

B

A) Insert Latch into Hole and keeping it parallel to the door Edge mark the Outline

B) Mortise the Door edge with a Chisel or Router 1/8" deep or until the latch Face plate is flush with the door when installed

Step 4 : Prepare Jamb for Strike

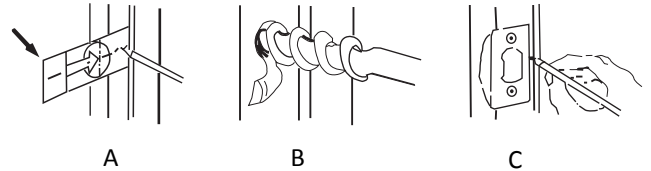

A

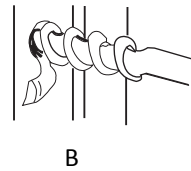

B

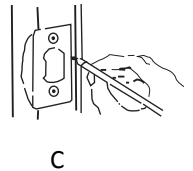

C

A) Insert Latch into hole in door and Mark where it will hit the door Jamb when properly closed.

B) Drill a 1" hole a Minimum of 1" deep into the door Jamb at the position Marked

C) If the Door is a tight fit to the Jamb you may need to mark the strike and mortise the Jamb so the strike sits flush to the door

