



# BATHROOM ACCESSORY

## BEFORE INSTALLING

Read entire Bathroom Accessory Installation Instructions. Observe all local building and safety codes.

## INSTRUCTIONS

Unpack and inspect the product for any shipping damages. If you find damages, do not install. Contact Customer Service at 1-866-855-2284. If you need assistance or have questions while installing your accessory, contact Customer Service.

We recommend anchoring any fixtures that will bear weight to wall studs or solid wood blocking. If the studs in your bathroom do not line up to the mounting location, wood blocking can be installed between the studs using standard 2 x 4's. If wood blocking needs to be installed behind the finished wall, we recommend consulting a professional if you are unfamiliar with this type of installation.

Because wall construction and materials vary from home to home, Signature Hardware does not provide mounting hardware for all of our bathroom accessories. The appropriate mounting hardware can be purchased from your local hardware store.

We recommend consulting a professional if you are unfamiliar with installing bathroom fixtures. Signature Hardware accepts no liability for any damage to the floor, walls or for personal injury during installation.

## TOOLS AND MATERIALS:

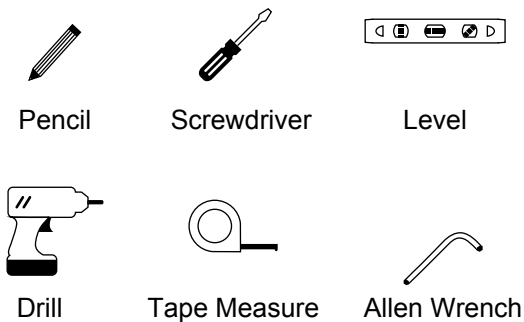

## INSTALLATION

- A. If the mounting bracket(s) and accessory arrive assembled, Disassemble by removing the set screws with an Allen wrench (provided) or screwdriver.
- B. Determine the installation location and mark the wall through each of the mounting holes in the mounting bracket(s).
- C. Drill the screw holes with the appropriate drill bit for the wall surface or material.
- D. Attach the mounting bracket(s) to the wall with the mounting hardware. Use your level and tape measure to ensure your bracket(s) are perfectly straight and in the proper position.
- E. Place your accessory on the mounting bracket(s). The set screws should be on the underside.
- F. Secure by tightening the set screws with your Allen wrench (provided) or screwdriver.

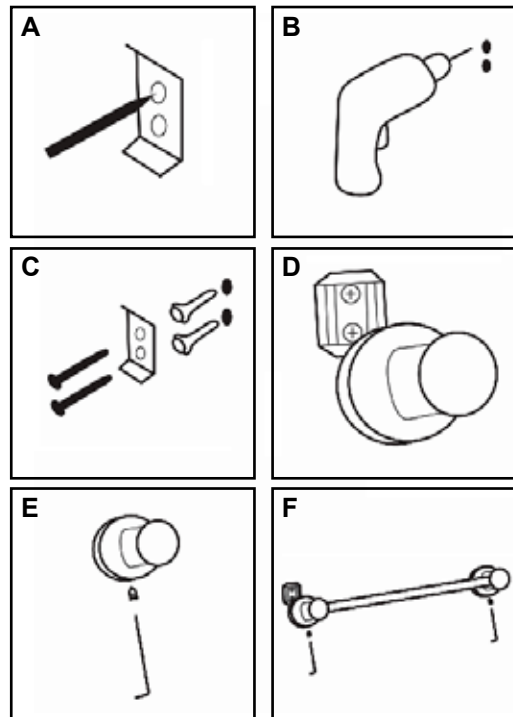

**Note: Mount directly to the wall if no mounting bracket is included.**