

Pipe Nipples

ASME B1.20.1

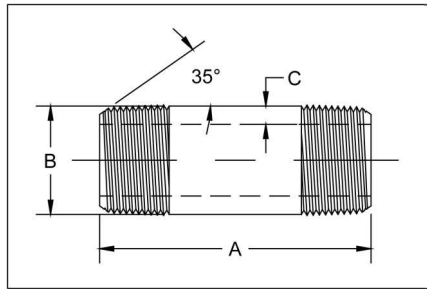

Pipe Nipples, Welded and Seamless, Carbon Steel and Stainless Steel

| PIPE SIZE | PIPE OD B | LENGTH A | | NOMINAL WALL C | | | |
|-----------|--------------|----------|------------|----------------|-------|-------|-------|
| | | CLOSE | SPACE | STD | XH | 160 | XXH |
| 1/8 | 0.405 | 3/4 | 1-1/2 - 24 | 0.068 | 0.095 | N/A | N/A |
| 1/4 | 0.540 | 7/8 | 1-1/2 - 24 | 0.088 | 0.119 | N/A | N/A |
| 3/8 | 0.675 | 1 | 1-1/2 - 24 | 0.091 | 0.126 | N/A | N/A |
| 1/2 | 0.840 | 1-1/8 | 1-1/2 - 24 | 0.109 | 0.147 | 0.188 | 0.294 |
| 3/4 | 1.050 | 1-3/8 | 1-1/2 - 24 | 0.113 | 0.154 | 0.219 | 0.308 |
| 1 | 1.315 | 1-1/2 | 2 - 24 | 0.133 | 0.179 | 0.250 | 0.358 |
| 1-1/4 | 1.660 | 1-5/8 | 2 - 24 | 0.140 | 0.191 | 0.250 | 0.382 |
| 1-1/2 | 1.900 | 1-3/4 | 2 - 24 | 0.145 | 0.200 | 0.281 | 0.400 |
| 2 | 2.375 | 2 | 2-1/2 - 24 | 0.154 | 0.218 | 0.344 | 0.436 |
| 2-1/2 | 2.875 | 2-1/2 | 3 - 24 | 0.203 | 0.276 | 0.375 | 0.552 |
| 3 | 3.500 | 2-5/8 | 3 - 24 | 0.216 | 0.300 | 0.438 | 0.600 |
| 3-1/2 | 4.000 | 2-3/4 | 4 - 24 | 0.226 | 0.318 | N/A | N/A |
| 4 | 4.500 | 2-7/8 | 4 - 24 | 0.237 | 0.337 | 0.531 | 0.674 |
| 5 | 5.563 | 3 | 4-1/2 - 24 | 0.258 | 0.375 | 0.625 | 0.750 |
| 6 | 6.625 | 3-1/8 | 4-1/2 - 24 | 0.280 | 0.432 | 0.719 | 0.864 |
| 8 | 8.625 | 3-1/2 | 5 - 24 | 0.322 | 0.500 | 0.906 | 0.875 |

Continuous Welded - ASTM A53 Type F

Electric Resistance Welded - ASTM A53 Type E, Grade B

Seamless, High Temperature - ASTM A106 Grade B, ASTM A53 Type S, Grade B, API 5L, Grade B

Seamless, Low Temperature - ASTM A333 Grade 6

Electric Resistance Welded - ASTM A312, Type 304/304L or 316/316L

Seamless, ASTM A312 Type 304/304L or 316/316L

Threads conform to ASME B.1.20.1

Pipe Nipples

ASME B1.20.1

Pipe Nipple End Finishes

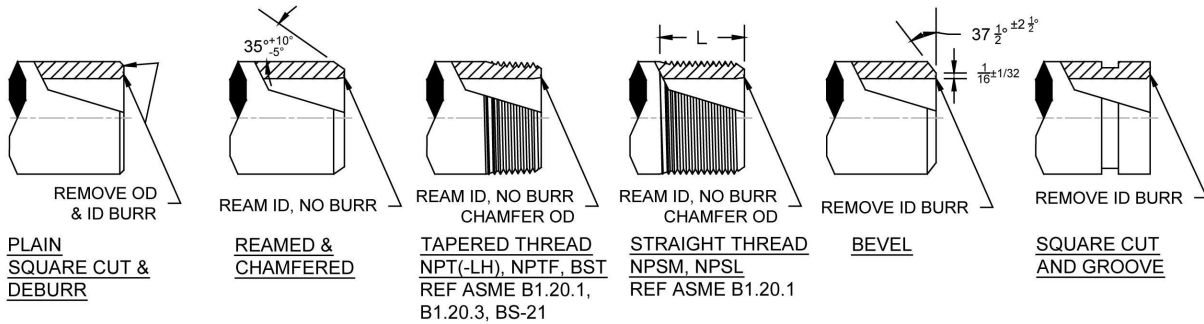

PIPE NIPPLE DESCRIPTION AND TERMINOLOGY

EXAMPLE: $\frac{3}{4}$ x 12 SCH40 SMLS 304 NIPPLE T X B NPSM x 2"

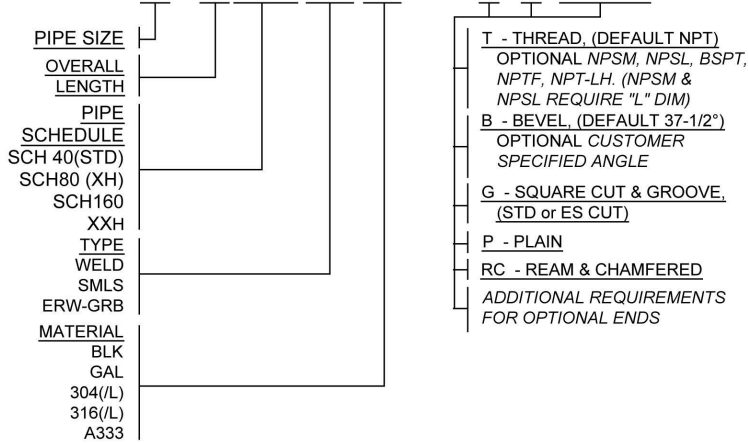

- NOTES: 1) END FINISH ABBREVIATION ORDER; T, B, G, P, RC.
 2) TBE, BBE, GBE, AND PBE MAY BE SUBSTITUTED FOR NIPPLES WITH SAME END FINISHES ON BOTH ENDS.
 3) DEFAULT END FINISHES LISTED FOR THREAD, BEVEL, AND PLAIN. OPTIONAL VARIATIONS TO BE CALLED OUT IN TEXT INCLUDING ADDITIONAL REQUIREMENTS.
 4) STD CUT GROOVE IS STANDARD. ES CUT GROOVE END FINISH AVAILABLE UPON REQUEST
 5) NIPPLES CLOSE TOUGH 12" LONG SHALL HAVE A LENGTH TOLERANCE OF $\pm \frac{1}{16}$ ". NIPPLES OVER 12" LONG SHALL HAVE A TOLERANCE OF $\pm \frac{1}{8}$ ".

TBE - "THREAD BOTH ENDS" (BOTH ENDS THREADED WITH STANDARD NPT THREADS)

TOE - "THREAD ONE END" (ONE END THREADED WITH STANDARD NPT THREAD. CUSTOMER MUST SPECIFY OTHER END, OTHERWISE SQUARE CUT & DEBURR WILL BE SHIPPED)

NPTF - "DRYSEAL" (STANDARD TAPER DRYSEAL PIPE THREADS)

NPSL - "STRAIGHT LOCKNUT" (STANDARD STRAIGHT PIPE THREADS FOR LOOSE-FITTING MECHANICAL WITH LOCKNUTS)

NPSM - "STRAIGHT MECHANICAL" (STANDARD STRAIGHT PIPE THREADS FOR FREE-FITTING MECHANICAL JOINTS FOR FIXTURES)

BST (BS21, ISO 7/1) - BRITISH STANDARD TAPER PIPE THREADS