

Install a Nest thermostat trim plate

You can install your Nest thermostat with a trim plate if your old thermostat left a large hole or unpainted part of the wall. The trim plate is optional. To install a Nest thermostat on an electrical junction box, use a metal plate and trim plate.

Important things to know

- **Turn off power** to your system before exposing wires. This helps protect you and your system from damage.
- **Nest screws are self-tapping**, so there's no need to drill into soft materials like drywall or plaster. If you need to drill into harder materials like wood, use a 3/32 or 2.5 mm drill bit.
- **Use a screwdriver** to connect the thermostat base to the trim plate. High torque power drills can over-tighten the screws and damage the thermostat base. If you need to use a drill, use a low torque setting at slow speed.

Specific instructions depend on which thermostat you have.

Select the thermostat you have:

[Nest Thermostat](#) [Nest Thermostat E](#) [Nest Learning Thermostat](#)



[How to tell which thermostat you have](#)

Nest Thermostat

If you don't want to paint over holes or marks left by your old thermostat, you can purchase the optional trim kit in different colors to match your thermostat and decor. The kit includes a trim plate and a steel plate if you are mounting to an electrical box.

On the wall

1. Snap the thermostat base and trim plate together, pull the wires through the hole.
2. Hold the trim plate against the wall and use the bubble level in the thermostat base to make sure everything is level.
3. Mount the plate on the wall with the screws included with your thermostat.

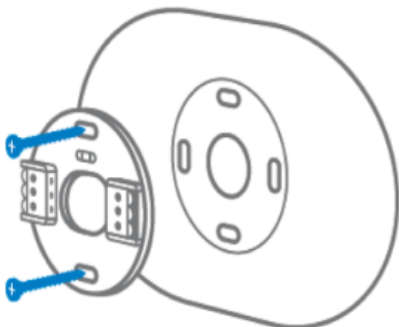

On an electrical box

1. Pull the thermostat wires through the hole in the steel plate. Then secure the plate to the electrical box with two of the included long screws.
2. Snap the thermostat base and trim plate together. Then screw them onto the steel plate.
3. Check the bubble level in the thermostat base to make sure it's level. Loosen the screws and turn the thermostat base if needed. Then re-tighten the screws.

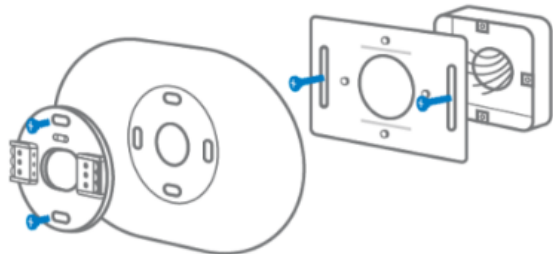

[Nest Thermostat E](#)

[Nest Learning Thermostat](#)

Need more help?

Try these next steps:

Ask the Help Community

Get answers from community experts

Contact us

Tell us more and we'll help you get there